



**PENGUMUMAN TRAFIK: PROJEK PENANG LRT – LALUAN MUTIARA (PML)  
12/02/2026**

**PENUTUPAN LORONG SECARA BERKALA JANGKA PENDEK DI JALAN TUN DR. AWANG  
(HUNZA PROPERTIES BERHAD - HUNZA MUSE PICC)**

<b>Tarikh</b>	16 Februari 2026 - 11 Mac 2026
<b>Masa</b>	10.00 pm – 5.00 am
<b>Tempoh</b>	24 hari
<b>Tujuan</b>	Mengenal Pasti Dan Pengalihan Utiliti

Dimaklumkan bahawa penutupan lorong secara berkala jangka pendek di Jalan Tun Dr Awang (menghala ke Bayan Lepas) akan dilaksanakan dari 16 Februari 2026 sehingga 11 Mac 2026. Penutupan ini akan dijalankan di antara jam 10.00 malam dan 5.00 pagi, selama 24 hari.

Pelan pengurusan trafik adalah seperti berikut:

Penutupan ini akan melibatkan lorong tengah di antara bangunan Hunza Properties Berhad dan bangunan Hunza Muse PICC, lorong kanan dari persimpangan lampu isyarat Jalan Bukit Gambir ke Jalan Tun Dr Awang dan lorong kiri ke persimpangan lampu isyarat Jalan Bukit Gambir. Walau bagaimanapun, lorong lain akan kekal dibuka untuk laluan trafik (seperti yang ditunjukkan di dalam peta yang dilampirkan).

Penutupan ini diperlukan bagi memberi laluan kepada kerja-kerja awalan bagi Projek Rapid Transit Aliran Ringan (LRT) Pulau Pinang: Laluan Mutiara - Pakej CMC1 yang melibatkan kerja mengenal pasti dan pengalihan utiliti.

Pengguna jalan raya dinasihatkan untuk berhati-hati ketika melalui kawasan ini. Papan tanda, kon-kon trafik dan pengawal bendera akan ditempatkan di lokasi berkenaan untuk membantu melancarkan kawalan trafik dan keselamatan pengguna kenderaan di laluan tersebut.

Kami memohon maaf di atas sebarang kesulitan. Untuk sebarang pertanyaan sila hubungi MRT Careline 1-800-88-6782 atau emel kepada [feedback\\_pml@mymrt.com.my](mailto:feedback_pml@mymrt.com.my)

**PETA: PENUTUPAN LORONG SECARA BERKALA JANGKA PENDEK DI JALAN TUN DR. AWANG (HUNZA PROPERTIES BERHAD - HUNZA MUSE PICC)**

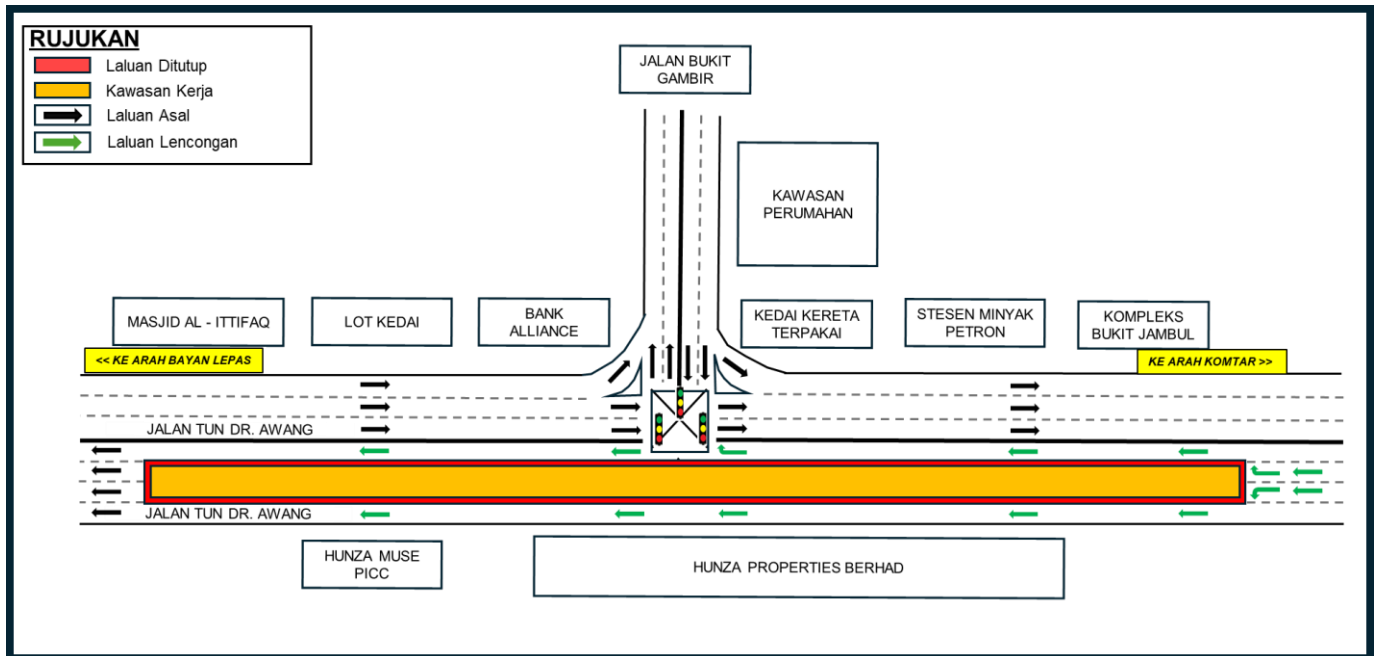

**SHORT-TERM INTERMITTENT CLOSURES ON JALAN TUN DR. AWANG  
(HUNZA PROPERTIES BERHAD - HUNZA MUSE PICC)**

<b>Date</b>	16 February 2026 - 11 March 2026
<b>Time</b>	10.00 pm – 5.00 am
<b>Duration</b>	24 days
<b>Reason</b>	Identify And Relocation Utilities

Please be informed that short-term intermittent partial lane closures on the Jalan Tun Dr Awang (towards Bayan Lepas) will be implemented from 16 February 2026 to 11 March 2026. The closures will take place between 10:00 pm and 5:00 am, over a period of 24 days.

The traffic management plan is as follows:

This closure will involve the middle lane between the Hunza Properties Berhad building and the Hunza Muse PICC building, the right lane after the traffic light intersection of Jalan Bukit Gambir to Jalan Tun Dr Awang, and the left lane towards the traffic light intersection of Jalan Bukit Gambir. However, the other lanes will remain open for traffic flow (as shown on the attached map).

The closure is necessary to facilitate preliminary works for the Penang Light Rail Transit (LRT) Project: Mutiara Line – Package CMC1, which include utility identification and relocation works.

Motorists are advised to follow directional signage. During the closure period, the PML Project Emergency Response Team will be onsite to assist with traffic management. Safety barriers, traffic cones and flagmen will also be deployed to ensure the safety of all road users. For further information, please refer to the map below.

We apologise for any inconvenience caused and thank you for your cooperation.

For enquiries, please contact MRT Careline at 1-800-88-6782 or email [feedback\\_pml@mymrt.com.my](mailto:feedback_pml@mymrt.com.my)

**MAP: SHORT-TERM INTERMITTENT CLOSURES ON JALAN TUN DR. AWANG  
(HUNZA PROPERTIES BERHAD - HUNZA MUSE PICC)**

