



**PENGUMUMAN TRAFIK: PROJEK PENANG LRT – LALUAN MUTIARA (PML)
19/01/2026**

**PENUTUPAN SEPARA LALUAN JANGKA PANJANG KEDUA-DUA HALA
DI JALAN SULTAN AZLAN SHAH (SUNGAI TIRAM)**

Tarikh	30 Disember 2025 - 31 Disember 2027
Masa	24 Jam
Tempoh	732 hari
Tujuan	Kerja-Kerja Awalan Termasuk Penebangan Pokok, Siasatan Tapak, Pemindahan Utiliti dan Kerja Cerucuk

Untuk makluman, penutupan separa lorong jangka panjang akan dilaksanakan di Jalan Sultan Azlan Shah, berhampiran kawasan Sungai Tiram, dari 30 Disember 2025 hingga 31 Disember 2027. Pelan pengurusan trafik adalah seperti berikut:

Penutupan ini akan melibatkan laluan laju di kedua-dua arah di antara Lapangan Terbang Antarabangsa Pulau Pinang dan persimpangan lampu isyarat Jalan Mayang Pasir. Dua lorong di kedua-dua arah akan sentiasa dibuka sepanjang tempoh penutupan ini.

Penutupan ini diperlukan bagi memberi laluan kepada kerja-kerja awalan bagi Projek Rapid Transit Aliran Ringan (LRT) Pulau Pinang: Laluan Mutiara - Pakej CMC1 termasuk kerja-kerja penebangan pokok, siasatan tapak, pemindahan utiliti dan kerja cerucuk.

Pengguna jalan raya dinasihatkan untuk berhati-hati ketika melalui kawasan ini. Papan tanda, kon-kon trafik dan pengawal bendera akan ditempatkan di lokasi berkenaan untuk membantu melancarkan kawalan trafik dan keselamatan pengguna kenderaan di laluan tersebut.

Kami memohon maaf di atas sebarang kesulitan. Untuk sebarang pertanyaan sila hubungi MRT Careline 1-800-88-6782 atau emel kepada feedback_pml@mymrt.com.my

**PETA: PENUTUPAN SEPARA LALUAN JANGKA PANJANG KEDUA-DUA HALA
DI JALAN SULTAN AZLAN SHAH (SUNGAI TIRAM)**

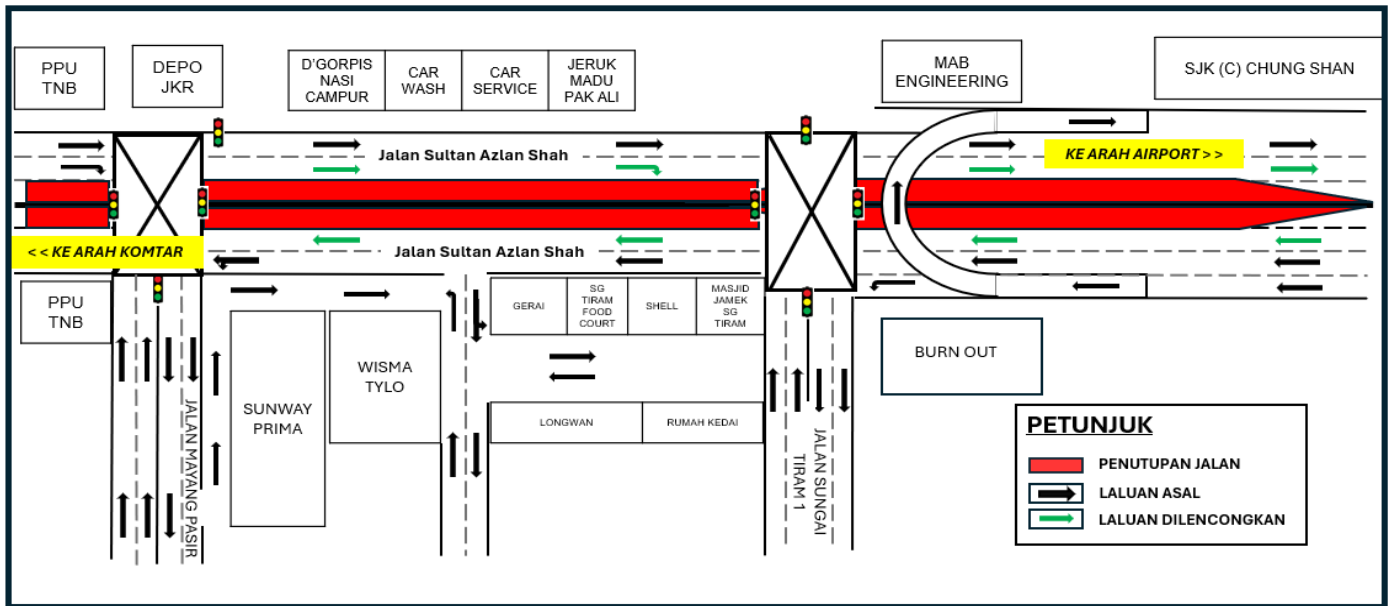

**LONG-TERM PARTIAL LANE CLOSURES ON BOTH DIRECTIONS ALONG JALAN SULTAN AZLAN SHAH
(SUNGAI TIRAM)**

Date	30 December 2025 - 31 December 2027
Time	24 Hours
Duration	732 days
Reason	Preliminary Works Including Tree Cutting, Soil Investigation, Utility Relocation And Bore Piling

Please be informed that the long-term partial lane closures on both directions along Jalan Sultan Azlan Shah, near the Sungai Tiram area, will be implemented from 30 December 2025 to 31 December 2027. The traffic management plan is as follow:

During the implementation of the lane closures, the fast lanes in both directions, along the stretch between Penang International Airport and the Jalan Mayang Pasir traffic light junction will be affected. Two lanes at both directions will remain open during this period.

The closure is necessary to facilitate preliminary works for the Penang Light Rail Transit (LRT) Project: Mutiara Line – Package CMC1, including tree felling, site investigation, utility relocation dan bore piling works.

Motorists are advised to follow directional signage. During the closure period, the PML Project Emergency Response Team will be onsite to assist with traffic management. Safety barriers, traffic cones and flagmen will also be deployed to ensure the safety of all road users. For further information, please refer to the map below.

We apologise for any inconvenience caused and thank you for your cooperation.

For enquiries, please contact MRT Careline at 1-800-88-6782 or email feedback_pml@mymrt.com.my

**MAP: LONG-TERM PARTIAL LANE CLOSURES ON BOTH DIRECTIONS
ALONG JALAN SULTAN AZLAN SHAH (SUNGAI TIRAM)**

