

**PENGUMUMAN TRAFIK: PROJEK RAPID TRANSIT SYSTEM (RTS LINK)
13 NOVEMBER 2025**

PENUTUPAN PENUH SECARA BERKALA DI JALAN TEBRAU DAN JALAN WONG AH FOOK, JOHOR BAHRU

Tarikh	17 November 2025 – 12 December 2025
Masa	10.00 malam - 5.30 pagi
Jangka masa	Tiga (3) minggu dan Empat (4) hari
Tujuan	Bagi memudahkan kerja-kerja mobilisasi jentera pembinaan, kerja-kerja pelancaran dan kerja-kerja berkaitan projek RTS Link.

Untuk makluman, **penutupan penuh secara berkala** di Jalan Tebrau dan Jalan Wong Ah Fook akan dilaksanakan dari **17 November 2025 hingga 12 Disember 2025**. Tempoh masa kerja-kerja adalah dari **10.00 malam hingga 5.30 pagi**, selama **tiga (3) minggu dan empat (4) hari**. Pelan pengurusan trafik adalah seperti berikut:

Lencongan 1:

Semasa penutupan penuh secara berkala sepanjang 500 meter di Jalan Tebrau (arah Kota Tinggi) dilaksanakan, pengguna jalan raya akan membuat pusingan “U” ke Jalan Lingkaran Dalam dan dilencongkan ke Jalan Tun Abdul Razak untuk meneruskan perjalanan ke arah Pusat Bandar (seperti yang ditunjukkan oleh anak panah **HIJAU** di dalam peta).

Lencongan 2:

Semasa penutupan penuh secara berkala sepanjang 600 meter di Jalan Wong Ah Fook dilaksanakan, pengguna jalan raya akan dilencongkan ke Jalan Sulaiman, Jalan Trus, dan Jalan Ngee Heng untuk meneruskan perjalanan ke Jalan Tun Abdul Razak (arah Skudai/Senai) (seperti yang ditunjukkan oleh anak panah **BIRU** di dalam peta).

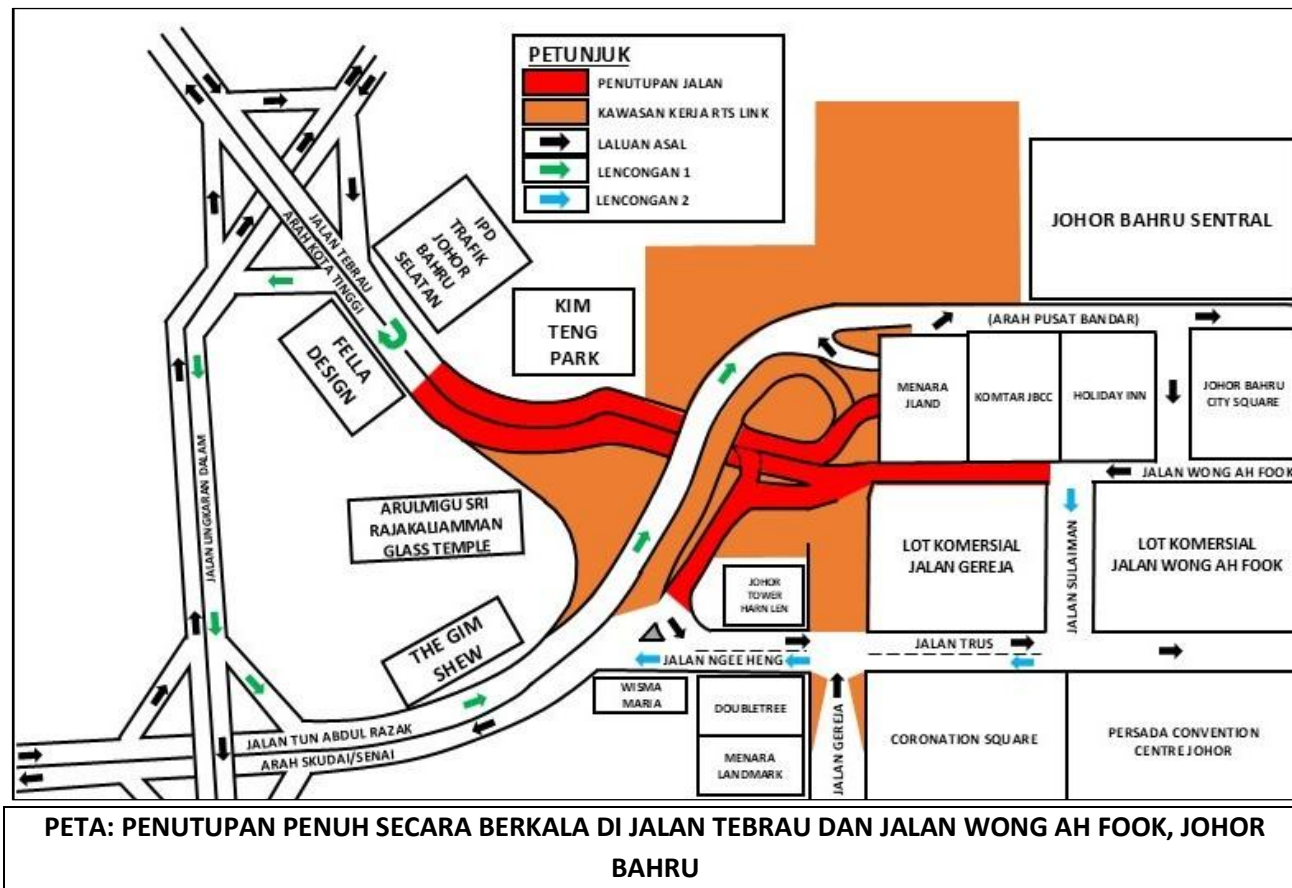

Pengguna jalan raya dinasihatkan untuk mematuhi arahan papan tanda trafik dan pengawal trafik yang bertugas.

Untuk maklumat lanjut, sila hubungi:

IJM Construction Sdn. Bhd.

Shera Choo Yen Qi

Perhubungan Awam & Pengurusan Pihak Berkepentingan

Tel: +6012-2901992 Emel: sherachoo@ijm.com

Malaysia Rapid Transit System Sdn. Bhd.

Zamri Zakariah

Pengurusan Awam & Pihak Berkepentingan

Tel: +607-2972000 Emel: zamri.zakariah@mymrt.com.my

Malaysia Rapid Transit System Sdn. Bhd.

Level 29, Menara Jland,

Jalan Wong Ah Fook,

80888 Ibrahim International Business District,

Johor Darul Ta'zim

MRTCareline: 1800-88-6782

Emel: rts-feedback@mymrt.com.my

INTERMITTENT FULL ROAD CLOSURE AT JALAN TEBRAU AND JALAN WONG AH FOOK, JOHOR BAHRU

Date	17 November 2025 - 12 December 2025
Time	10.00 PM - 5.30 AM
Duration	Three (3) weeks and Four (4) days
Reason	To facilitate machine mobilization, launching works and other RTS Link project-related works.

Please be informed that an **intermittent full road closure** on Jalan Tebrau and Jalan Tun Abdul Razak will be implemented from **17 November 2025 until 12 December 2025**. The construction works will be carried out from **10.00 PM to 5.30 AM**, for a duration of **three (3) weeks and four (4) days**. The traffic management plan is as follows:

Diversion 1:

During the intermittent full road closure for an approximate distance of 500-metre stretch at Jalan Tebrau (Kota Tinggi-bound), motorists will make a U-turn to Jalan Lingkaran Dalam, and will be diverted to Jalan Tun Abdul Razak to continue their journey towards the City Centre (as indicated by the **GREEN** arrows in the map).

Diversion 2:

During the intermittent full road closure for an approximate distance of 600-metre stretch at Jalan Wong Ah Fook, motorists will be diverted to Jalan Sulaiman, Jalan Trus, and Jalan Ngee Heng to continue their journey towards Jalan Tun Abdul Razak (Skudai/Senai-bound) (as indicated by the **BLUE** arrows in the map).

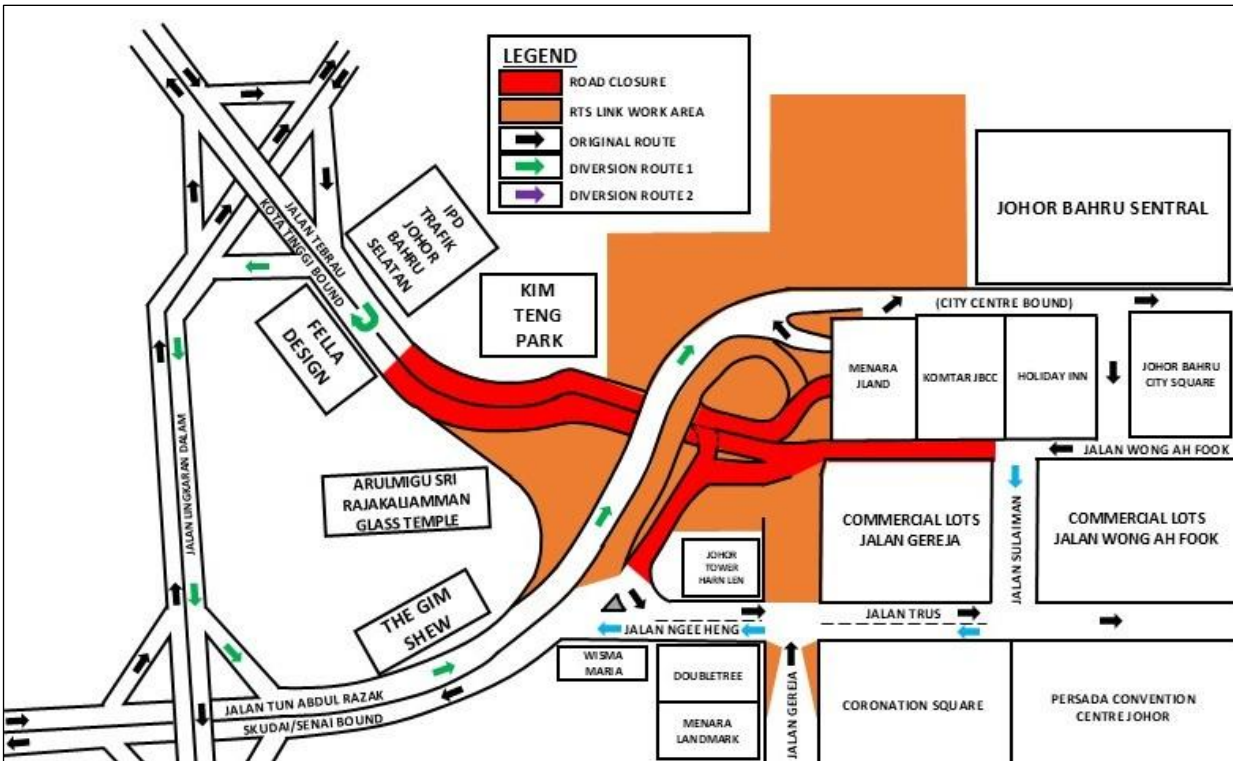

MAP: INTERMITTENT FULL ROAD CLOSURE AT JALAN TEBRAU AND JALAN WONG AH FOOK, JOHOR BAHRU

Road users are advised to follow the traffic signages and the directions of the traffic controller during the activation of the lane closure.

For further information, please contact:

IJM Construction Sdn. Bhd.

Shera Choo Yen Qi

PR & Stakeholder Management

Tel: +6012-2901992 Email: sherachoo@ijm.com

Malaysia Rapid Transit System Sdn. Bhd.

Zamri Zakariah

Public Affairs & Stakeholder Management

Tel: +607-2972000 Email: zamri.zakariah@mymrt.com.my

Malaysia Rapid Transit System Sdn. Bhd.

Level 29, Menara JLand,

Jalan Wong Ah Fook,

80888 Ibrahim International Business District,

Johor Darul Ta'zim

MRTCareline: 1800-88-6782

Emel: rts-feedback@mymrt.com.my

- The rest of this page has been intentionally left blank -