

**PENGUMUMAN TRAFIK: PROJEK RAPID TRANSIT SYSTEM LINK (RTS LINK)**

**8 JUN 2024**

**PENUTUPAN LORONG SECARA BERKALA DAN BERPERINGKAT DI KM1.0 – KM0.8  
TAMBAK JOHOR (ARAH WOODLANDS, SINGAPURA)**

<b>Tarikh</b>	10 Jun 2024 – 22 Jun 2024 (termasuk Sabtu dan Ahad) 25 Jun 2024 – 26 Jun 2024 2 Julai 2024 – 3 Julai 2024 9 Julai 2024 – 10 Julai 2024
<b>Masa</b>	8:00 malam – 3:00 pagi
<b>Tempoh</b>	31 hari
<b>Tujuan</b>	Bagi memudahkan kerja-kerja pelancaran segmen kekotak dan kerja-kerja berkaitan projek RTS Link

Untuk makluman, **penutupan lorong secara berkala dan berperingkat** di Tambak Johor (arah Woodlands, Singapura) akan dilaksanakan dari **10 Jun 2024 hingga 10 Julai 2024**. Tempoh masa kerja adalah dari **8:00 malam hingga 3:00 pagi** selama **31 hari**. Pelan pengurusan trafik adalah seperti berikut:

**Peringkat 1 (10 Jun 2024 – 22 Jun 2024)**

Semasa kerja-kerja di KM0.75 dijalankan, penutupan lorong motosikal bermula dari KM1.0 sejauh 200-meter akan dilaksanakan dan penunggang motosikal akan dilencongkan ke lorong kanan (seperti ditunjukkan anak panah **HIJAU** di dalam peta) sebelum memasuki semula lorong motosikal di KM0.8 Tambak Johor.

Kenderaan lain pula akan dilencongkan ke lorong tengah dan lorong kanan (seperti ditunjukkan anak panah **BIRU** di dalam peta) untuk meneruskan perjalanan ke Woodlands, Singapura.

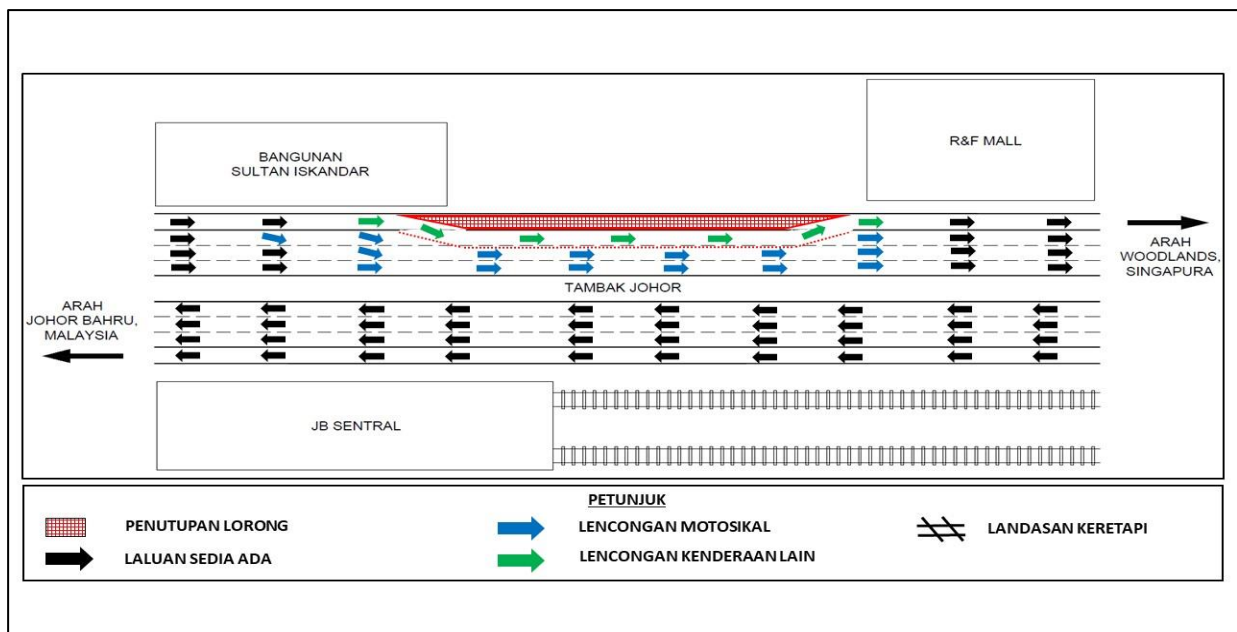

**Peringkat 2 (25 Jun 2024 – 26 Jun 2024)**

Semasa kerja-kerja di KM0.75 dijalankan, penutupan lorong motosikal dan lorong kiri bermula dari KM1.0 sejauh 200-meter akan dilaksanakan dan penunggang motosikal akan dilencongkan ke lorong tengah (seperti ditunjukkan anak panah HIJAU di dalam peta) sebelum memasuki semula lorong motosikal di KM0.8 Tambak Johor.

Kenderaan lain pula akan dilencongkan ke lorong kanan (seperti ditunjukkan anak panah BIRU di dalam peta) untuk meneruskan perjalanan ke Woodlands, Singapura.

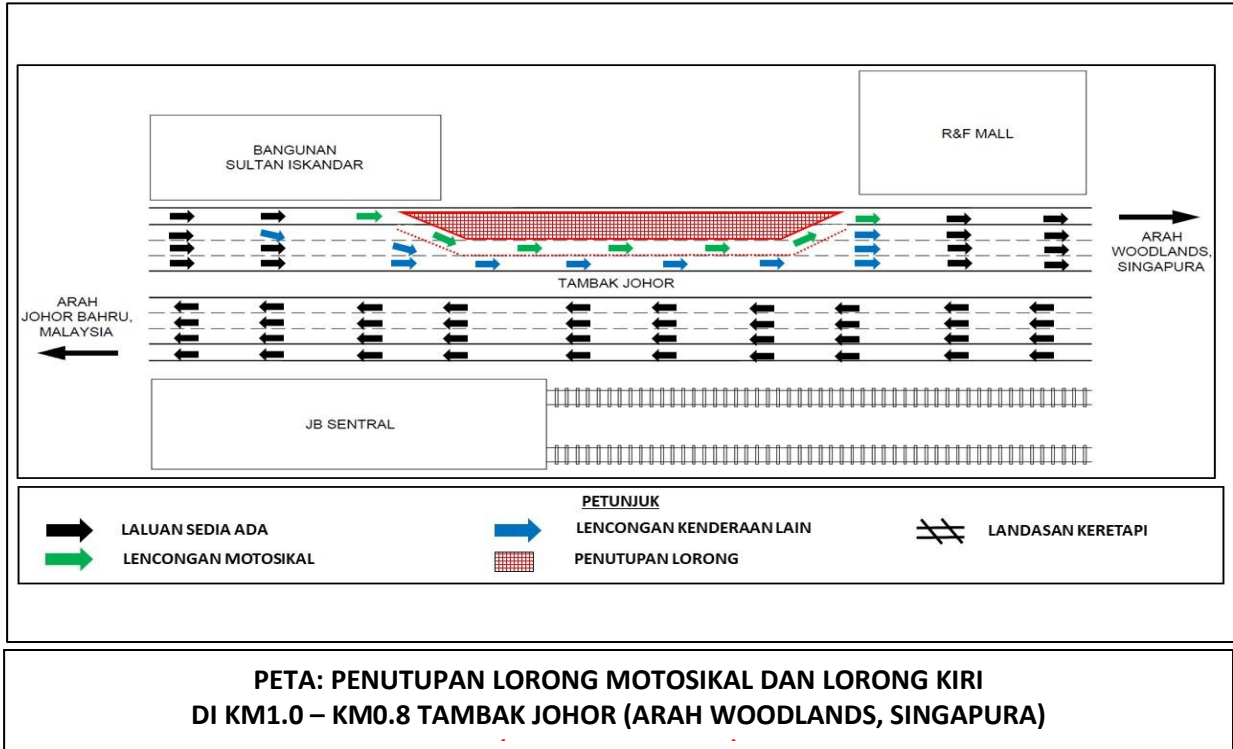

### Peringkat 3 (2 Julai 2024 – 3 Julai 2024 & 9 Julai 2024 – 10 Julai 2024)

Semasa kerja-kerja di KM0.75 dijalankan, penutupan lorong motosikal bermula dari KM1.0 sejauh 200-meter akan dilaksanakan dan penunggang motosikal akan dilencongkan ke lorong paling kanan (seperti ditunjukkan anak panah HIJAU di dalam peta) sebelum memasuki semula lorong motosikal di KM0.8 Tambak Johor.

Kenderaan lain juga akan menggunakan lorong kanan (seperti ditunjukkan anak panah BIRU di dalam peta) untuk meneruskan perjalanan ke Woodlands, Singapura.

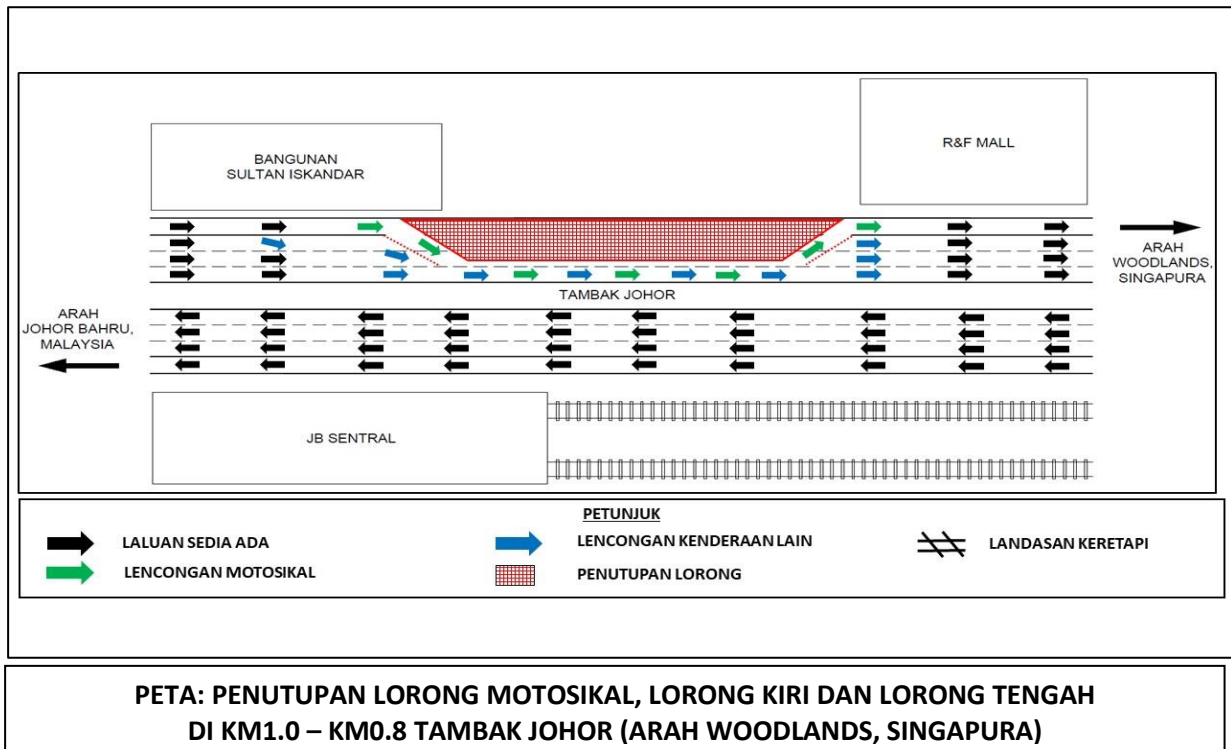

Pengguna jalan raya dinasihatkan untuk mematuhi arahan papan tanda trafik dan pengawal trafik yang bertugas.

Untuk maklumat lanjut, sila hubungi:

#### Sunway Construction Sdn Bhd

Mohd Sofie Hassan

Perhubungan Awam dan Pengurusan Pihak Berkepentingan

Tel: +60 19-2283004 Emel: sofie@sunway.com.my

#### Malaysia Rapid Transit Systems Sdn Bhd

Syarafina Diana binti Kamaruddin

Pengurusan Awam dan Pihak Berkepentingan

Tel.: +60 19-4522928 Emel: syarafina.diana@mymrt.com.my

#### Malaysia Rapid Transit Systems Sdn Bhd

Level 29, Menara JLand,

Jalan Wong Ah Fook,

80000 Johor Bahru, Malaysia

MRT Careline: 1800-88-6782

Emel: rts-feedback@mymrt.com.my

**INTERMITTENT LANES CLOSURE BY STAGES AT KM1.0 – KM0.8 JOHOR CAUSEWAY  
(WOODLANDS, SINGAPORE-BOUND)**

<b>Date</b>	10 June 2024 – 22 June 2024 (including Saturday and Sunday) 25 June 2024 – 26 June 2024 2 July 2024 – 3 July 2024 9 July 2024 – 10 July 2024
<b>Time</b>	8:00 p.m. – 3:00 a.m. (Woodlands, Singapore-bound)
<b>Duration</b>	31 days
<b>Reason</b>	To facilitate segmental box girder (SBG) launching works and other RTS Link project-related works

Please be informed that an **intermittent lanes closure by stages** will be implemented at Johor Causeway (Woodlands, Singapore-bound) from **10 June 2024 until 10 July 2024**. The works will be carried out from **8:00 p.m. until 3:00 a.m. for 31 days**. The traffic management plans are as below:

**Stage 1 (10 June 2024 – 22 June 2024)**

During the works at KM0.75, motorcycle lane closure will be implemented starting from KM1.0 for an approximate distance of 200 metre and motorists will be diverted to the right (as indicated by the **GREEN** arrows in the appended map) before re-entering the motorcycle lane at KM0.8.

Meanwhile, other vehicles will be diverted to the middle and right lane (as indicated by the **BLUE** arrows in the appended map) to continue their journey towards Woodlands, Singapore.

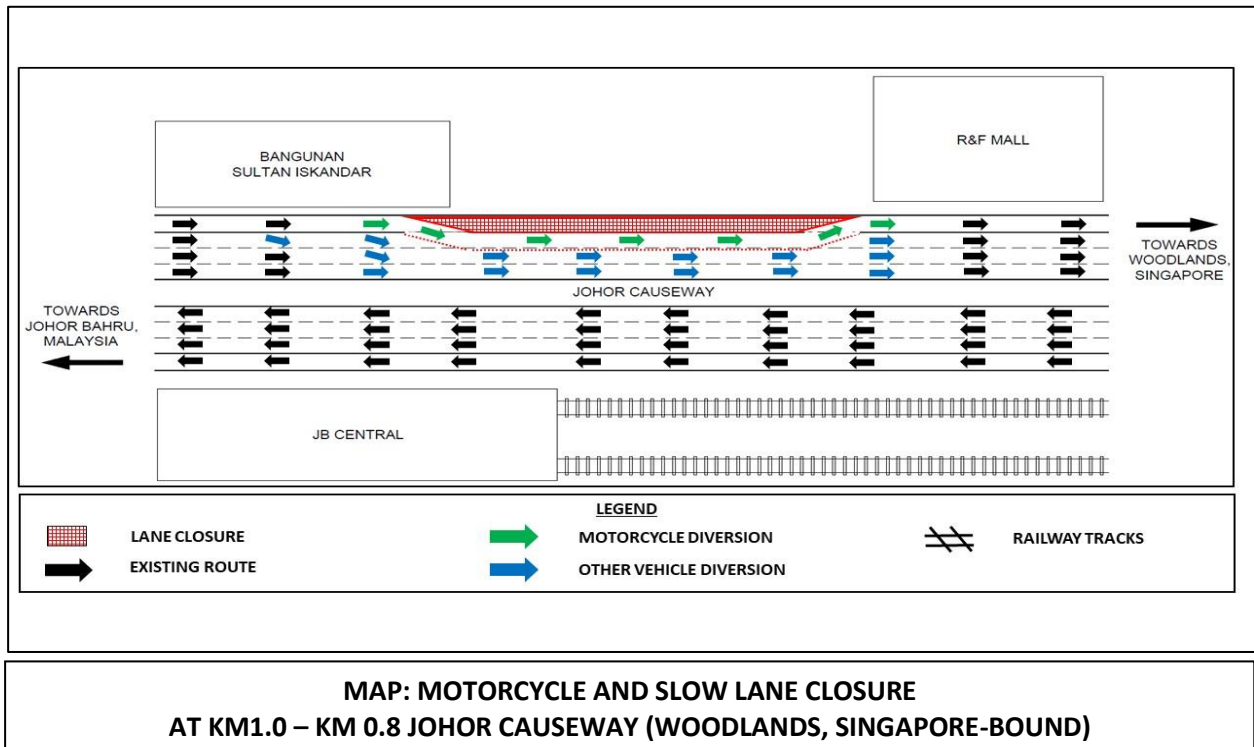

**Stage 2 (25 June 2024 – 26 June 2024)**

During the works at KM0.75, motorcycle lane closure will be implemented starting from KM1.0 for an approximate distance of 200 metre and motorists will be diverted to the middle lane (as indicated by the **GREEN** arrows in the appended map) before re-entering the motorcycle lane at KM0.8.

Meanwhile, other vehicles will be diverted to the right lane (as indicated by the **BLUE** arrows in the appended map) to continue their journey towards Woodlands, Singapore.

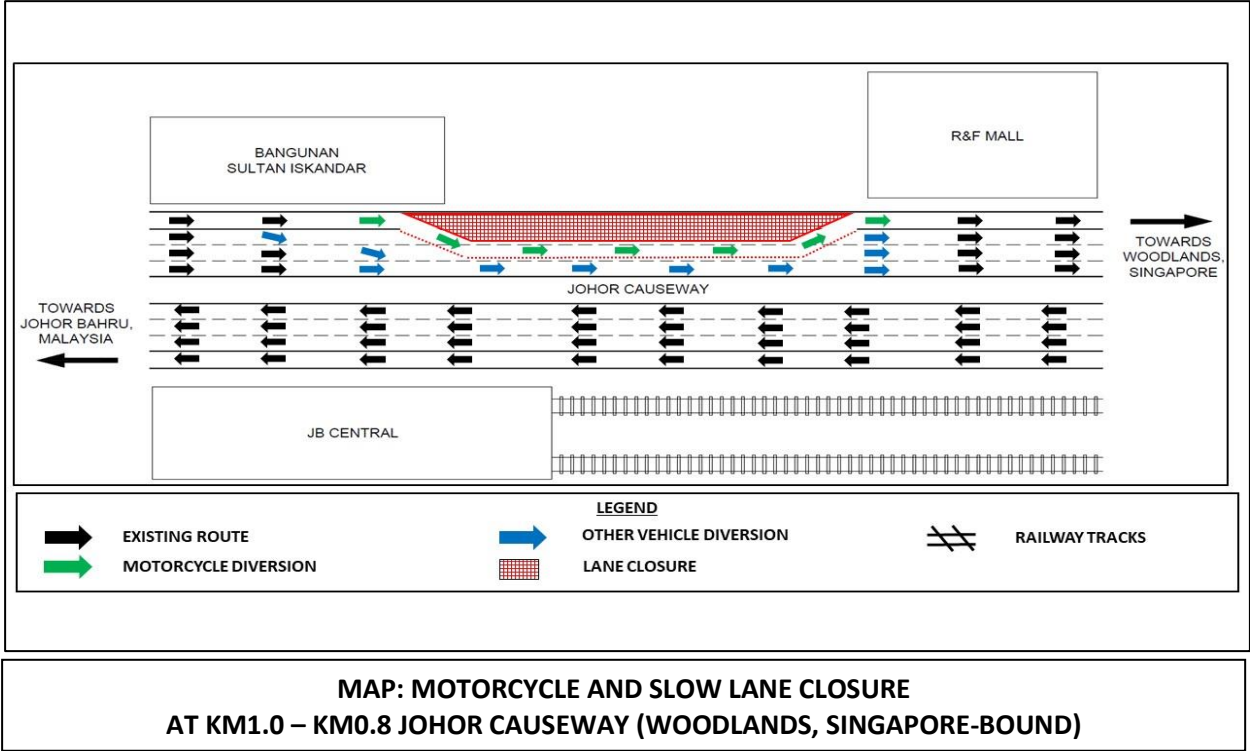

**Stage 3 (2 July 2024 – 3 July 2024 & 9 July 2024 – 10 July 2024)**

During the works at KM0.75, motorcycle lane closure will be implemented starting from KM1.0 for an approximate distance of 200 metre and motorists will be diverted to the right lane (as indicated by the **GREEN** arrows in the appended map) before re-entering the motorcycle lane at KM0.8.

Meanwhile, other vehicles will also be using the right lane (as indicated by the **BLUE** arrows in the appended map) to continue their journey towards Woodlands, Singapore.

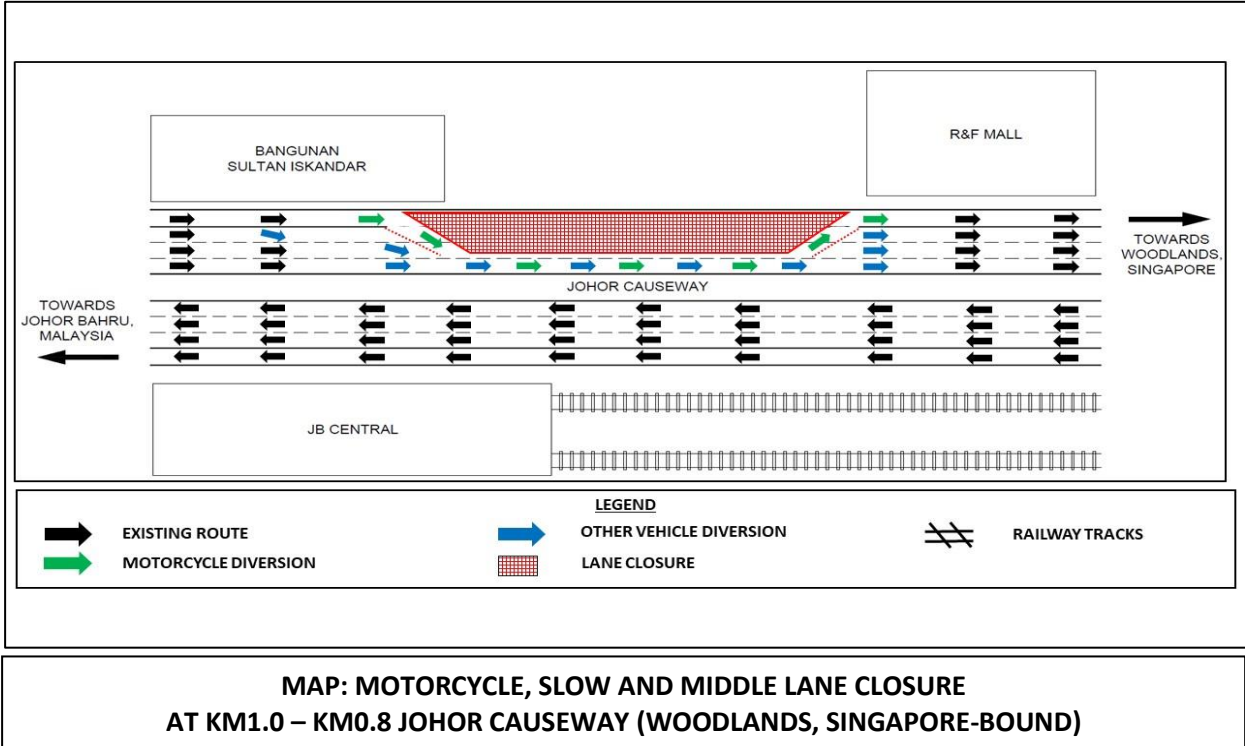

Road users are advised to follow the traffic signage and the direction of the traffic controller during the activation of these lane closures.

For further information, please contact:

**Sunway Construction Sdn Bhd**  
 Mohd Sofie Hassan  
 Public Relations and Stakeholder Management  
 Tel: +60 19-2283004 Email: sofie@sunway.com.my

**Malaysia Rapid Transit Systems Sdn Bhd**  
 Syarafina Diana binti Kamaruddin  
 Public Affairs and Stakeholders Management  
 Tel.: +60 19-4522928 Email: syarafina.diana@mymrt.com.my

**Malaysia Rapid Transit Systems Sdn Bhd**  
 Level 29, Menara JLand,  
 Jalan Wong Ah Fook,  
 80000 Johor Bahru, Malaysia  
 MRT Careline: 1800-88-6782  
 Email: rts-feedback@mymrt.com.my