



**PENGUMUMAN TRAFIK: PROJEK RAPID TRANSIT SYSTEM LINK (RTS LINK)  
3 JUN 2024**

**PENUTUPAN BERPERINGKAT SEBAHAGIAN JALAN IBRAHIM SULTAN, JOHOR BAHRU  
(BERHAMPIRAN HARLEY DAVIDSON, KEDUA-DUA ARAH)**

<b>Tarikh</b>	5 Jun 2024 – 31 Julai 2024
<b>Masa</b>	9:00 malam – 5:00 pagi
<b>Tempoh</b>	57 hari
<b>Tujuan</b>	Bagi kerja-kerja pelancaran kekotak segmen (SBG) dan kerja-kerja berkaitan projek RTS Link

Untuk makluman, **penutupan sebahagian Jalan Ibrahim Sultan, Johor Bahru (berhampiran Harley Davidson)** akan dilaksanakan secara berperingkat dari **5 Jun 2024 sehingga 31 Julai 2024**. Tempoh masa kerja adalah dari **9:00 malam hingga 5:00 pagi** selama **57 hari**. Pelan pengurusan trafik adalah seperti berikut:

**Penutupan A:**

Semasa penutupan sebahagian Jalan Ibrahim Sultan (arah Stulang Laut) dilaksanakan, pengguna jalan raya akan dilencongkan ke laluan kontra sepanjang 100 meter sebelum memasuki semula laluan asal untuk meneruskan perjalanan ke Stulang Laut (seperti ditunjukkan anak panah **HIJAU** di dalam peta).

Pengguna jalan raya dari Stulang Laut pula akan dilencongkan ke laluan kiri untuk meneruskan perjalanan ke Pusat Bandar (seperti yang ditunjukkan anak panah **BIRU** di dalam peta).

**Penutupan B:**

Semasa penutupan sebahagian Jalan Ibrahim Sultan (arah Pusat Bandar) dilaksanakan, lorong kiri akan ditutup dan pengguna jalan raya akan dilencongkan ke lorong kanan sehingga persimpangan lampu isyarat (seperti ditunjukkan anak panah **HIJAU** di dalam peta).

Pengguna jalan raya dinasihatkan untuk mematuhi arahan papan tanda trafik dan pengawal trafik bertugas. Untuk maklumat lanjut, sila rujuk peta di bawah.

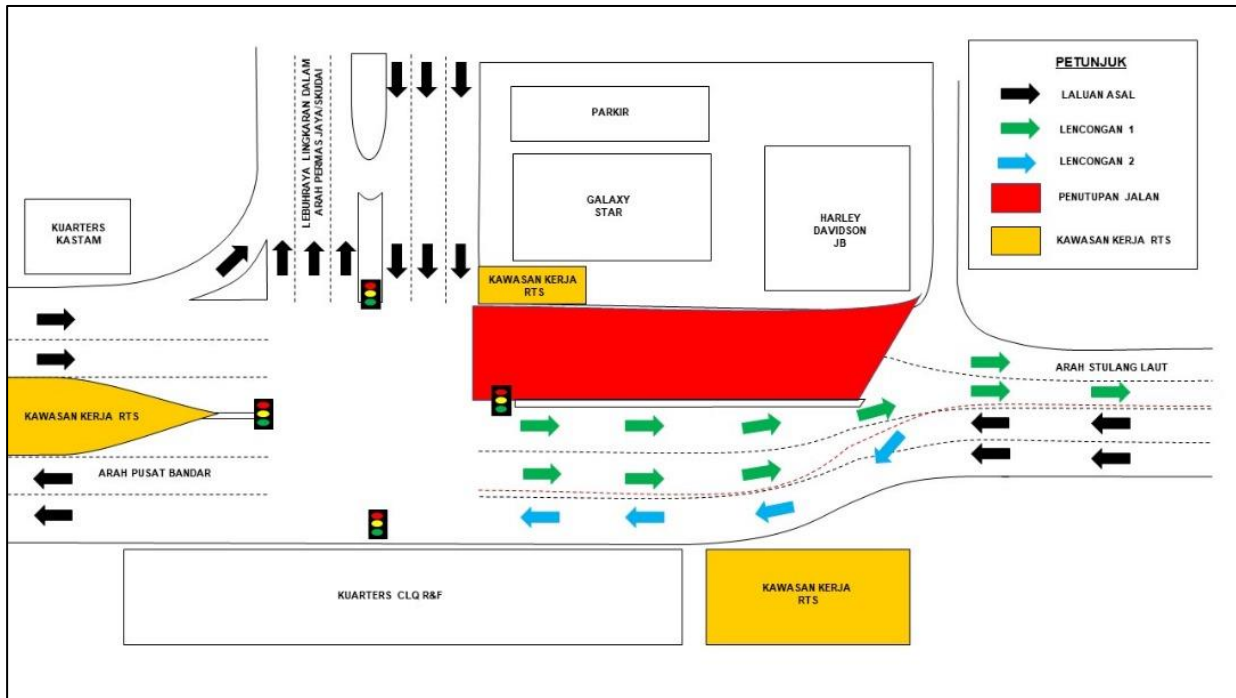

**PETA 1: PENUTUPAN SEBAHAGIAN JALAN IBRAHIM SULTAN, JOHOR BAHRU (BERHAMPIRAN HARLEY DAVIDSON, ARAH STULANG LAUT)**

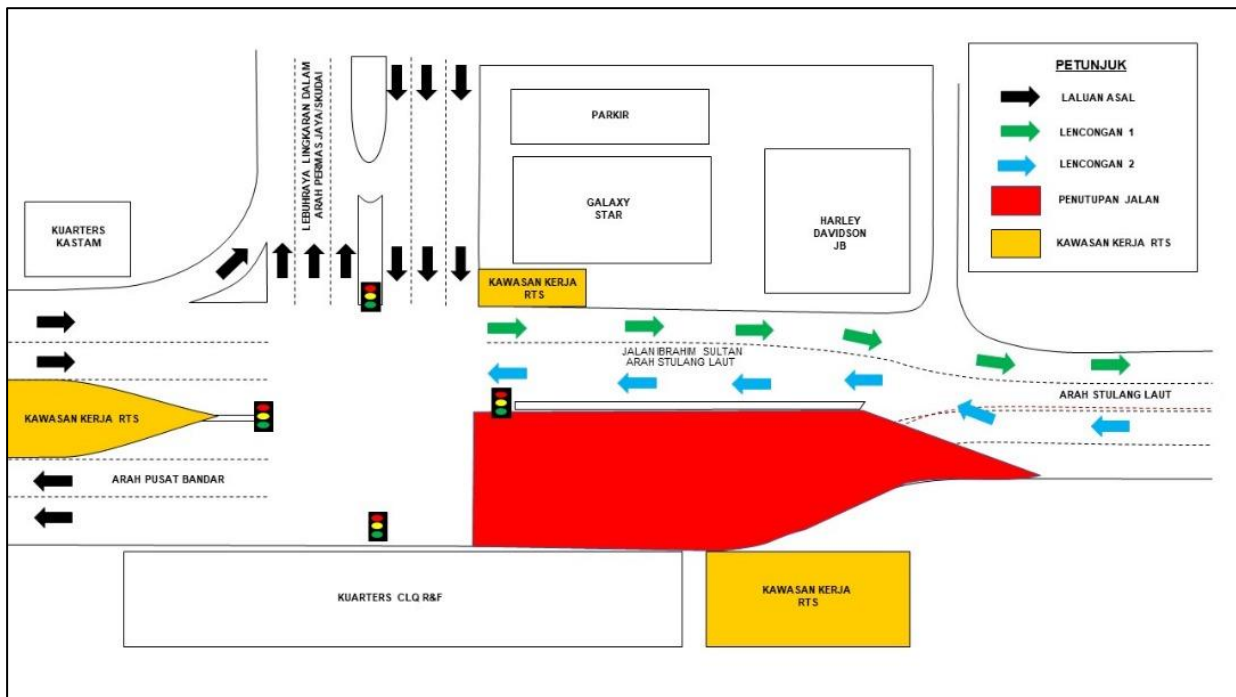

**PETA 2: PENUTUPAN SEBAHAGIAN JALAN IBRAHIM SULTAN, JOHOR BAHRU (BERHAMPIRAN HARLEY DAVIDSON, ARAH PUSAT BANDAR)**

Untuk maklumat lanjut, sila hubungi:

**Sunway Construction Sdn Bhd**

Mohd Sofie Hassan

Perhubungan Awam dan Pengurusan Pihak Berkepentingan

Tel: +60 19-228 3004 Emel: sofie@sunway.com.my

**Malaysia Rapid Transit Systems Sdn Bhd**

Syarafina Diana binti Kamaruddin

Pengurusan Awam dan Pihak Berkepentingan

Tel.: +60 19-452 2928 Emel: syarafina.diana@mymrt.com.my

**Malaysia Rapid Transit Systems Sdn Bhd**

Tingkat 29, Menara JLand,

Jalan Wong Ah Fook,

80000 Johor Bahru, Malaysia

MRT Careline: 1800-88-6782

Emel: rts-feedback@mymrt.com.my

**PARTIAL ROAD CLOSURE BY STAGES AT JALAN IBRAHIM SULTAN, JOHOR BAHRU  
(NEAR HARLEY DAVIDSON, BOTH BOUND)**

<b>Date</b>	5 June 2024 – 31 July 2024
<b>Time</b>	9:00 pm – 5:00 am
<b>Duration</b>	57 days
<b>Reason</b>	To facilitate segmental box girder (SBG) launching works and other RTS Link project-related works

Please be informed that **partial road closure by stages** will be conducted at **Jalan Ibrahim Sultan, Johor Bahru (near Harley Davidson, both bound)** from **5 June 2024 until 31 July 2024**. The works will be carried out from **9:00 pm until 5:00 am** for **57 days**. The traffic management plans are as follows:

**Closure A:**

During the partial closure of Jalan Ibrahim Sultan (Stulang Laut Bound), road users will be diverted onto the contra-flow lane for approximate distance of 100 meters before re-entering the original route to continue their journey towards Stulang Laut (as indicated by the **GREEN** arrows in the appended map).

Meanwhile, road users from Stulang Laut will be diverted onto the left lane to continue their journey towards City Centre (as indicated by the **BLUE** arrows in the appended map).

**Closure B:**

During the partial closure of Jalan Ibrahim Sultan (City Centre Bound), the left lane will be closed and road users will be diverted onto the right lane until the traffic light intersection (as indicated by the **GREEN** arrows in the appended map).

Road users are advised to follow the traffic signages and the direction of the traffic controller during the activation of these closures. For further information, please refer to the map below.

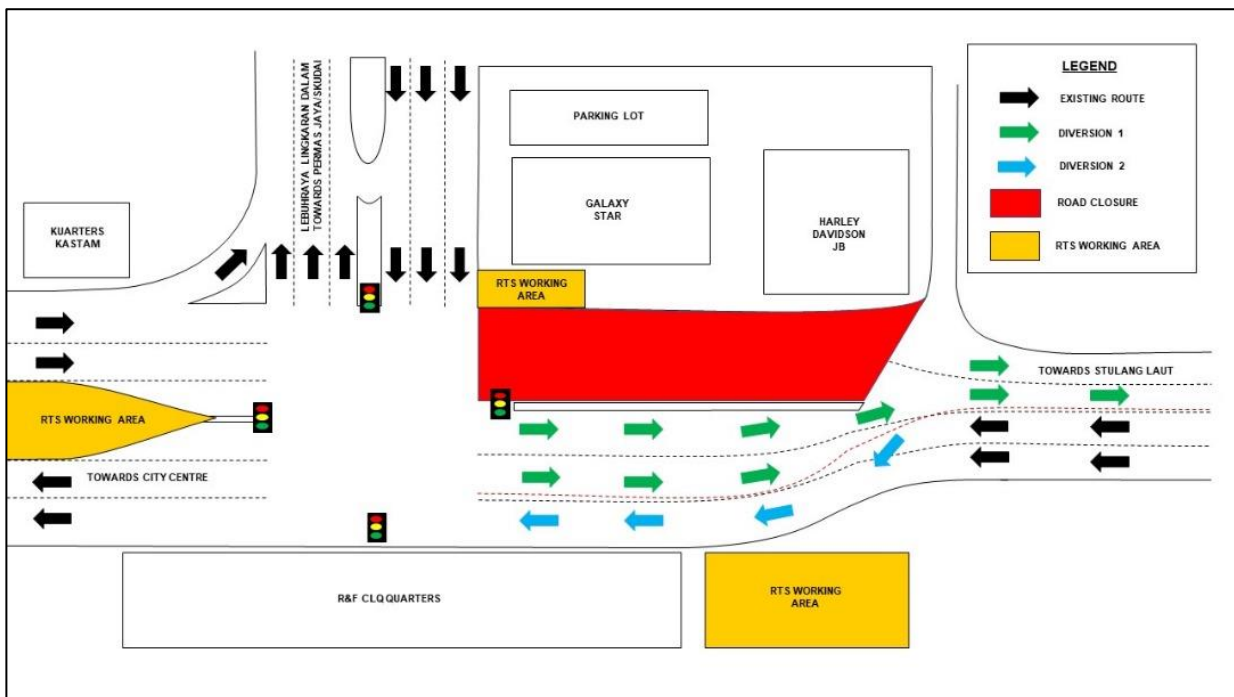

**MAP 1: PARTIAL ROAD CLOSURE AT JALAN IBRAHIM SULTAN, JOHOR BAHRU  
(NEAR HARLEY DAVIDSON, STULANG LAUT BOUND)**

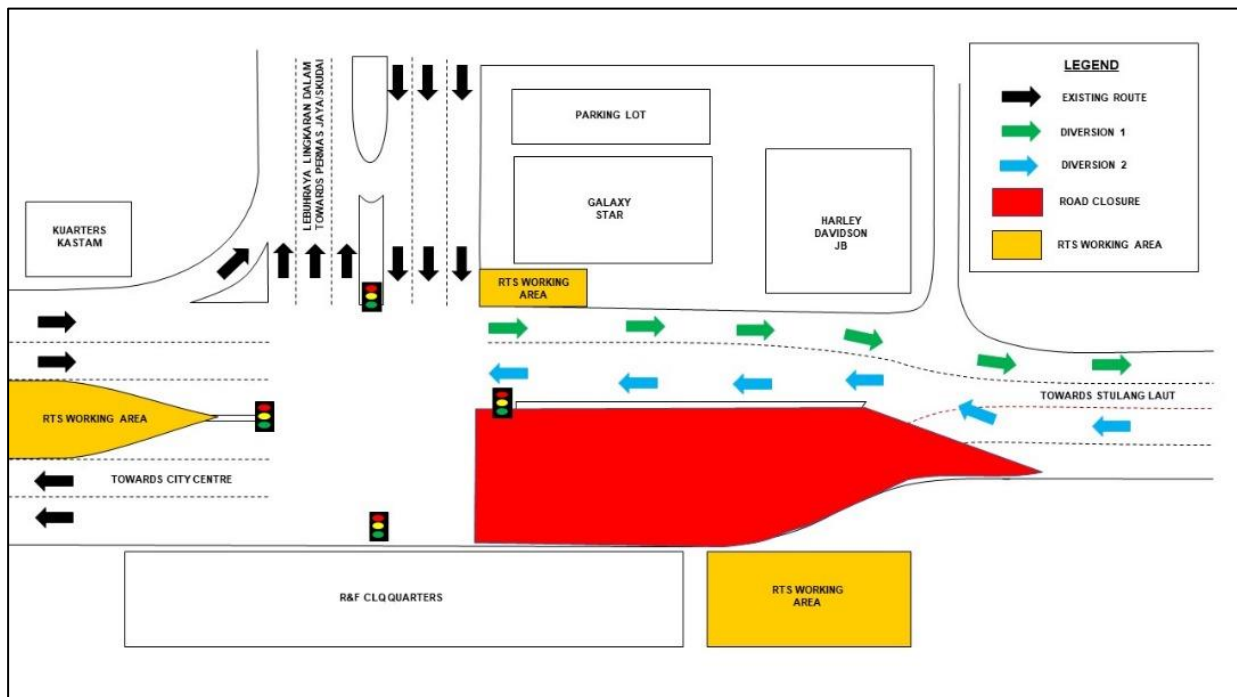

**MAP 2: PARTIAL ROAD CLOSURE AT JALAN IBRAHIM SULTAN, JOHOR BAHRU (NEAR HARLEY DAVIDSON, CITY CENTRE BOUND)**

For more information, please contact:

**Sunway Construction Sdn Bhd**

Mohd Sofie Hassan  
 Public Relations and Stakeholder Management  
 Tel: +60 19-228 3004 Email: sofie@sunway.com.my

**Malaysia Rapid Transit Systems Sdn Bhd**

Syarafina Diana binti Kamaruddin  
 Public Affairs and Stakeholder Management  
 Tel.: +60 19-452 2928 Email: syarafina.diana@mymrt.com.my

**Malaysia Rapid Transit Systems Sdn Bhd**

Level 29, Menara JLand,  
 Jalan Wong Ah Fook,  
 80000 Johor Bahru, Malaysia  
 MRT Careline: 1800-88-6782  
 Email: rts-feedback@mymrt.com.my