



**PENGUMUMAN TRAFIK: PROJEK RAPID TRANSIT SYSTEM (RTS LINK)  
20 SEPTEMBER 2023**

**PENUTUPAN LORONG KIRI DI JALAN TEBRAU MENGHALA KE JALAN TUN ABDUL RAZAK  
(ARAH JB SENTRAL), JOHOR BAHRU**

<b>Tarikh</b>	21 September 2023 – 19 Disember 2023
<b>Masa</b>	24 jam sehari
<b>Jangka masa</b>	90 hari
<b>Tujuan</b>	Bagi pelaksanaan kerja-kerja cerucuk tanjakan luar RTS Link dan lain-lain kerja berkaitan

Untuk makluman, penutupan lorong kiri di Jalan Tebrau menghala ke Jalan Tun Abdul Razak (arah JB Sentral) akan dilaksanakan dari **21 September 2023 hingga 19 Disember 2023**. Kerja-kerja pembinaan akan dilaksanakan selama **24 jam sehari selama 90 hari**. Pelan pengurusan trafik adalah seperti berikut:

Semasa penutupan lorong paling kiri sejauh 200 meter di Jalan Tebrau menghala ke Jalan Tun Abdul Razak (Arah JB Sentral) dilaksanakan, pengguna jalan raya akan dilencongkan ke laluan sedia ada seperti yang ditunjukkan dengan anak panah berwarna **HIJAU** di dalam peta di bawah.

Pengguna jalan raya dinasihatkan untuk mematuhi arahan papan tanda trafik dan pengawal bendera sepanjang tempoh penutupan dilaksanakan. Untuk maklumat lanjut, sila rujuk peta di bawah.

---

**LEFT LANE CLOSURE AT JALAN TEBRAU HEADING TO JALAN TUN ABDUL RAZAK  
(JB SENTRAL-BOUND), JOHOR BAHRU**

<b>Date</b>	21 September 2023 – 19 December 2023
<b>Time</b>	24 hours
<b>Duration</b>	90 days
<b>Reason</b>	To facilitate the bore piling works for RTS Link external ramp construction and other related works

Please be informed that there will be a left lane closure at Jalan Tebrau heading towards Jalan Tun Abdul Razak (JB Sentral - Bound) from **21 September 2023 until 19 December 2023**. Construction works will be carried out **24 hours for 90 days**. The traffic management plan are as follows:

During the activation of left lane closure for a stretch 200 meters at Jalan Tebrau heading towards Jalan Tun Abdul Razak (JB Sentral – Bound), motorists will be diverted to the remaining lane to continue their journey as indicated by the **GREEN** arrows in the appended map.

Motorists are advised to follow the traffic signages and flagmen during the activation of these lane closures. For further information, please refer to the map below.

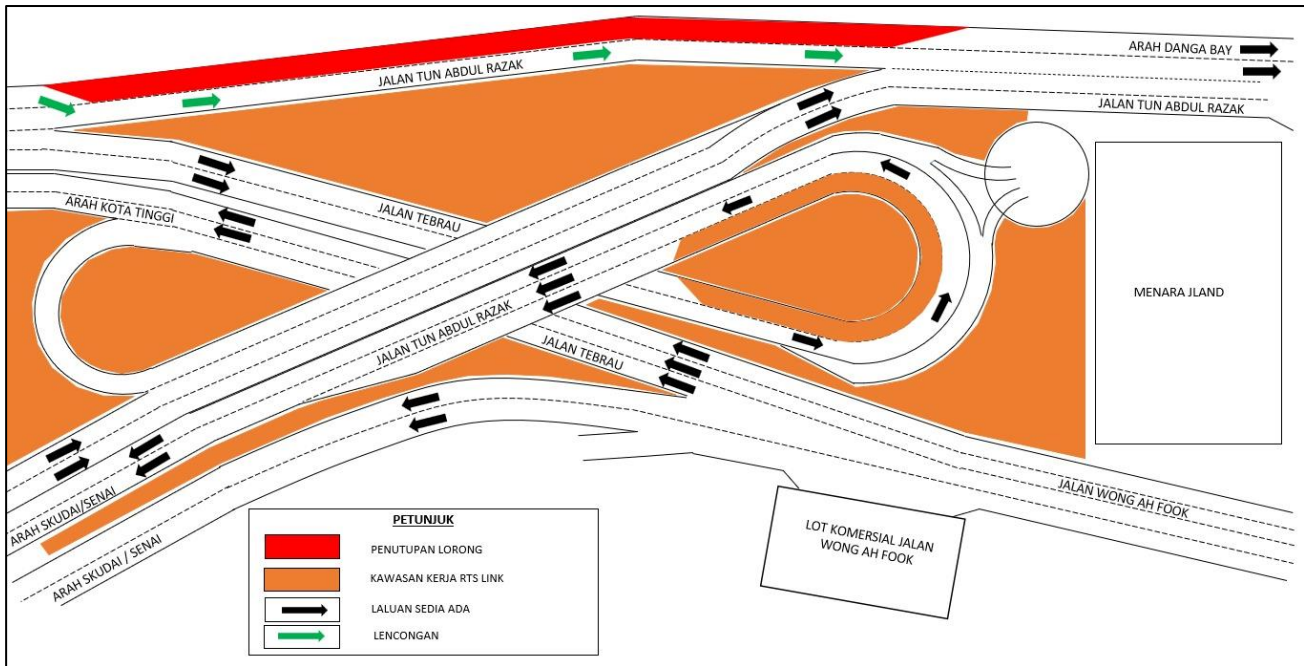

**PETA: PENUTUPAN LORONG KIRI DI JALAN TEBRAU MENGHALA KE JALAN TUN ABDUL RAZAK (ARAH JB SENTRAL), JOHOR BAHRU**

**Untuk maklumat lanjut, sila hubungi:**

**Adil Permata Sdn Bhd**

Dzul Shuhada

PR and Stakeholders Management

Tel: +60 14-9376841 Emel: dzul@adilpermata.com

**Malaysia Rapid Transit Systems Sdn Bhd**

Syarafina Diana Kamaruddin

Strategic Communications and Stakeholders Relations

Tel.: +60 19-4522928 Emel: syarafina.diana@mymrt.com.my

**Malaysia Rapid Transit Systems Sdn Bhd**

Level 29, Menara JLand,

Jalan Wong Ah Fook,

80000 Johor Bahru, Malaysia

Careline No: 1800-88-6782

Emel: rts-feedback@mymrt.com.my