

**PENGUMUMAN TRAFIK  
24 JUN 2020**

**LANJUTAN PENUTUPAN LORONG KANAN DI JALAN IPOH (ARAH KUALA LUMPUR & ARAH KEPONG) BERHADAPAN KOMPLEKS MUTIARA DI LUAR WAKTU PUNCAK**

<b>Tarikh</b>	25 Jun 2020 – 24 Ogos 2020
<b>Masa</b>	9:00 pagi – 4:30 petang
<b>Jangka masa</b>	2 bulan
<b>Tujuan</b>	Untuk kerja-kerja pengorekan dan sebarang kerja-kerja pembinaan MRT yang berkaitan.

Untuk makluman, penutupan lorong kanan **di luar waktu puncak** di Jalan Ipoh (Arah Kuala Lumpur dan Arah Kepong) berhadapan Kompleks Mutiara akan dilanjutkan dari **25 Jun 2020 sehingga 24 Ogos 2020**. Tempoh masa untuk kerja-kerja akan **bermula dari 9:00 pagi hingga 4:30 petang, selama 2 bulan**.

**Penutupan lorong kanan (Arah Kuala Lumpur)** bermula selepas Jalan Vethavanam hingga ke persimpangan lampu isyarat Jalan St. Thomas. Manakala, **penutupan lorong kanan (Arah Kepong)** bermula selepas Wisma Kah Motor sehingga E- Garage.

Semasa penutupan lorong dilaksanakan, satu (1) lorong masih boleh digunakan oleh pemandu di kedua-dua arah pada setiap masa.

Pengguna jalan raya dinasihatkan untuk mematuhi arahan papan tanda trafik dan pengawal bendera yang bertugas. Untuk maklumat lanjut, sila rujuk peta di bawah

.....

**CONTINUATION OF OFF-PEAK RIGHT LANE CLOSURE AT JALAN IPOH (KUALA LUMPUR-BOUND & KEPONG-BOUND) IN FRONT OF MUTIARA COMPLEX**

<b>Date</b>	25 June 2020 – 24 August 2020
<b>Time</b>	9:00am – 4:30pm
<b>Duration</b>	2 months
<b>Reason</b>	To facilitate excavation works and any other related works for MRT construction.

Please be advised, the **off-peak** right lane closure at Jalan Ipoh (Kuala Lumpur-bound and Kepong-bound) in front of Mutiara Complex will be continued **from 25 June 2020 until 24 August 2020**. Construction **works will start from 9:00am to 4:30pm for a period of 2 months**.

The right lane closure (Kuala Lumpur-bound) will take place after Jalan Vethavanam until traffic light junction at Jalan St. Thomas. Meanwhile, the right lane closure (Kepong-bound) will take place after Wisma Kah Motor until E- Garage.

During the closures, there will be one (1) lane made available for motorists on both bounds at all times.

Motorists are advised to follow the traffic signage and the direction of flagmen during the road closure. For further information, please refer the map below.

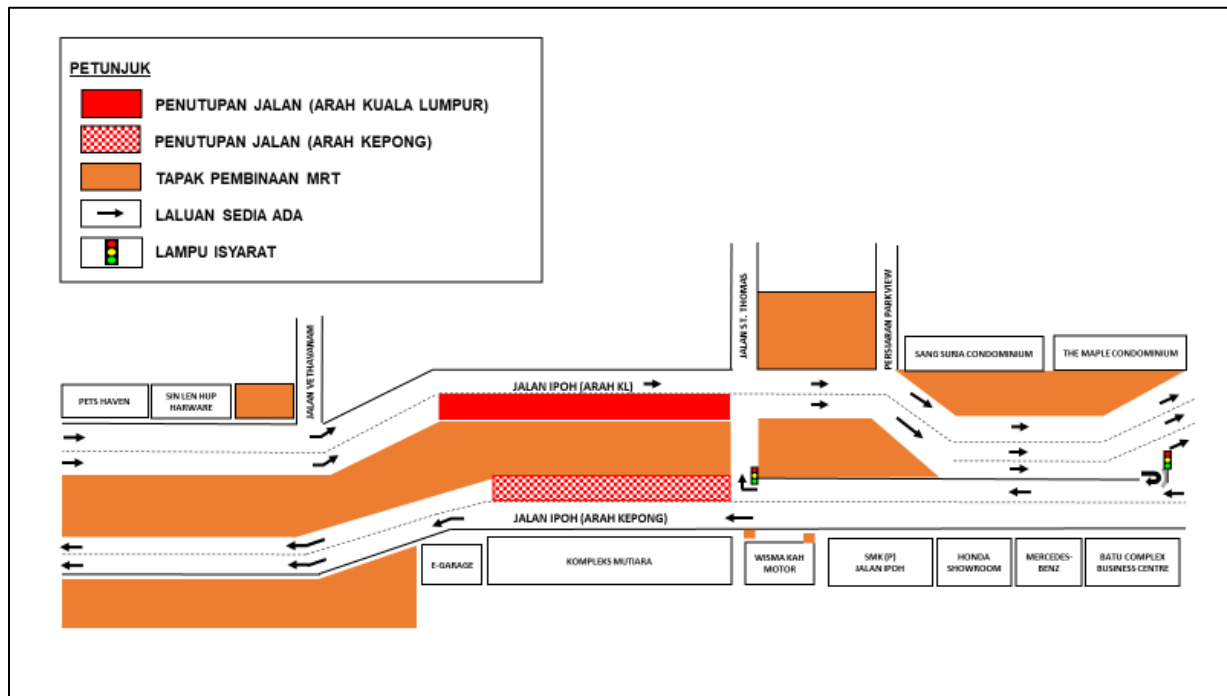

**PETA: LANJUTAN PENUTUPAN LORONG KANAN DI JALAN IPOH (ARAH KUALA LUMPUR & ARAH KEPONG) BERHADAPAN KOMPLEKS MUTIARA DI LUAR WAKTU PUNCAK**

**For media enquiries, please contact:**

Shera Choo

Tel: +6012-290 1992

sherachoo@ijm.com

Mohar Zainal Abidin

Tel: +603 7493 3961

Mohar@mgjv-kvmrt.com.my

**MMC GAMUDA KVMRT (PDP SSP) SDN BHD (1117100-V)**

Block A, Level 17, Menara Mustapha Kamal, PJ Trade Centre

No 8, Jalan PJU 8/8A, Bandar Damansara Perdana, 47820 Petaling Jaya

Selangor Darul Ehsan, Malaysia

T: +603-7494 2222 F: +603-7727 0222 [www.mymrt.com.my](http://www.mymrt.com.my)