

**PENGUMUMAN TRAFIK
21 OGOS 2019**

1. LANJUTAN PENUTUPAN LORONG SEPANJANG JALAN KUALA SELANGOR (ARAH SUNGAI BULOH DAN ARAH KEPONG)

Tarikh	23 Ogos 2019 – 22 September 2019
Masa	24 jam; 10:00malam – 6:00pagi
Jangka masa	1 bulan
Sebab	Menjalankan kerja-kerja pemasangan kekotak segmen (SBG), pemasangan dinding parapet, kerja-kerja konkrit di atas landasan dan sebarang kerja berkaitan.

Untuk makluman, penutupan lorong **secara berkala** sepanjang Jalan Kuala Selangor (Arah Sungai Buloh dan Arah Kepong) akan dilanjutkan dari **23 Ogos 2019 hingga 22 September 2019 selama 1 bulan**. Tempoh masa untuk kerja-kerja dan pelan pengurusan trafik adalah seperti berikut:

Penutupan A (24 jam):

- I. Semasa penutupan Lorong paling kiri Jalan Kuala Selangor (Arah Sungai Buloh) di KM47 sebelum susur masuk ke Sierramas.
- II. Semasa penutupan Lorong paling kiri sepanjang 100 meter di Jalan Kuala Selangor (Arah Sungai Buloh) selepas susur masuk ke Sierramas; Semasa penutupan Lorong kiri sepanjang 100 meter di susur naik menghala ke Sierramas.
- III. Semasa penutupan Lorong kiri sepanjang 100 meter menghala ke Tol Sungai Buloh.
- IV. Semasa penutupan Lorong kiri sepanjang 100 meter di susur masuk ke Sierramas dan Sekolah Antarabangsa IGB (Arah Kepong).

Penutupan B (24 jam): Semasa penutupan sepanjang 100 meter, lorong kanan akan ditutup menghala ke Tol Sungai Buloh. **Semasa penutupan B Penutupan A (iii) tidak akan berlaku.**

Penutupan C (10 malam – 6 pagi):

- I. Semasa penutupan sepanjang 80 meter di sebahagian Lorong kiri selepas Tol Sungai Buloh sebelum meneruskan perjalanan di Jalan Kuala Selangor (Arah Sungai Buloh).
- II. Semasa penutupan sepanjang 80 meter di sebahagian Lorong kanan selepas Tol Sungai Buloh sebelum meneruskan perjalanan di Jalan Kuala Selangor (Arah Sungai Buloh).
- III. Semasa penutupan sepanjang 50 meter di sebahagian Lorong kanan di susur jalan ke Sierramas.
- IV. Semasa penutupan sepanjang 50 meter di sebahagian Lorong kiri di susur jalan ke Sierramas.

Setiap penutupan berikut adalah secara berkala.

Pengguna jalan raya dinasihatkan untuk mematuhi arahan papan tanda trafik dan pengawal bendera yang bertugas. Untuk maklumat lanjut, sila rujuk peta di bawah.

1. CONTINUATION OF LANE CLOSURES ALONG JALAN KUALA SELANGOR (SUNGAI BULOH-BOUND AND KEPONG-BOUND)

Date	23 August 2019 – 22 September 2019
Time	24 hours; 10:00pm – 6:00am
Duration	1 month
Reason	To facilitate the launching of segmental box girder (SBG), parapet wall installation, concreting works for track plinths and any other related works.

There will be a continuation **intermittent** lane closures along Jalan Kuala Selangor (Sungai Buloh-bound and Kepong-bound) from **23 August 2019 until 22 September 2019 for 1 month**. Construction works timing and traffic management plan are as below:

Closure A (24 hours):

- I. During the left-most lane closure along Jalan Kuala Selangor (Sungai Buloh-bound) at KM47 before ramp up to Sierramas.
- II. During the left-most lane closure for a stretch of 100 metres along Jalan Kuala Selangor (Sungai Buloh-bound) after the ramp up to Sierramas; during the left lane closure for a stretch of 100 metres on the ramp up to Sierramas.
- III. During the left lane closure for a stretch of 100 metres towards Sungai Buloh toll.
- IV. During the left lane closure for a stretch of 100 metres on the ramp up to Sierramas and IGB International School (Kepong-bound).

Closure B (24 hours): During the right lane closure for a stretch of 100 metres towards Sungai Buloh toll. **During closure B, Closure A (iii) will not take place.**

Closure C (10pm – 6am):

- I. During the partial lane closure for a stretch of 80 metres after Sungai Buloh toll before joining into Jalan Kuala Selangor (Sungai Buloh-bound).
- II. During the partial right lane closure for a stretch of 80 metres after Sungai Buloh toll before joining into Jalan Kuala Selangor. (Sungai Buloh-bound).
- III. During the partial right lane closure for a stretch of 50 metres on the ramp up to Sierramas.
- IV. During the partial left lane closure for a stretch of 50 metres on the ramp up to Sierramas.

All the above closures will be implemented intermittently.

Motorists are advised to follow the traffic signage and flagmen during road closure. Please refer map below for further information.

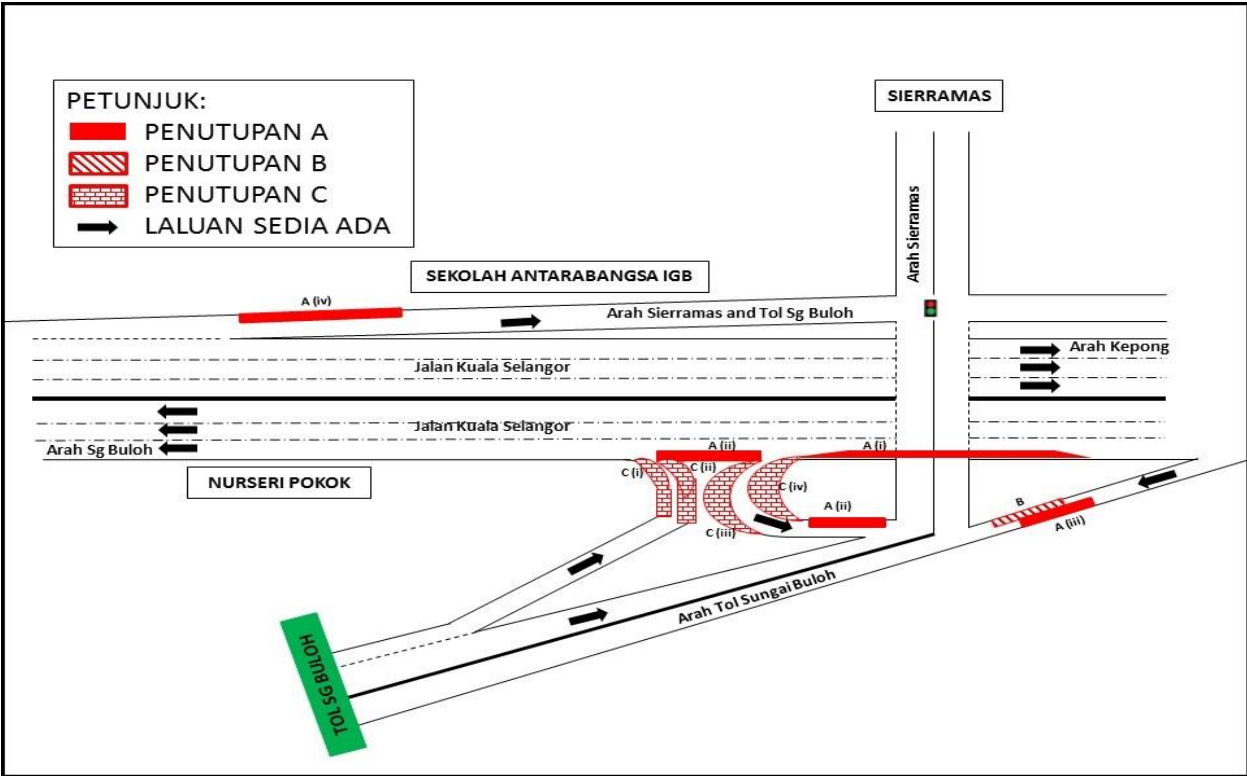

**PETA 1: LANJUTAN PENUTUPAN LORONG SEPANJANG JALAN KUALA SELANGOR
(ARAH SUNGAI BULOH DAN ARAH KEPONG)**

2. LANJUTAN PENUTUPAN JALAN SECARA BERKALA DAN PENGAKTIFAN LALUAN KONTRA SEPANJANG KM8.9 - KM9.5 LEBUHRAYA SKVE (ARAH BANTING DAN KAJANG)

Tarikh	23 Ogos 2019 - 12 September 2019
Masa	8.00pagi – 6.00petang dan 10.00malam-6.00pagi
Jangka masa	21 hari
Tujuan	Untuk kerja-kerja pelaksanaan pelan pengurusan lalu lintas, pelancaran kekotak segmen (SBG) dan sebarang kerja berkaitan.

Untuk makluman, penutupan jalan secara berkala dan pelaksanaan laluan kontra sepanjang Lebuhraya SKVE akan dilanjutkan dari **23 Ogos 2019 hingga 12 September 2019**. Tempoh masa untuk kerja-kerja adalah seperti berikut:

- **8.00 pagi-6.00 petang – Penutupan Jalan secara berkala**
- **10.00 malam-6.00 pagi – Penutupan Jalan Penuh dan Pengaktifan Laluan Kontra.**

Pelan pengurusan trafik adalah seperti berikut:

PETA 2 (A) (Penutupan A): Semasa penutupan sepanjang 600 meter, lorong paling kanan akan ditutup di kedua-dua arah. Penutupan ini akan dilaksanakan untuk salah satu arah pada satu masa dan dua lorong akan disediakan kepada pengguna jalan raya.

Penutupan B: Semasa penutupan sepanjang 150 meter di jalan susur menghala ke Persiaran Sierra Utama, lorong paling kanan akan ditutup dan lorong kiri akan disediakan kepada pengguna jalan raya.

PETA 2 (B): Semasa Penutupan penuh jalan sepanjang 300 meter dari persimpangan Hentian Plaza Tol Ayer Hitam sehingga Rumah Pam Air 16 Sierra (Arah Kajang), pengguna jalan raya yang menghala ke arah Kajang dinasihatkan untuk menggunakan laluan bertentangan (Arah Banting) di Lebuhraya SKVE.

PETA 2 (C): Semasa penutupan penuh jalan sepanjang 300-meter sebelum persimpangan ke Persiaran Sierra Utama sehingga sebelum Plaza Tol Ayer Hitam (Arah Banting), pengguna jalan raya yang menghala ke arah Kajang dinasihatkan untuk menggunakan laluan bertentangan (Arah Kajang) di Lebuhraya SKVE.

Pengguna jalan raya dinasihatkan untuk mematuhi arahan papan tanda trafik dan Pengawal bendera yang bertugas. Untuk maklumat lanjut, Sila rujuk peta dibawah.

2. CONTINUATION OF INTERMITTENT LANE CLOSURES AND ACTIVATION OF CONTRA-FLOW ALONG KM8.9 – KM9.5 SKVE HIGHWAY (BANTING AND KAJANG BOUND)

Date	23 August 2019 - 12 September 2019
Time	8.00am-6.00pm and 10.00pm-6.00am
Duration	21 days
Reason	To facilitate implementation of traffic management plan, segmental box girder (SBG) launching works and any other related works.

There will be continuation of **intermittent** full bound closures and activation of **contra flow** along SKVE Highway from **23 August 2019 – 12 September 2019**. Construction works will be as below:

- **8.00am-6.00pm – Intermittent Lane Closure.**
- **10.00pm-6.00am – Full Bound Closure & Activation of Contraflow.**

The traffic management plan as below:

MAP 2 (A): (Closure A): During this closure for a stretch approximately 600 meters for both bounds the right-most lane will be closed. This closure will be activated at one time on either bound, while two lanes will be made available for motorists.

Closure B: During this closure for a stretch of approximately 150 meters along SKVE ramp heading to Persiaran Sierra Utama the right-most lane will be closed, while one lane will be made available for motorists at the ramp.

MAP 2 (B): During this full bound closure for a stretch of 300 meters the lanes will be closed from the junction of Hentian Plaza Tol Ayer Hitam until Pump House 16 Sierra towards Kajang, while the motorists will be directed to the opposite bound (Banting bound) at SKVE highway.

MAP 2 (C): During this full bound closure for a stretch of 300 meters the lanes will be closed from slip road to Persiaran Sierra Utama until before Plaza Tol Ayer Hitam towards Banting, while motorists will be directed to the opposite bound (Kajang bound) at SKVE highway.

Motorists are advised to follow the traffic signage and flagmen during road closure. Please refer to the map below for further information.

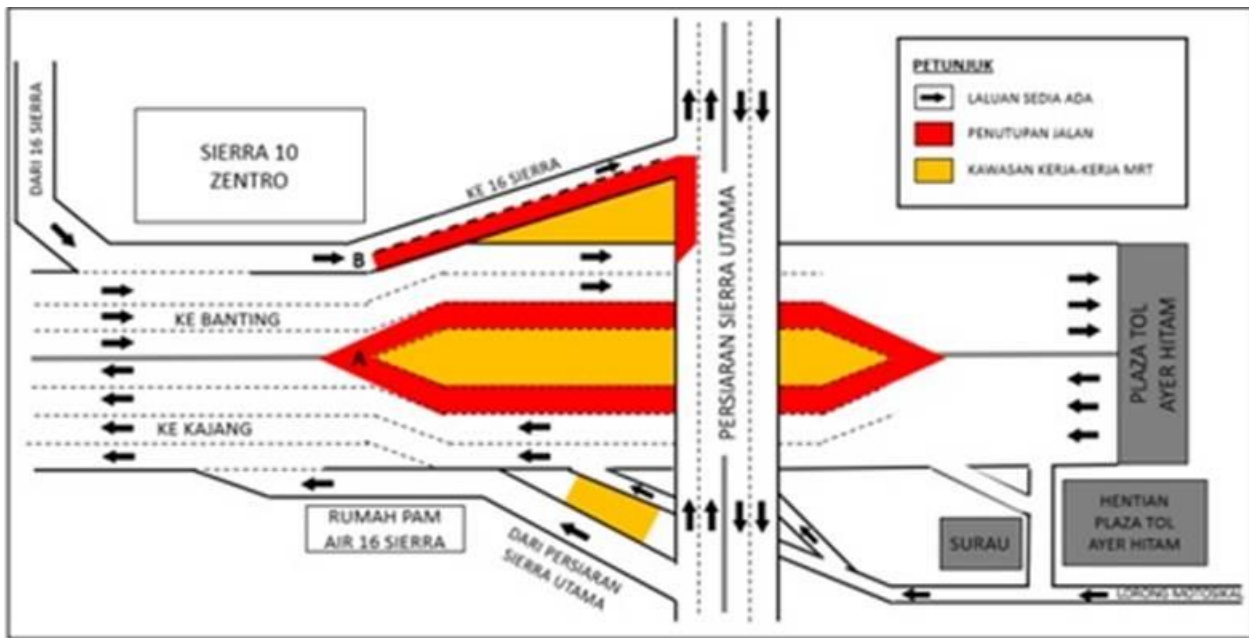

PETA 2 (A): LANJUTAN PENUTUPAN JALAN SECARA BERKALA DAN PENGAKTIFAN LALUAN KONTRA SEPANJANG KM8.9 – KM9.5 LEBUHRAYA SKVE (ARAH BANTING DAN KAJANG)

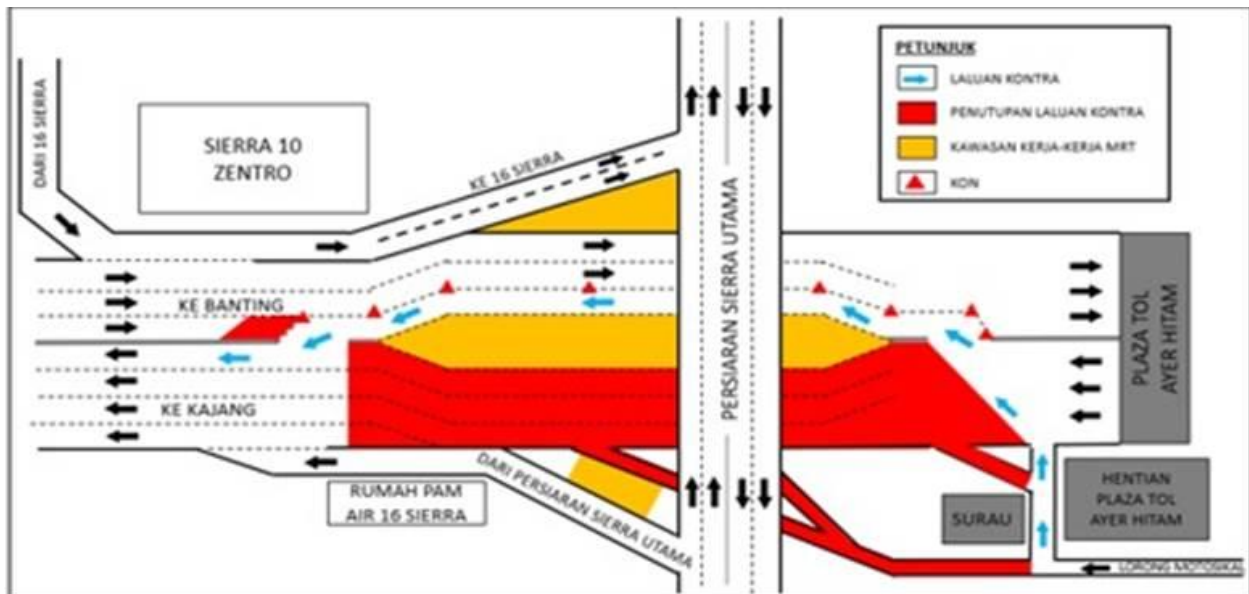

PETA 2 (B): LANJUTAN PENUTUPAN JALAN SECARA BERKALA DAN PENGAKTIFAN LALUAN KONTRA SEPANJANG KM8.9 – KM9.5 LEBUHRAYA SKVE (ARAH BANTING DAN KAJANG)

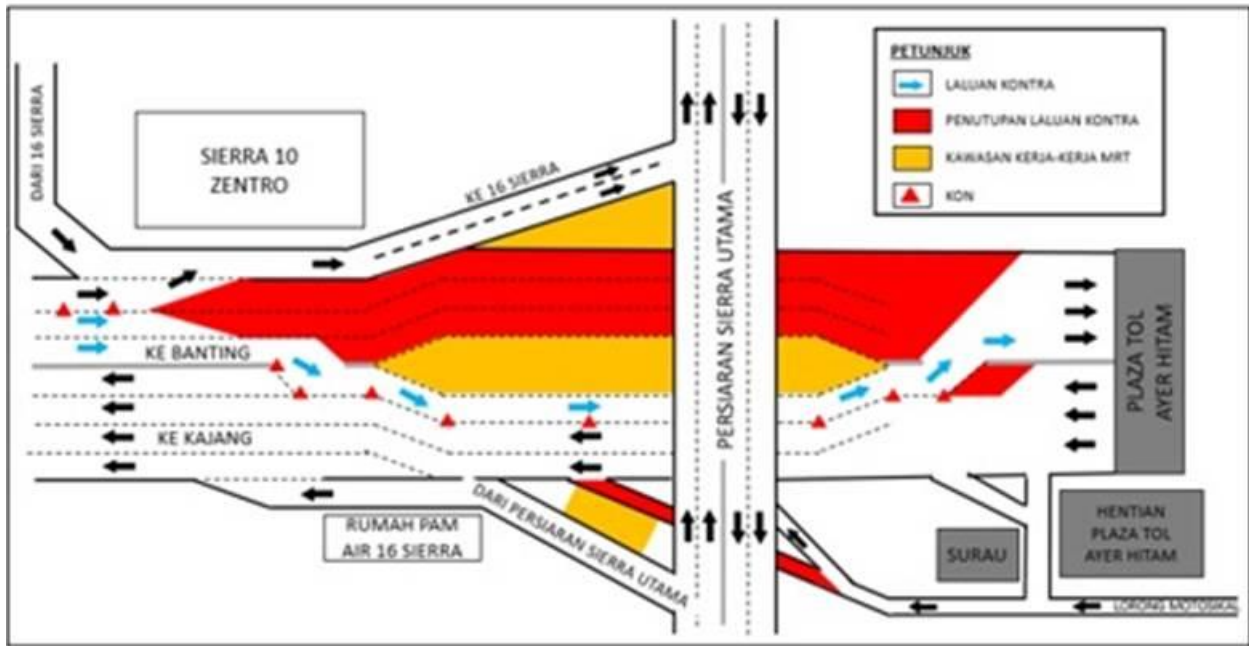

PETA 2 (C): LANJUTAN PENUTUPAN JALAN SECARA BERKALA DAN PENGAKTIFAN LALUAN KONTRA SEPANJANG KM8.9 – KM9.5 LEBUHRAYA SKVE (ARAH BANTING DAN KAJANG)

3. LANJUTAN PENUTUPAN PENUH JALAN SECARA BERKALA DI JALAN IPOH DARI PERODUA HINGGA KE PAPANIC (ARAH KUALA LUMPUR) & DARI UNIVERSAL STUDIO KE WINSIN STATIONARY (ARAH KEPONG)

Tarikh	23 Ogos 2019 – 18 November 2019
Masa	10:00 malam – 6:00 pagi
Jangka masa	3 bulan
Tujuan	Kerja-kerja pembinaan landasan MRT dan sebarang kerja berkaitan

Untuk makluman, penutupan jalan penuh **secara berkala** di Jalan Ipoh dari Perodua ke Papanic (Arah Kuala Lumpur) dan dari Universal Studio ke Winsin Stationary (Arah Kepong) akan dilanjutkan dari **23 Ogos 2019 hingga 18 November 2019**. Tempoh masa untuk kerja- kerja akan bermula dari **10:00 malam – 6:00 pagi selama 3 bulan**.

Semasa penutupan dari Perodua ke Papanic (Arah Kuala Lumpur), pemandu yang ingin ke arah Kuala Lumpur akan dilencongkan ke Jalan Ipoh (Arah Kepong) untuk menggunakan aliran kontra (seperti yang ditunjukkan oleh anak panah **HIJAU** dalam Peta 3 (A)). Manakala, **semasa penutupan dari Universal Studio ke Winsin Stationary (Arah Kepong), pemandu yang ingin ke arah Kepong akan dilencongkan ke Jalan Ipoh (Arah Kuala Lumpur)** untuk menggunakan aliran kontra (seperti yang ditunjukkan oleh anak panah **UNGU** dalam Peta 3 (B)). Penutupan jalan akan dilaksanakan secara berkala dan salah satu lorong untuk setiap arah akan disediakan kepada pengguna jalan raya pada setiap masa.

Pengguna jalan raya dinasihatkan untuk mematuhi arahan papan tanda trafik dan pengawal bendera yang bertugas. Untuk maklumat lanjut, sila rujuk peta di bawah.

3. CONTINUATION OF FULL BOUND CLOSURE INTERMITTENTLY ALONG JALAN IPOH FROM PERODUA TO PAPANIC (KUALA LUMPUR-BOUND) & FROM UNIVERSAL STUDIO TO WINSIN STATIONARY (KEPONG-BOUND)

Date	23 August 2019 – 18 November 2019
Time	10:00pm – 6:00am
Duration	3 months
Reason	To facilitate MRT track works and any other related works.

There will be continuation of full bound closure **intermittently** along Jalan Ipoh from Perodua to Papanic (Kuala Lumpur-bound) and from Universal Studio to Winsin Stationary (Kepong-bound), from **23 August 2019 to 18 November 2019**. Construction works start from **10:00pm to 6:00am for 3 months**.

During the closure from Perodua to Papanic (Kuala Lumpur-bound), motorists who wants to go to Kuala Lumpur-bound will be diverted to Jalan Ipoh (Kepong-bound) and need to use the provided contraflow (as indicated by **GREEN** arrows in the appended Map 3(A)). Meanwhile, **during the closure from Universal Studio to Winsin Stationary (Kepong-bound), motorists who wants to go to Kepong-bound will be diverted to Jalan Ipoh (Kuala Lumpur-bound)** and need to use the provided contraflow (as indicated by **PURPLE** arrows in the appended Map 3 (B)). These closures will be conducted intermittently and at any one time there will be one lane made available for motorists for each bound.

Motorists are advised to follow the traffic signage and flagman during road closure. Please refer to the map below for further information.

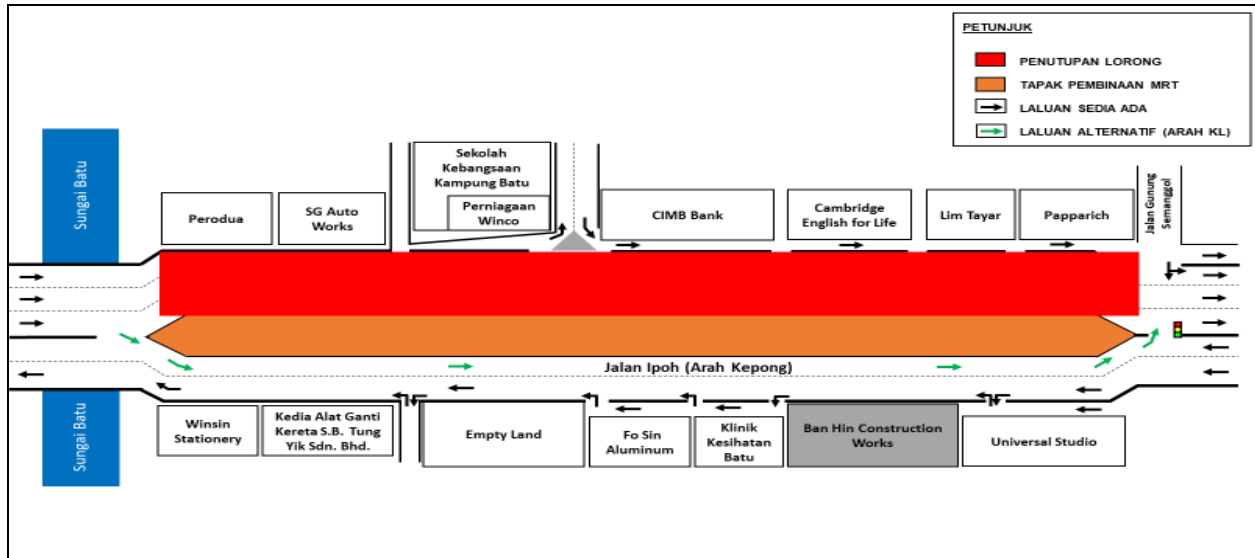

PETA 3 (A): LANJUTAN PENUTUPAN PENUH JALAN SECARA BERKALA DI JALAN IPOH DARI PERODUA HINGGA KE PAPPARICH (ARAH KUALA LUMPUR) & DARI UNIVERSAL STUDIO KE WINSIN STATIONERY (ARAH KEPONG)

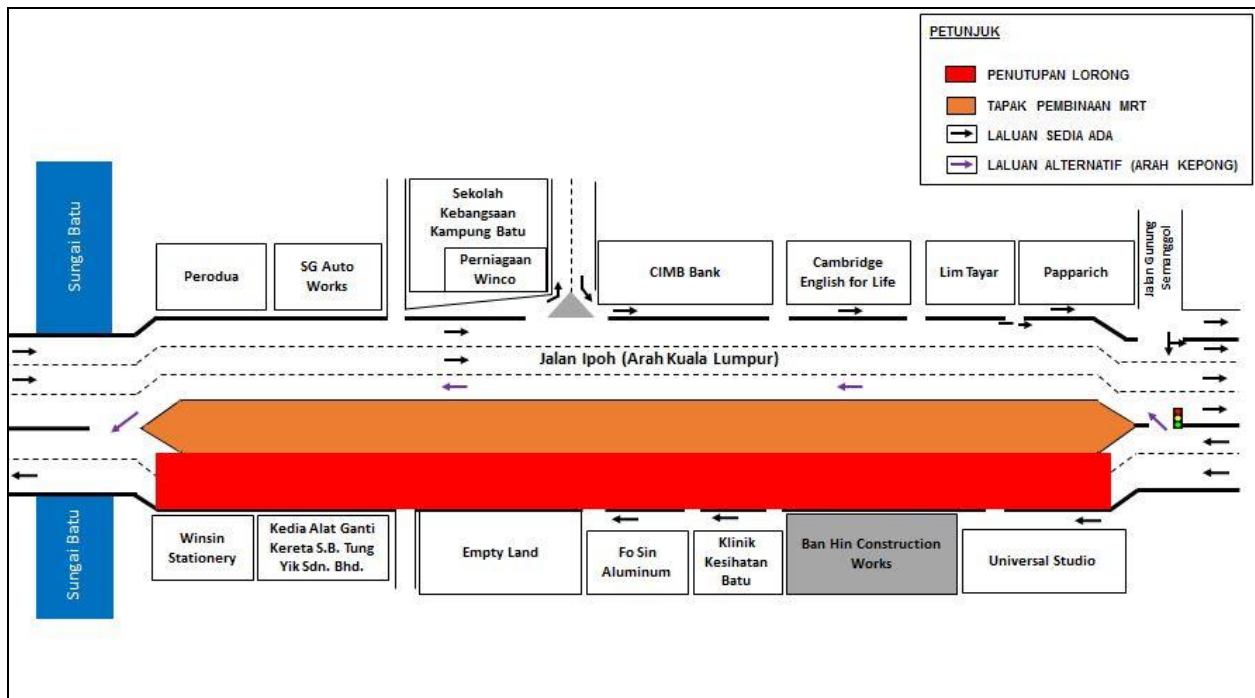

PETA 3 (B): LANJUTAN PENUTUPAN PENUH JALAN SECARA BERKALA DI JALAN IPOH DARI PERODUA HINGGA KE PAPPARICH (ARAH KUALA LUMPUR) & DARI UNIVERSAL STUDIO KE WINSIN STATIONERY (ARAH KEPONG)

4. LANJUTAN PENUTUPAN PENUH LORONG SEPANJANG LEBUHRAYA BESRAYA

Tarikh	23 Ogos 2019 – 31 Ogos 2019
Masa	10:00 malam – 5:00 pagi
Jangka masa	9 hari
Sebab	Untuk menjalankan kerja-kerja pelebaran jalan, kerja premix, menanda jalan, pemasangan konkrit barrier dan sebarang kerja berkaitan.

Untuk makluman, penutupan lorong secara **berkala** di lebuh raya BESRAYA ke arah Pekan Sungai Besi & MRR2 Cheras akan dilanjutkan dari **23 Ogos 2019 hingga 31 Ogos 2019**. Tempoh masa kerja-kerja akan bermula dari **10:00 malam – 5:00 pagi, selama 9 hari**.

KM8.20 (Exit 905) dari Kg. Muhibbah susur keluar ke Pekan Sungai Besi & MRR2 Cheras

Semasa penutupan sepanjang 250-meter ini, kenderaan akan dilencongkan ke laluan alternatif melalui bulatan Lake Field menuju ke Kg. Muhibbah dan keluar semula di susur keluar ke TBS & MRR2 (Exit 906) (seperti ditunjukkan oleh anak panah **HIJAU** dalam peta 4)

Dari Tol BESRAYA (Plaza Tol Mines) ke Pekan Sungai Besi

Semasa penutupan sepanjang 300 meter ini, dua lorong akan ditutup secara berperingkat dan berkala. Pengawal bendera akan mengawal trafik dengan menggunakan kaedah '**Berhenti dan Jalan**'.

Pengguna jalan raya dinasihatkan untuk mematuhi papan tanda trafik dan pengawal bendera yang bertugas. Untuk maklumat lanjut, sila rujuk peta di bawah.

4. CONTINUATION OF FULL LANE CLOSURE ALONG BESRAYA HIGHWAY

Date	23 August 2019 – 31 August 2019
Time	10:00pm – 5:00am
Duration	9 Days
Reason	To facilitate traffic diversion, premix work, road line marking and installation of concrete barrier and other related construction works.

There will be continuation of **intermittent** lane closure at BESRAYA highway towards Pekan Sungai Besi & MRR2 Cheras from **23 August 2019 until 31 August 2019**. Construction works will start from **10:00pm until 5:00am for 9 days**.

KM8.20 (Exit 905) from Kg. Muhibbah to Pekan Sungai Besi

During this 250 metres lane closure, motorists will be diverted to an alternative road via Lake Fields roundabout towards Kg. Muhibbah and exit to TBS and MRR2 (Exit 905) (as indicated by **GREEN** arrows in the map)

From BESRAYA Toll (Mines Toll Plaza) to Pekan Sungai Besi

During this 300 metres lane closure, two lanes will be closed intermittently by stages. Flagmen will be placed to facilitate the traffic flow using "**STOP & GO**" method.

Motorists are advised to follow the traffic signage and flagmen during road closure. Please refer map below for further information.



PETA 4: LANJUTAN PENUTUPAN PENUH LORONG SEPANJANG LEBUHRAYA BESRAYA

For media enquiries, please contact:

Mohd Sofie Hassan **(Item 1)**

Tel: +6019 228 3004

sofie@sunway.com.my

Adeline De Cruz **(Item 2)**

Tel: +6012 217 2017

adeline@acroworks.com.my

Tang Wai Keong **(Item 3)**

Tel: +6013-433 3661

wk.tang@cccc-gk.com

Nor Zamshuri bin Ramli **(Item 4)**

Tel: +6012 607 6268

zamshuritr@gmail.com

Mohar Zainal Abidin **(Item 1 -4)**

Tel: +603 7493 3961

Mohar@mgjv-kvmrt.com.my

MMC GAMUDA KVMRT (PDP SSP) SDN BHD (1117100-V)

Block A, Level 17, Menara Mustapha Kamal, PJ Trade Centre

No 8, Jalan PJU 8/8A, Bandar Damansara Perdana, 47820 Petaling Jaya

Selangor Darul Ehsan, Malaysia

T: +603-7494 2222 F: +603-7727 0222 www.mymrt.com.my