

**PENGUMUMAN TRAFIK  
13 OGOS 2019**

**1. LANJUTAN PENUTUPAN JALAN SECARA BERKALA DAN PENGAKTIFAN LALUAN KONTRA SEPANJANG KM8.9 – KM9.5 LEBUHRAYA SKVE (ARAH BANTING DAN KAJANG)**

<b>Tarikh</b>	15 Ogos 2019 – 19 Ogos 2019
<b>Masa</b>	8.00 pagi – 6.00 petang dan 10.00 malam-6.00 pagi
<b>Jangka masa</b>	5 hari
<b>Tujuan</b>	Untuk kerja-kerja pelaksanaan pelan pengurusan lalu lintas, pelancaran kekotak segmen (SBG) dan sebarang kerja-kerja berkaitan.

Untuk makluman, penutupan jalan **secara berkala** dan pelaksanaan **lalu lintas kontra** sepanjang Lebuhraya SKVE akan dilanjutkan dari **15 Ogos 2019 hingga 19 Ogos 2019**. Tempoh masa untuk kerja-kerja adalah seperti berikut:

- **8.00 pagi-6.00 petang – Penutupan Jalan secara berkala**
- **10.00 malam-6.00 pagi – Penutupan Jalan Penuh dan Pengaktifan Laluan Kontra.**

Pelan pengurusan trafik adalah seperti berikut:

**PETA 1 (Penutupan A):** Semasa penutupan lorong paling kanan di kedua-dua arah sepanjang 600 meter. Penutupan ini akan dilaksanakan untuk salah satu arah pada satu masa dan dua (2) lorong masih dibuka untuk pengguna jalan raya.

**Penutupan B:** Semasa penutupan lorong paling kanan sepanjang 150 meter di jalan susur menghala ke Persiaran Sierra Utama. Semasa penutupan di susur kiri ke Persiaran Sierra Utama, lorong kiri masih boleh digunakan oleh pengguna jalan raya.

**PETA 2:** Semasa Penutupan penuh jalan sepanjang 300 meter dari persimpangan Hentian Plaza Tol Ayer Hitam sehingga Rumah Pam Air 16 Sierra (Arah Kajang). Pengguna jalan raya yang menghala ke arah Kajang dinasihatkan untuk menggunakan laluan bertentangan (Arah Banting) di Lebuhraya SKVE.

**PETA 3:** Semasa penutupan penuh jalan sepanjang 300 meter sebelum persimpangan ke Persiaran Sierra Utama sehingga sebelum Plaza Tol Ayer Hitam (Arah Banting), pengguna jalan raya yang menghala ke arah Kajang dinasihatkan untuk menggunakan laluan bertentangan (Arah Kajang) di Lebuhraya SKVE.

Pengguna jalan raya dinasihatkan untuk mematuhi arahan papan tanda trafik dan Pengawal bendera yang bertugas. Untuk maklumat lanjut, Sila rujuk peta dibawah.

## 1. CONTINUATION OF INTERMITTENT LANE CLOSURES AND ACTIVATION OF CONTRA-FLOW ALONG KM8.9 – KM9.5 SKVE HIGHWAY (BANTING AND KAJANG BOUND)

<b>Date</b>	15 August 2019 - 19 August 2019
<b>Time</b>	8.00am-6.00pm and 10.00pm-6.00am
<b>Duration</b>	5 days
<b>Reason</b>	To facilitate implementation of traffic management plan, Segmental Box Girder (SBG) launching works and any other related works.

There will be continuation of **intermittent** full bound closures and activation of **contra flow** along SKVE Highway from **15 August 2019 – 19 August 2019**. Construction works will start from:

- **8.00am-6.00pm – Intermittent Lane Closure.**
- **10.00pm-6.00am – Full Bound Closure & Activation of Contraflow.**

The traffic management plan as below:

**MAP 1:** (Closure A): During this closure the right-most lane will be closed for a stretch approximately 600 meters for both bounds. This closure will be activated at one time on either bound, while two (2) lanes will be available for motorists.

**Closure B:** During this closure the right-most lane will be closed for a stretch of approximately 150 meters along SKVE ramp heading to Persiaran Sierra Utama, while one (1) lane will be available for motorists at the ramp.

**MAP 2:** During this full bound closure the lanes will be closed for a stretch of 300 meters from the junction of Hentian Plaza Tol Ayer Hitam until Pump House 16 Sierra towards Kajang, while the motorists will be directed to opposite bound (Banting bound) at SKVE highway.

**MAP 3:** During this full bound closure the lanes will be closed for a stretch of 300 meters from slip road to Persiaran Sierra Utama until before Plaza Tol Ayer Hitam towards Banting, while motorists will be directed to the opposite bound (Kajang bound) at SKVE highway.

Motorists are advised to follow the traffic signage and flagmen during road closure. Please refer map below for further information.

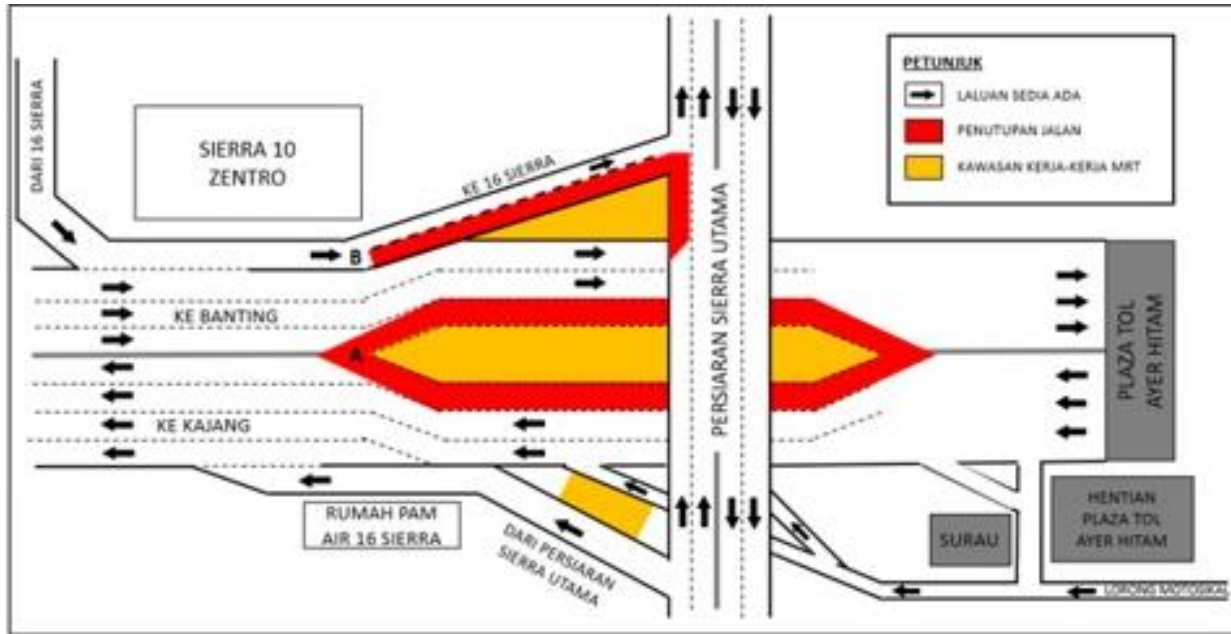

**PETA 1: PENUTUPAN JALAN SECARA BERKALA DI KM8.9 LEBUHRAYA SKVE (ARAH BANTING DAN KAJANG)**

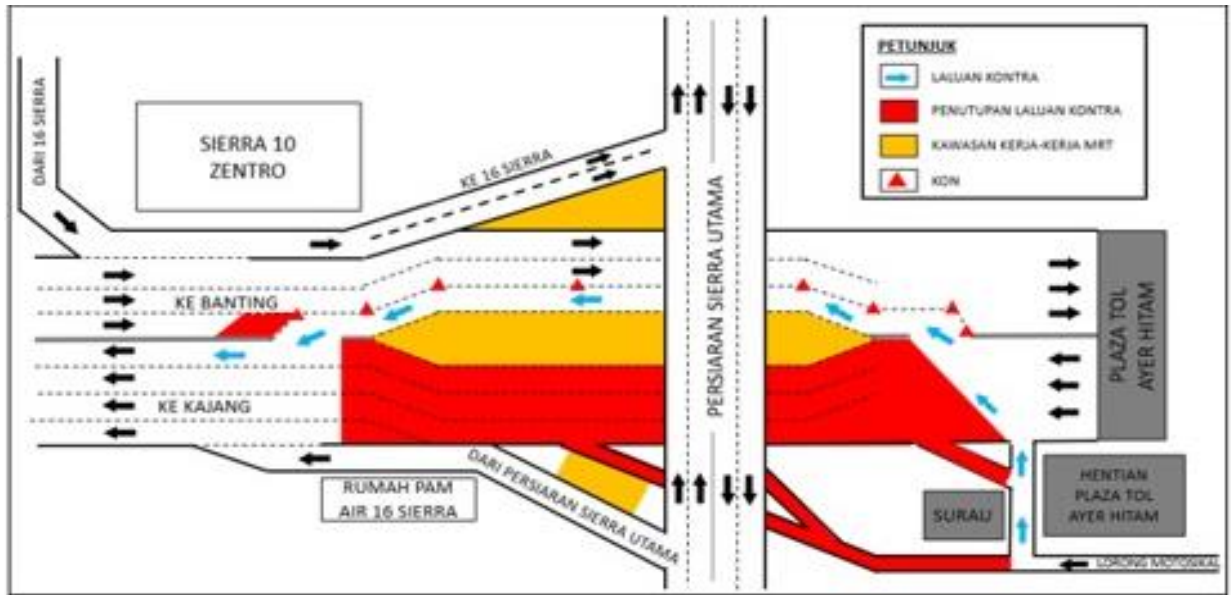

**PETA 2: PENUTUPAN PENUH JALAN DAN PENGAKTIFAN LALUAN KONTRA (ARAH KAJANG)**

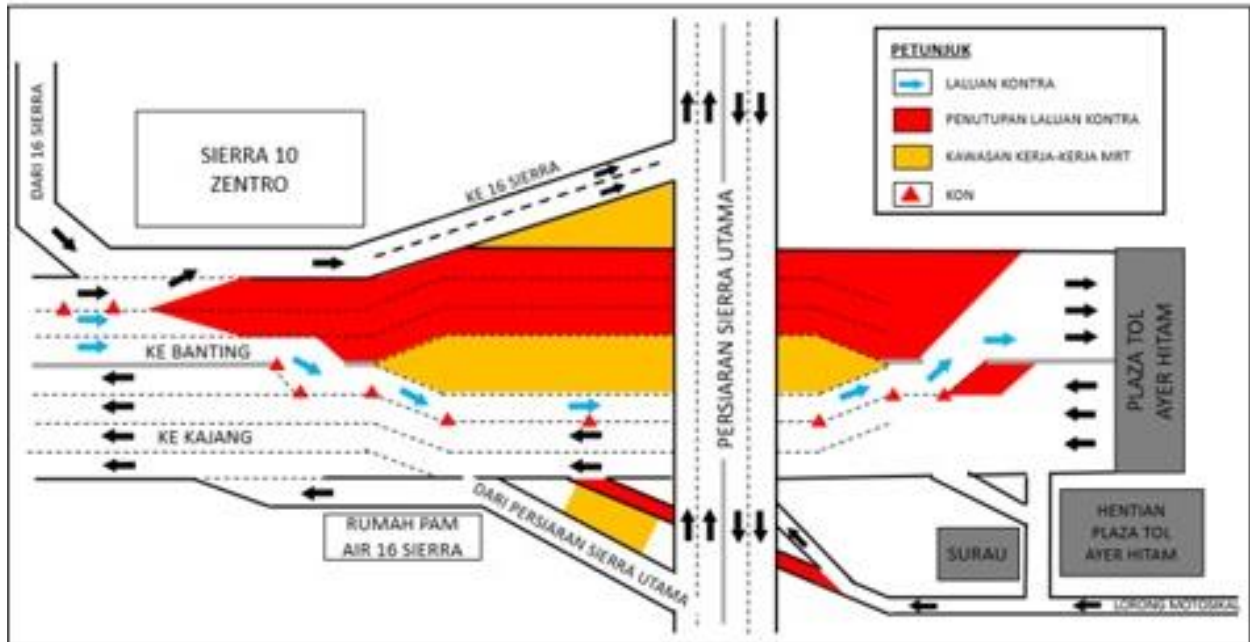

**PETA 3: PENUTUPAN PENUH JALAN DAN PENGAKTIFAN LALUAN KONTRA (ARAH BANTING)**

## 2. LANJUTAN PENUTUPAN JALAN DAN PENGAKTIFAN LALUAN KONTRA SEPANJANG LEBUHRAYA MEX DI KM23.1-KM24.1 (ARAH KUALA LUMPUR DAN PUTRAJAYA)

<b>Tarikh</b>	15 Ogos 2019 - 09 September 2019
<b>Masa</b>	11.00 malam-5.00 pagi
<b>Jangka masa</b>	26 hari
<b>Tujuan</b>	Untuk kerja-kerja pelaksanaan pelan pengurusan lalu lintas, pelancaran kekotak segmen (SBG) dan sebarang kerja-kerja berkaitan..

Untuk makluman, penutupan jalan **secara berkala** dan pengaktifan **laluhan kontra** sepanjang Lebuhraya MEX di KM23.1 – KM24.1 akan dilanjutkan dari **15 Ogos 2019 hingga 09 September 2019**. Tempoh masa untuk kerja-kerja akan bermula dari **11.00 malam-5.00 pagi selama 26 hari**. Pelan pengurusan trafik adalah seperti berikut:

**PETA 4 (Penutupan A dan B):** Semasa penutupan lorong paling kiri sepanjang 500 meter untuk kedua-dua arah Lebuhraya MEX. Penutupan ini akan dilaksanakan untuk salah satu arah pada satu masa dan dua (2) lorong masih dibuka untuk pengguna jalan raya.

**Penutupan C:** Semasa penutupan lorong paling kanan sepanjang 500 meter (Arah Kuala Lumpur dan Putrajaya), lorong tengah dan lorong kanan masih dibuka untuk pengguna jalan raya bagi kedua-dua arah.

**PETA 5:** Semasa penutupan lorong kiri dan lorong tengah sepanjang 500 meter, Penutupan ini akan dilaksanakan untuk salah satu arah pada satu masa dan lorong paling kanan masih dibuka untuk pengguna jalan raya.

**PETA 6:** Semasa penutupan laluan tengah dan laluan paling kanan sepanjang 500 meter di lebuhraya MEX, salah satu arah pada satu masa dan lorong paling kiri masih dibuka untuk pengguna untuk salah satu arah.

**PETA 7:** Semasa penutupan penuh jalan ke arah Kuala Lumpur sepanjang 800 meter selepas Plaza Tol Putrajaya (Arah Kuala Lumpur), pengguna jalan raya akan dilencongkan ke laluan bertentangan (Arah Putrajaya).

**PETA 8:** Semasa penutupan penuh jalan ke arah Putrajaya sepanjang 800 meter di lebuhraya MEX (Arah Putrajaya), pengguna jalan raya akan dilencongkan ke laluan bertentangan (Arah Kuala Lumpur).

Pengguna jalan raya dinasihatkan untuk mematuhi papan tanda arah trafik dan pengawal bendera yang bertugas. Untuk maklumat lanjut, Sila rujuk peta dibawah.

## 2. CONTINUATION OF INTERMITTENT ROAD CLOSURE AND ACTIVATION OF CONTRA-FLOW ALONG MEX HIGHWAY FROM KM23.1 - KM24.1 (KUALA LUMPUR AND PUTRAJAYA BOUND)

<b>Date</b>	15 August 2019 - 09 September 2019
<b>Time</b>	11.00 pm - 5.00 am
<b>Duration</b>	26 days
<b>Reason</b>	To facilitate implementation of traffic management plan, Segmental Box Girder (SBG) launching works and any other related works.

There will be continuation of **intermittent** road closures and activation of **contra-flow** along KM23.1-KM24.1 MEX Highway from **15 August 2019 – 09 September 2019**. Construction works will start from **11.00 pm - 5.00 am for 26 days**. Traffic management plan as below:

**MAP 4: Closure A & B:** During this closure, the left lane will be closed for a stretch of 500 meters along KM23.1-KM24.1 MEX Highway. This closure will be activated at one time on either bound, while two (2) lanes will be made available for motorists.

**Closure C:** During this closure, the right-most lane will be closed for a stretch of 500 meters for both bounds (Kuala Lumpur and Putrajaya bound), while the two (2) lanes will be made available for motorists on both bounds.

**MAP 5:** During this closure, the left-most lane and middle lane will be closed for a stretch of 500 meters. This closure will be activated at one time either bound, while one (1) lane will be made available for motorists on either bound.

**MAP 6:** During this closure the middle lane and right-most lane will be closed for a stretch of 500 meters. This closure will be activated at one time either bounds, while one (1) lane will be made available for motorists on either bound.

**MAP 7:** During this full bound closure, the lanes will be closed for a stretch of 800 meters after Plaza Tol Putrajaya towards Kuala Lumpur, while motorists will be directed to the opposite bound (Putrajaya bound).

**MAP 8:** During this full bound closure, the lanes will be closed for a stretch of 800 meters before Plaza Tol Putrajaya towards Putrajaya, while motorists will be directed to the opposite bound (Kuala Lumpur bound).

Motorists are advised to follow the traffic signage and flagmen during road closure. Please refer map below for further information.

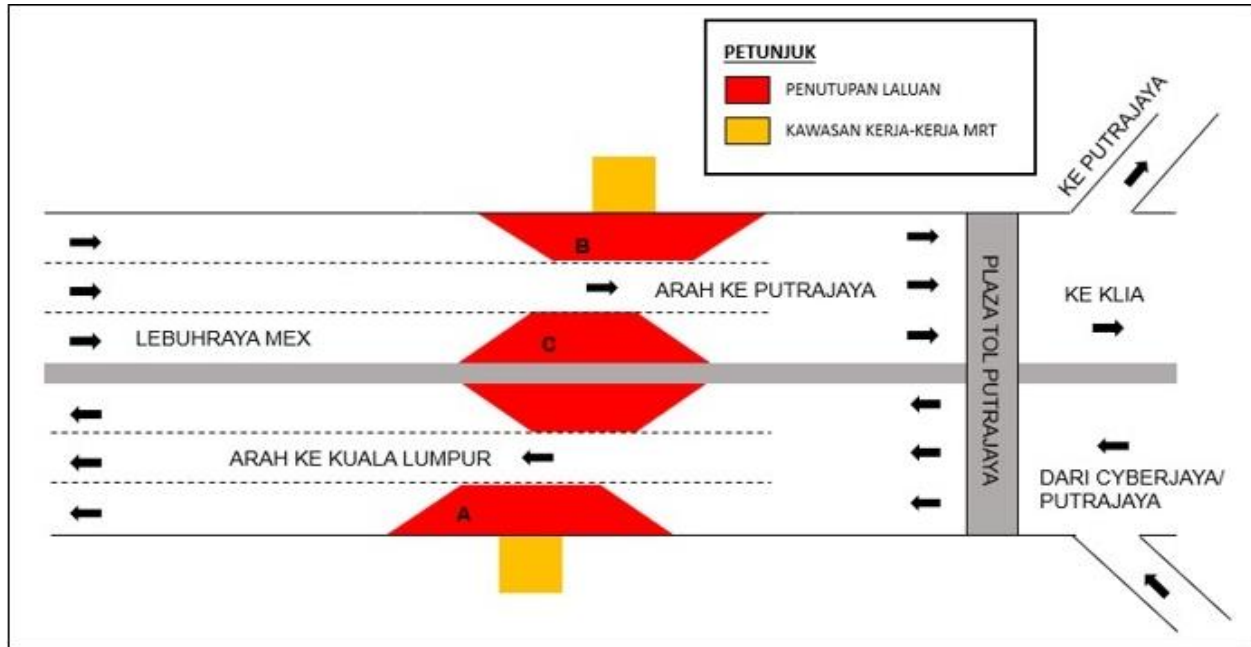

**PETA 4: PENUTUPAN JALAN SEPANJANG LEBUHRAYA MEX DI KM23.1 – KM24.1 (ARAH KUALA LUMPUR DAN PUTRAJAYA)**

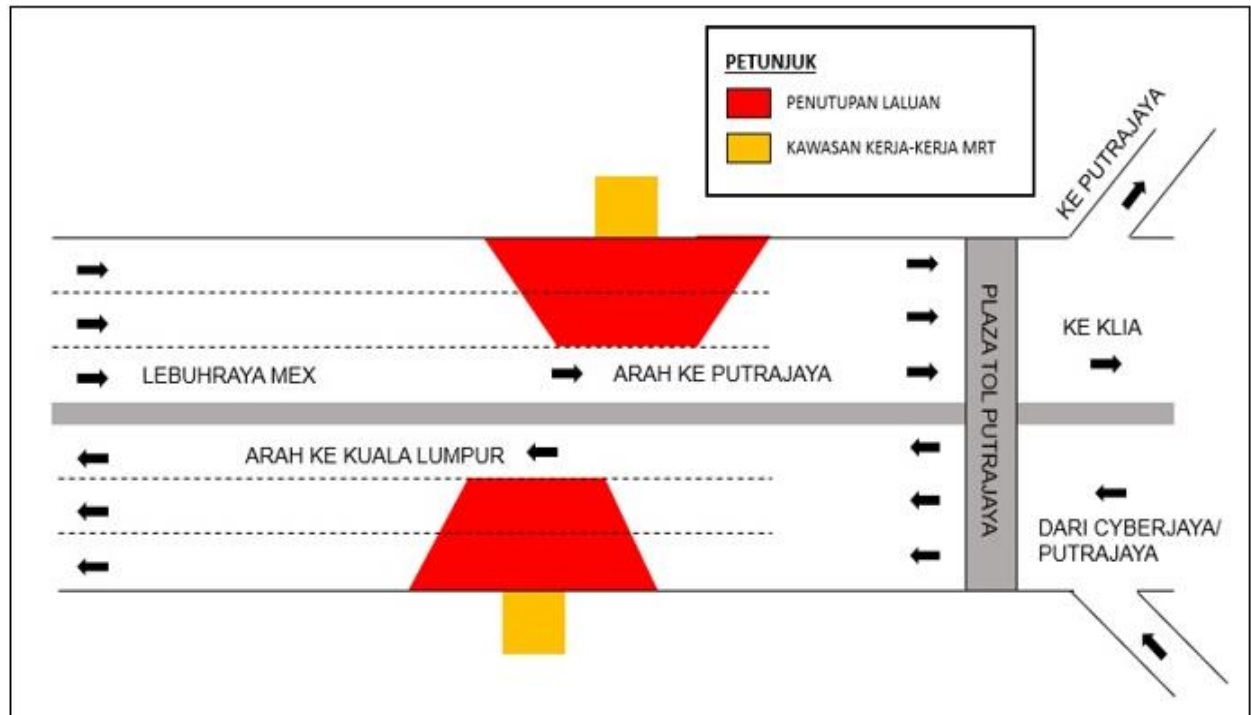

**PETA 5: PENUTUPAN JALAN SEPANJANG LEBUHRAYA MEX DI KM23.1 – KM24.1 (ARAH KUALA LUMPUR DAN PUTRAJAYA)**

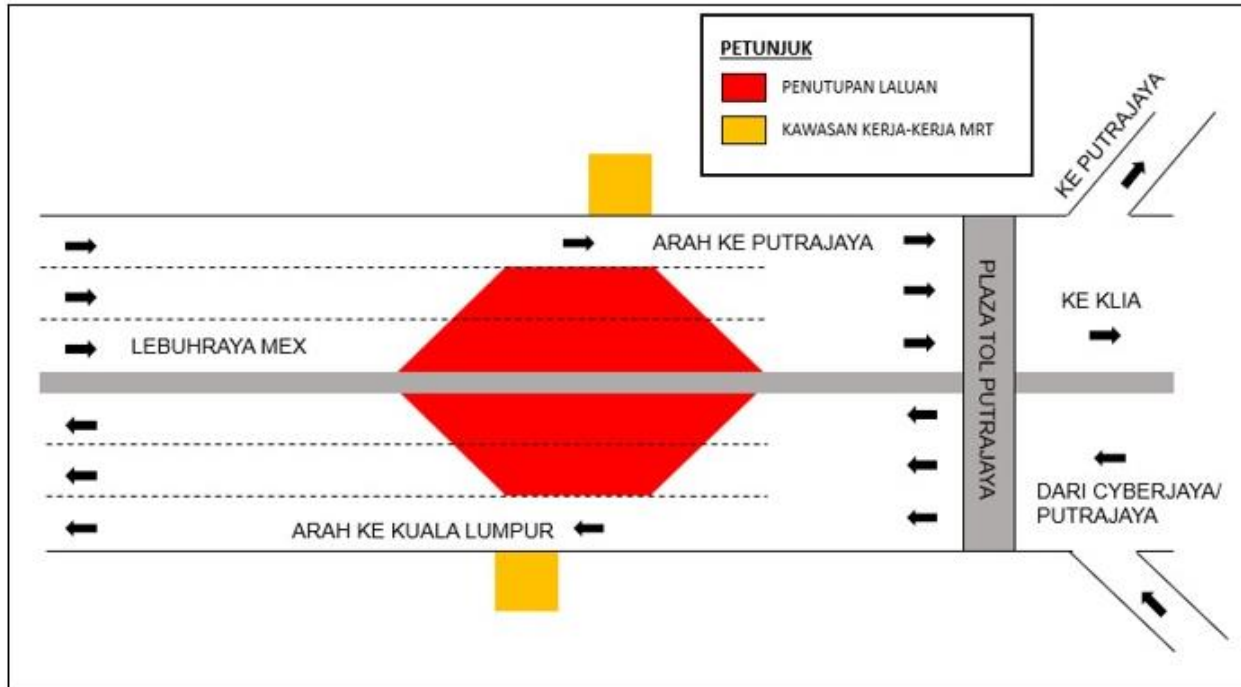

**PETA 6: PENUTUPAN JALAN SEPANJANG LEBUHRAYA MEX DI KM23.1 – KM24.1 (ARAH KUALA LUMPUR DAN PUTRAJAYA)**

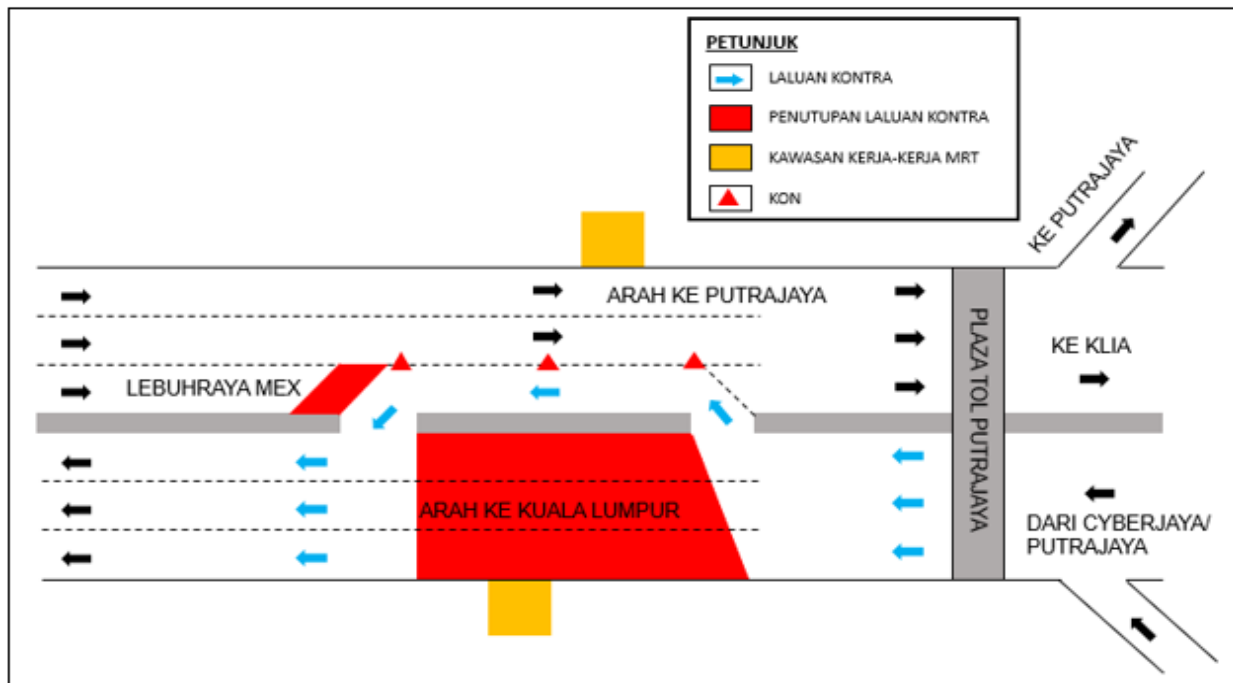

**PETA 7: PENUTUPAN PENUH SECARA BERKALA DAN PERLAKSANAAN LALUAN KONTRA SEPANJANG LEBUHRAYA MEX DI KM23.1 - KM24.1 (ARAH KUALA LUMPUR DAN PUTRAJAYA)**



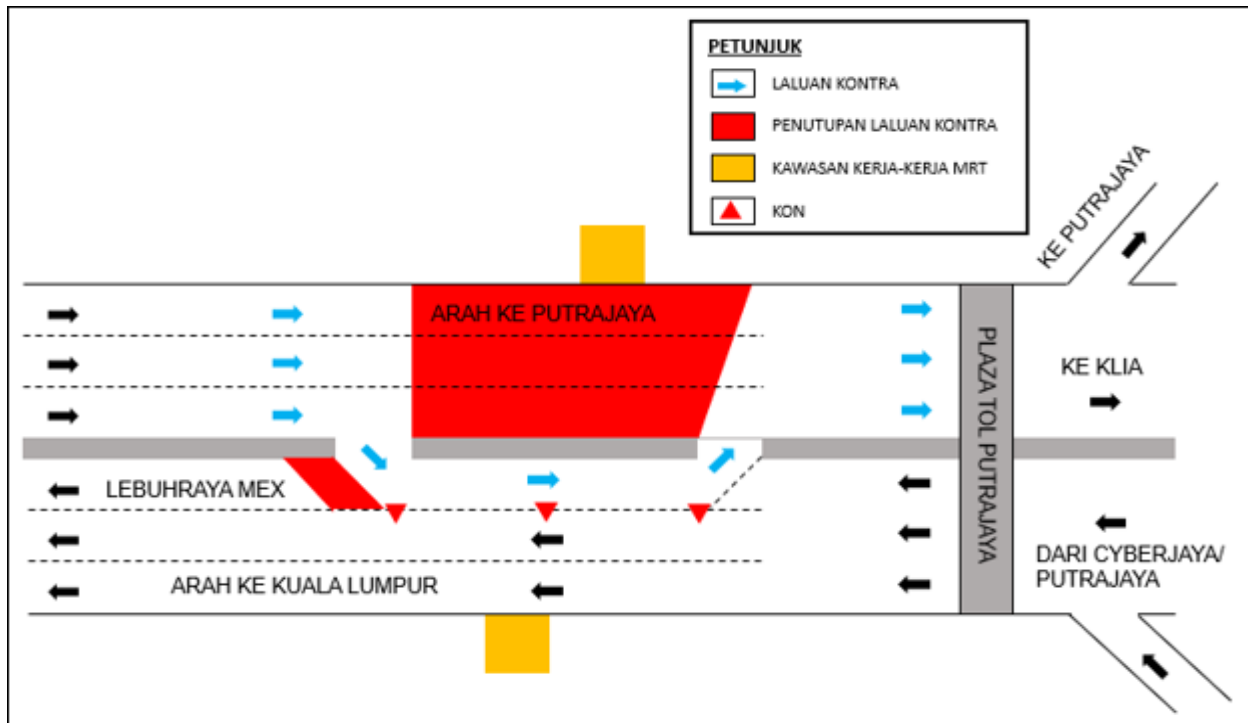

**PETA 8: PENUTUPAN SECARA BERKALA DAN PERLAKSANAAN LALUAN KONTRA SEPANJANG LEBUHRAYA MEX KM23.1 - KM24.1 (ARAH KUALA LUMPUR DAN PUTRAJAYA)**

**For media enquiries, please contact:**

Adeline De Cruz  
Mohar Zainal Abidin

Tel: +6012 217 2017  
Tel: +603 7493 3832

adeline@acroworks.com.my  
Mohar@mgjv-kvmrt.com.my

**MMC GAMUDA KVMRT (PDP SSP) SDN BHD (1117100-V)**  
Block A, Level 17, Menara Mustapha Kamal, PJ Trade Centre  
No 8, Jalan PJU 8/8A, Bandar Damansara Perdana, 47820 Petaling Jaya  
Selangor Darul Ehsan, Malaysia  
T: +603-7494 2222 F: +603-7727 0222 [www.mymrt.com.my](http://www.mymrt.com.my)