

PENGUMUMAN TRAFIK**MAKLUMAN TERKINI PELAN PENGURUSAN TRAFIK UNTUK PEMBINAAN MRT SSP SEPANJANG SERI KEMBANGAN, SERDANG RAYA, JALAN PUTRA PERMAI & BANDAR 16 SIERRA
21 OGOS 2018****1. LANJUTAN PENUTUPAN DI JALAN PINGGIRAN 1/3**

Tarikh	23 Ogos 2018 - 30 Ogos 2018
Masa	11.00 malam - 5.00 pagi
Jangka masa	1 Minggu
Sebab	Untuk kerja-kerja pelancaran 'U Beam' dan kerja-kerja yang berkaitan dengan MRT

Untuk makluman, penutupan penuh di Jalan Pinggiran 1/3 akan dilanjutkan dari 23 Ogos 2018 - 30 Ogos 2018. Jangka masa untuk kerja-kerja akan bermula dari 11.00 malam hingga 5.00 pagi.

Semasa penutupan, pengguna jalan raya dinasihatkan untuk menggunakan jalan lencongan seperti peta di bawah.

Pengguna jalan raya dinasihatkan untuk mematuhi arahan papan tanda trafik dan pengawal bendera yang bertugas

1. CONTINUATION OF LANE CLOSURE AT JALAN PINGGIRAN 1/3

Date	23 August 2018 - 30 August 2018
Time	11:00 pm – 5:00 am
Duration	1 Week
Reason	To facilitate launching of U Beam works and any other related works

A full lane closure on Jalan Pinggiran 1/3 will continue from 23 August 2018 - 30 August 2018. Duration of works will be from 11:00pm to 5:00am.

During the closure, motorists are advised to follow the road diversion shown in the map below.

Motorists are advised to follow the traffic signage and flagman during road closure

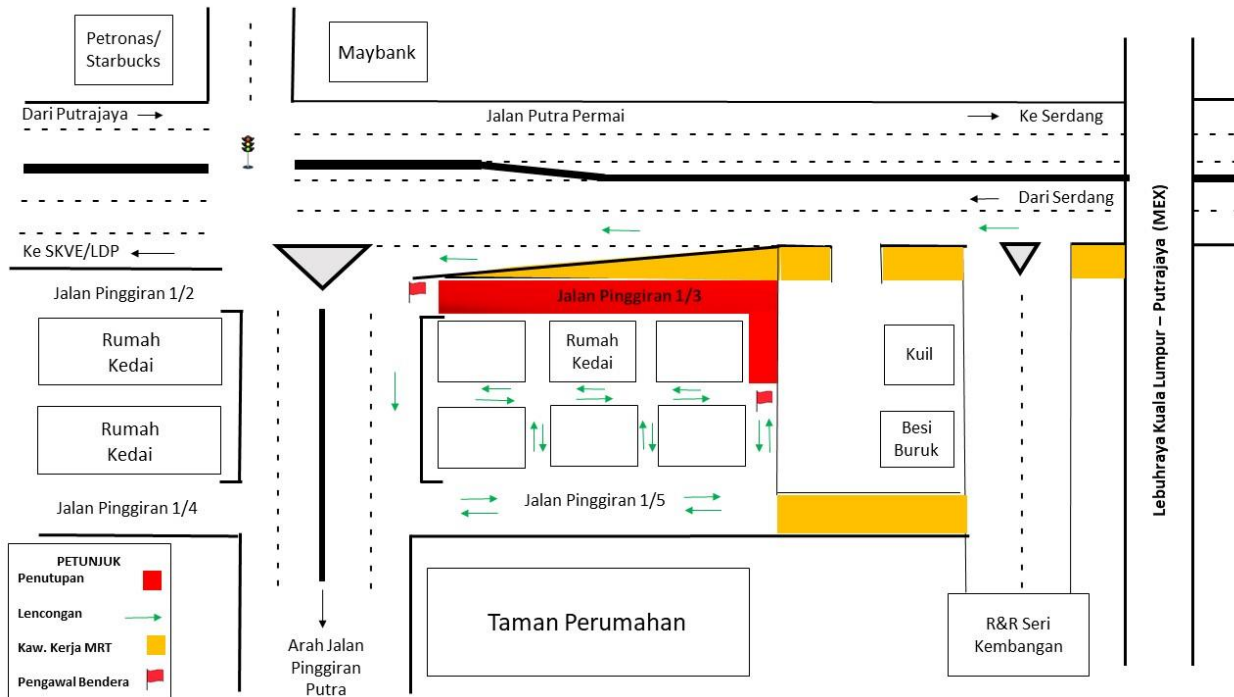

2. LANJUTAN PENUTUPAN SATU LORONG DI JALAN UTAMA

Tarikh	23 Ogos 2018 - 30 September 2018
Masa	24 Jam
Jangka masa	1 Bulan
Sebab	Bagi melakukan kerja-kerja penyiasatan tanah

Harap maklum lanjutan penutupan satu lorong di Jalan Utama, Serdang Raya bermula pada **23 Ogos 2018 hingga 30 September 2018, 24 jam.**

Penutupan terbahagi kepada dua:

Penutupan 1: Penutupan lorong kanan dikedua-dua arah di hadapan Petron Sri Kembangan 3 sehingga flat 5 tingkat, Taman Serdang Raya 1. Sepanjang penutupan ini, satu lorong akan dibuka kepada pengguna jalan raya.

Penutupan 2: Penutupan lorong perlahan di Jalan Besar arah Seri Kembangan. Sepanjang penutupan ini, dua lorong akan dibuka kepada pengguna jalan raya.

Pengguna jalan raya dinasihatkan untuk mematuhi arahan papan tanda trafik dan pengawal bendera yang bertugas.

Sila rujuk peta.

2. CONTINUATION OF ONE LANE CLOSURE AT JALAN UTAMA

Date	23 August 2018 - 30 September 2018
Time	24 hours
Duration	1 month
Reason	To facilitate soil investigation and other related works.

There will be continuation of one lane closure at Jalan Utama starting **23 August 2018 until 30 September 2018, 24 hours.**

The closure will be divided into two:

Closure 1: Right lane closure both bound in front of Petron Sri Kembangan 3 until 5 storey flat, Taman Serdang Raya 1. During this closure one lane will be available for motorist on both bound.

Closure 2: Slow lane closure on Jalan Besar, Seri Kembangan bound. During this closure two lanes will be available for motorist.

Motorists are advised to comply with traffic signs and flagman instructions.

Please refer map.

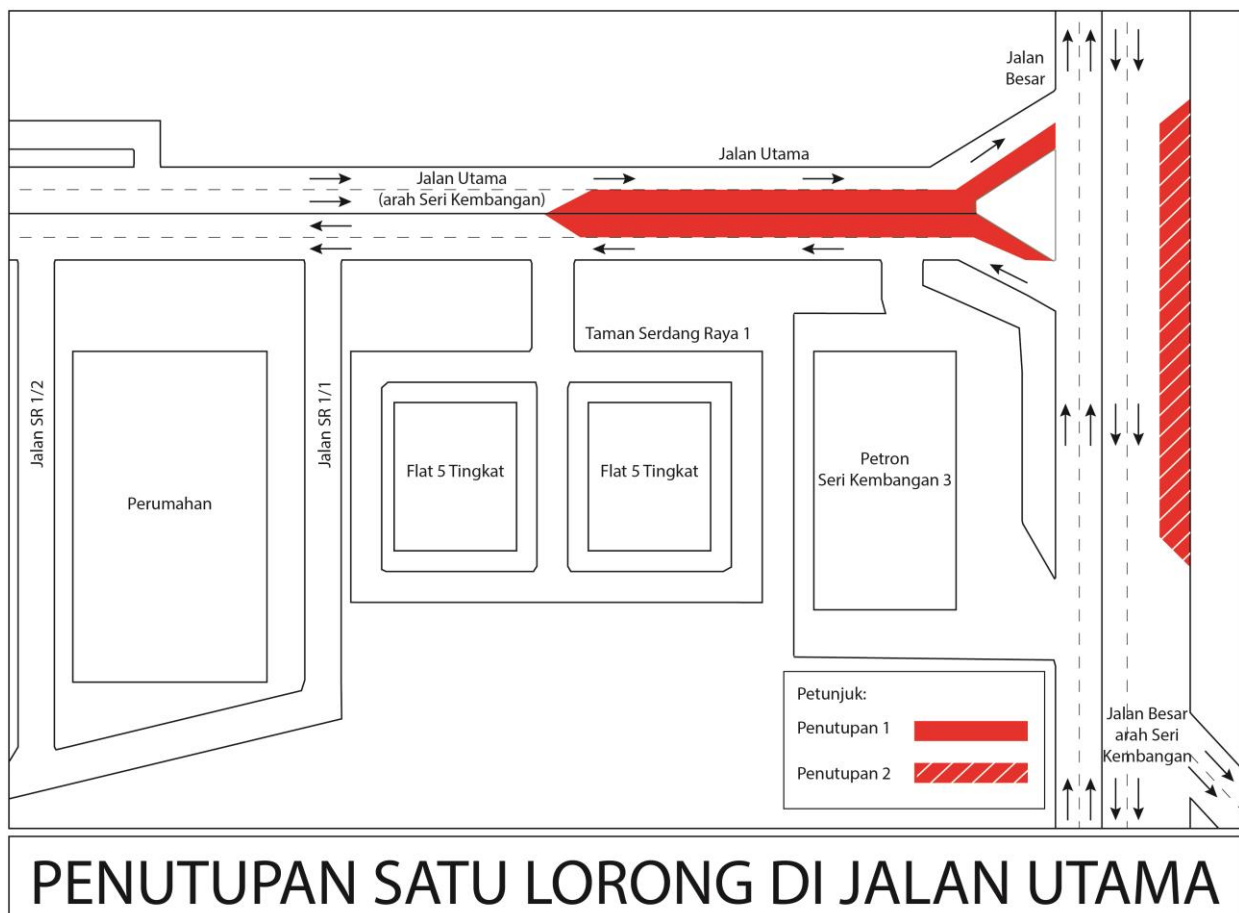

3. LANJUTAN PENUTUPAN JALAN DI JALAN PUTRA PERMAI (ARAH KE PUCHONG & SERDANG)

Tarikh	23 Ogos 2018 - 22 November 2018
Masa	24 Jam
Jangka masa	90 Hari
Sebab	Untuk kerja - kerja pemetaan, pengesanan awal, pemindahan utiliti, pembinaan cerucuk dan sebarang kerja berkaitan

Harap maklum penutupan lorong di Jalan Putra Permai (arah ke Puchong dan Serdang) akan bermula pada **23 Ogos 2018 hingga 22 November 2018**.

Sila rujuk peta:

Kawasan 1:

Semasa penutupan jalan, lorong tengah dan lorong paling kanan akan disediakan bagi pengguna jalan raya dari Jalan Putra Permai dan Jalan Prima Tropika (arah ke Puchong)

Kawasan 2:

Semasa penutupan berkala di jalan susur, separuh jalan susur akan disediakan bagi pengguna jalan raya dari Jalan Putra Permai menghala ke Jalan Persiaran Lestari Perdana.

Kawasan 3:

Semasa penutupan jalan, lorong tengah dan lorong paling kanan akan disediakan bagi pengguna jalan raya dari Jalan Putra Permai dan Jalan Prima Tropika (arah ke Serdang)

3. CONTINUATION OF LANE CLOSURE AT JALAN PUTRA PERMAI (PUCHONG AND SERDANG BOUND)

Date	23 August 2018 - 22 November 2018
Time	24 hours
Duration	90 days
Reason	To facilitate mapping, utilities relocation, pier construction works and any other related works

There will be a lane closure at Jalan Putra Permai (Puchong and Serdang bound) from **23 August 2018 to 22 November 2018**.

The closure will done as follows (please refer to map):

Area 1:

During the lane closure, the middle and the right-most lane will be made available for motorist from Jalan Putra Permai and Jalan Prima Tropika (Puchong Bound).

Area 2:

During the intermittent slip road closure, half of the slip road will be made available for motorist from Jalan Putra Permai heading towards Jalan Persiaran Lestari Perdana.

Area 3:

During the lane closure, the middle and the right-most lane will be made available for motorist from Jalan Putra Permai and Jalan Prima Tropika (Serdang Bound).

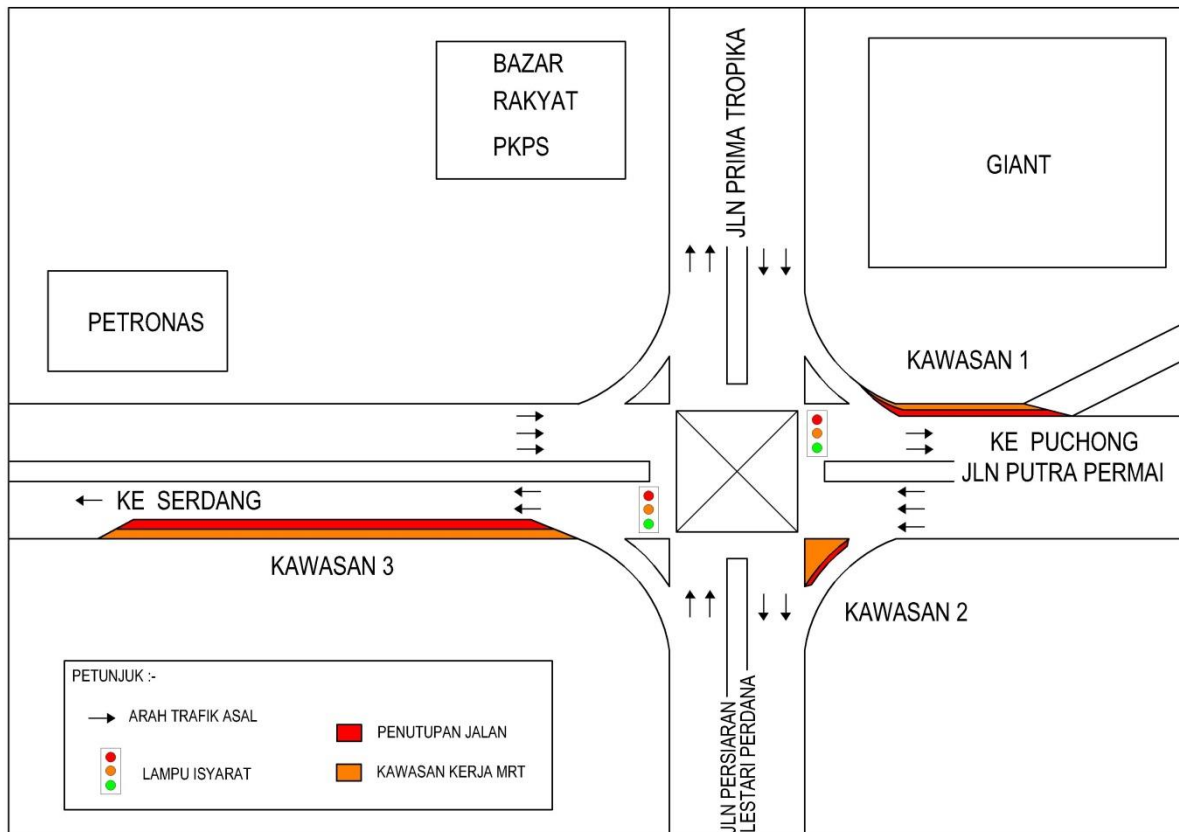

4. PELAKSANAAN LALUAN KONTRA SEPANJANG PERSIARAN ALPINIA DAN PERSIARAN SIERRA

Tarikh	23 Ogos 2018 - 14 Mac 2019
Masa	10.00malam-5.00pagi
Jangka masa	7 bulan
Sebab	Untuk kerja-kerja pelaksanaan Pelan Pengurusan Lalu Lintas, pengalihan jentera, pembinaan portal pier, pelancaran galang kekotak berseghmen dan sebarang kerja berkaitan.

Harap maklum pelaksanaan laluan kontra sepanjang Persiaran Alpina dan Persiaran Sierra Utama akan bermula dari **23 Ogos 2018 hingga 14 Mac 2019**. Jangka masa untuk kerja-kerja akan bermula dari **10.00malam-5.00pagi**. Laluan kontra akan dilaksanakan secara berkala di antara Peta A atau Peta B (Sila rujuk peta).

Semasa laluan kontra, laluan menghala ke Sierra 16 akan ditutup dan pengguna jalan raya akan dilencongkan ke laluan bertentangan (hala ke Seri Kembangan/ KL). Pengguna jalan raya masih mempunyai satu lorong untuk kedua-dua arah.

PETA A: Bermula daripada simpang D’Alpinia Urbana sehingga simpang jalan susur ke SKVE sepanjang 350 meter dan bermula daripada simpang Jalan Sierra Utama 2 sehingga simpang ke Amigo Clubhouse sepanjang 350 meter (Sila rujuk PETA A).

PETA B: Bermula daripada kedua-dua simpang SKVE sepanjang 150 meter; Bermula daripada simpang Jalan Sierra Utama 2 sehingga simpang jalan susur daripada SKVE sepanjang 300 meter. (Sila rujuk PETA B)

4. ACTIVATION OF CONTRA-FLOW BY STAGES ALONG PERSIARA ALPINIA AND PERSIARAN

Date	23 August 2018 – 14 March 2019
Time	10.00pm-5.00am
Duration	7 months
Reason	To facilitate implementation of Traffic Management Plan, machines relocation, pier construction works, launching of segmented box girder and any other related works.

There will be an activation of contra-flow along Persiaran Alpinia and Persiaran Sierra Utama starts from **23 August 2018 – 14 March 2019**. Duration of works will be from **10.00pm-5.00am**. The contra-flow will be implemented intermittently based on MAP A or MAP B (See map appended).

During contra-flow, the 16 Sierra bound will be closed and motorists will be directed to opposite bound (Seri Kembangan/ KL Bound). Motorists will have at least one lane available in each direction.

MAP A: Starting from the junction of D’Alpinia Urbana until the ramp to SKVE for a stretch of 350 metres; Starting from the junction of Jalan Sierra Utama 2 until the junction to Amigo Clubhouse for a stretch of 350 metres. (See MAP A appended)

MAP B: Starting from between the two SKVE junctions for a stretch of 150 metres; Starting from the junction of Jalan Sierra Utama 2 until ramp from SKVE for a stretch of 300 metres. (See MAP B appended)

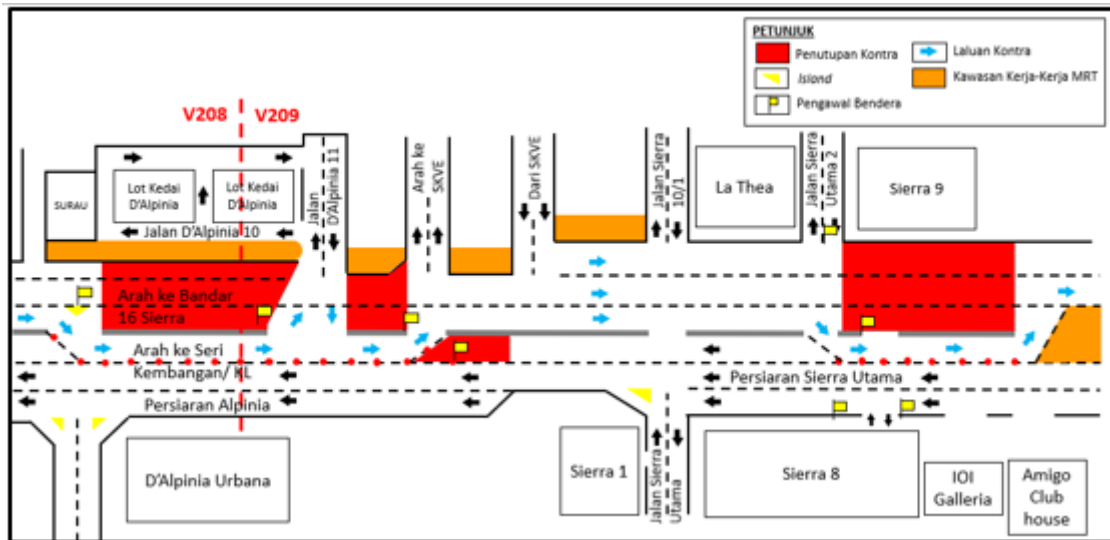

PETA A: PELAKSANAAN LALUAN KONTRA SEPANJANG PERSIARAN ALPINIA DAN PERSIARAN SIERRA UTAMA

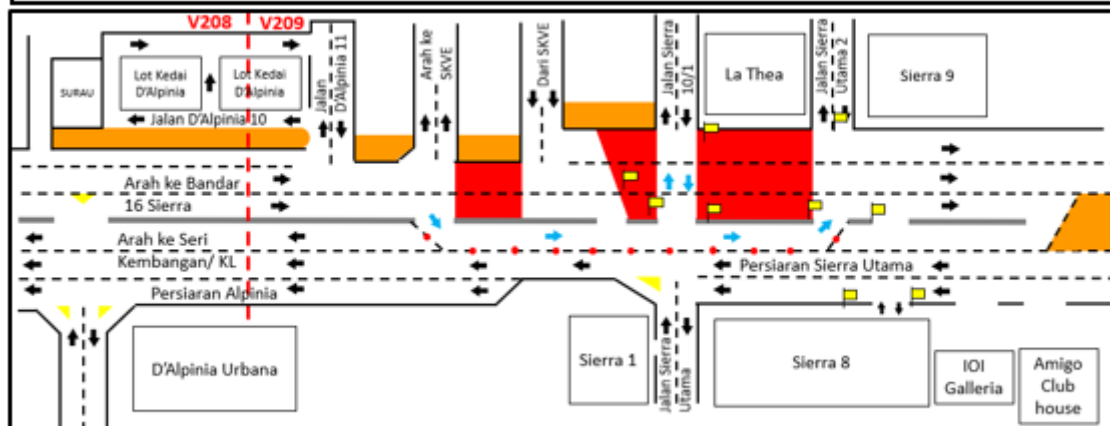

PETA B: PELAKSANAAN LALUAN KONTRA SEPANJANG PERSIARAN ALPINIA DAN PERSIARAN SIERRA UTAMA

For media enquiries, please contact:

- | | | |
|---------------------------------|-----------------------|------------------------------------------------------------------------|
| Item 1: Nishaline Pubalan | Tel: +6011 5185 8248 | nishaline.pubalan@mudajaya.com |
| Item 2: Juliana J. Tan | Tel: +6019 - 355 8322 | juliana@gadang.com.my |
| Item 3: Mohd Lotfi Abdul Latiff | Tel: +6012 2100 766 | Mlotfi@V208.com.my |
| Item 4: Adeline Cruz | Tel: +60 12-217 2017 | adeline@acroworks.com.my |
| Leanne Susau | Tel: +603 7493 3832 | leanne@mgjv-kvmrt.com.my |

MMC GAMUDA KVMRT (PDP SSP) SDN BHD (1117100-V)
 Block A, Level 17, Menara Mustapha Kamal, PJ Trade Centre
 No 8, Jalan PJU 8/8A, Bandar Damansara Perdana, 47820 Petaling Jaya
 Selangor Darul Ehsan, Malaysia

T: +603-7494 2222 F: +603-7727 0222 <http://www.mymrt.com.my>