

**PENGUMUMAN TRAFIK  
MAKLUMAN TERKINI PELAN PENGURUSAN TRAFIK UNTUK PEMBINAAN MRT SSP SEPANJANG  
LEBUHRAYA KL-SEREMBAN DAN PINTASAN DENGKIL  
13 OGOS 2018**

**1. LANJUTAN PENUTUPAN LORONG KIRI SECARA BERKALA DI LEBUHRAYA KUALA LUMPUR – SEREMBAN (ARAH SEREMBAN) – D5.0**

<b>Tarikh</b>	15 Ogos 2018 – 30 Oktober 2018
<b>Masa</b>	24 jam
<b>Jangka masa</b>	77 hari
<b>Tujuan</b>	Untuk laluan keluar masuk pembinaan dan sebarang kerja yang berkaitan

Untuk makluman, penutupan lorong kiri **secara berkala** di Lebuhraya Kuala Lumpur Seremban (Arah Seremban) akan dilanjutkan dari **15 Ogos 2018 sehingga 30 Oktober 2018, 24 jam**.

Penutupan lorong ini adalah sejauh 1000 meter bermula dari pintu gerbang di Lebuhraya Kuala Lumpur-Seremban. Semasa penutupan tersebut, pengguna jalanraya masih boleh menggunakan dua (2) lorong sediaada dan pengawal bendera akan mengawal trafik dengan menggunakan kaedah ‘Berhenti dan Jalan’ (seperti yang ditunjukkan dalam anak panah **HIJAU** dalam peta). Sila patuhi arahan papan tanda lalu lintas dan pengawal trafik sepanjang masa.

Untuk maklumat lanjut, sila rujuk peta dibawah

**1. CONTINUATION OF LEFT LANE CLOSURE ALONG KUALA LUMPUR-SEREMBAN HIGHWAY (SEREMBAN-BOUND) – D5.0**

<b>Date</b>	15 August 2018 – 30 October 2108
<b>Time</b>	24 hours
<b>Duration</b>	77 days
<b>Reason</b>	To facilitate access in and out of construction vehicles and any other related works for MRT construction

There will be a continuation of left lane closure along Kuala Lumpur–Seremban Highway at D5.0 (Seremban-bound) from **15 August 2018 until 30 October 2018, 24 hours, intermittently**.

The closure will be starting from Gateway Arch along Kuala Lumpur-Seremban Highway for a stretch of 1km. During the closure, motorists will still be able to use the remaining two (2) lanes and flagmen will be placed to control the traffic flow using ‘STOP’ and ‘GO’ (as shown by **GREEN** arrow in the appended map). Motorists are advised to adhere to safety signage and flagmen at all time.

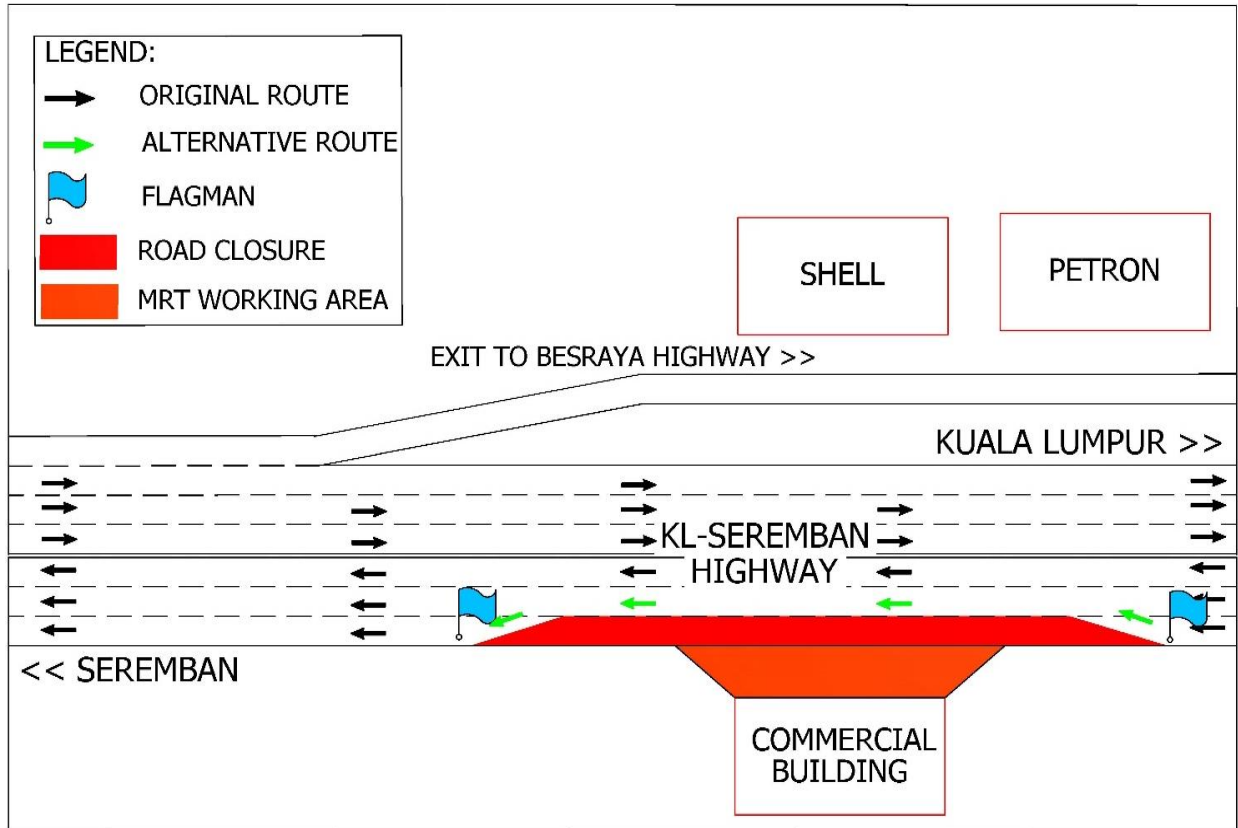

**MAP 1: CONTINUATION OF LEFT LANE CLOSURE ALONG KUALA LUMPUR-SEREMBAN HIGHWAY (SEREMBAN-BOUND) – D5.0**

## 2. PENUTUPAN LORONG KIRI SECARA BERKALA DI LEBUH FT29 PINTASAN DENGKIL (ARAH UTARA DAN ARAH SELATAN)

<b>Tarikh</b>	15 Ogos 2018 – 23 Januari 2019
<b>Masa</b>	7:00 pagi – 7:00 petang; 8:00 malam – 6:00 pagi
<b>Jangka masa</b>	5 bulan 10 hari
<b>Tujuan</b>	Untuk kerja-kerja penghantaran kekotak segmen, pembinaan tiang MRT dan sebarang kerja yang berkaitan

Untuk makluman, penutupan lorong kiri **secara berkala** (Arah Utara dan Arah Selatan) di Lebuhraya Pintasan Dengkil FT29 akan bermula dari **15 Ogos 2018 sehingga 23 Januari 2019, 7:00 pagi – 7:00 petang dan 8:00 malam – 6:00 pagi**. Pelan pengurusan lalulintas adalah seperti berikut:

**Penutupan A:** Penutupan lorong kiri di susur keluar ke Persimpangan Putrajaya Sentral, Lebuhraya Pintasan Dengkil FT29 sepanjang 120 meter. Aliran trafik menghala ke Putrajaya Sentral akan dilencongkan ke lorong kanan (mengikut tanda arah berwarna **UNGU** yang bertanda di peta) semasa penutupan jalan sedang dijalankan.

**Penutupan B:** Penutupan lorong kiri di susur keluar ke Persiaran APEC, Cyberjaya sepanjang 120 meter. Aliran trafik menghala ke Persiaran APEC akan dilencongkan ke lorong kanan (mengikut tanda arah berwarna **HIJAU** yang bertanda di peta) semasa penutupan jalan sedang dijalankan.

Penutupan-penutupan jalan ini akan dilaksanakan secara berkala dan lorong kanan boleh digunakan oleh pengguna jalanraya pada satu-satu masa.

Sila patuhi arahan papan tanda lalu lintas dan pengawal trafik sepanjang masa.

---

## 2. INTERMITTENT LEFT LANE CLOSURES ALONG LEBUH PINTASAN DENGKIL FT29 (NORTH-BOUND AND SOUTH-BOUND)

<b>Date</b>	15 August 2018 – 23 January 2019
<b>Time</b>	7:00am – 7:00pm; 8:00pm – 6:00am
<b>Duration</b>	5 months 10 days
<b>Reason</b>	To facilitate transportation of Segmental Box Girders (SBGs), construction of piers and any other related works for MRT construction

There will be left lane closures along Lebuhraya Pintasan Dengkil FT29 (North-Bound and South-Bound) starting from **15 August 2018 to 23 January 2019, intermittently, 7:00 am – 7:00 pm and 8:00 pm – 6:00 am**. The traffic management plan is as per below:

**Closure A:** Left lane closure at the slip road heading to Persimpangan Putrajaya Sentral, Lebuhraya Pintasan Dengkil FT29 for a stretch of 120 metres. During this closure, motorists heading to Putrajaya Sentral will be diverted to the right lane (as indicated by **PURPLE** arrow in the map).

**Closure B:** Left lane closure at the slip road heading to Persiaran APEC, Cyberjaya for a stretch of 120 metres. During this closure, motorists heading to Persiaran APEC will be diverted to the right lane (as indicated by **GREEN** arrow in the map).

The closures will be activated intermittently and at least one lane is made available at any one time.

Motorists are advised to adhere to safety signage and flagmen at all time.

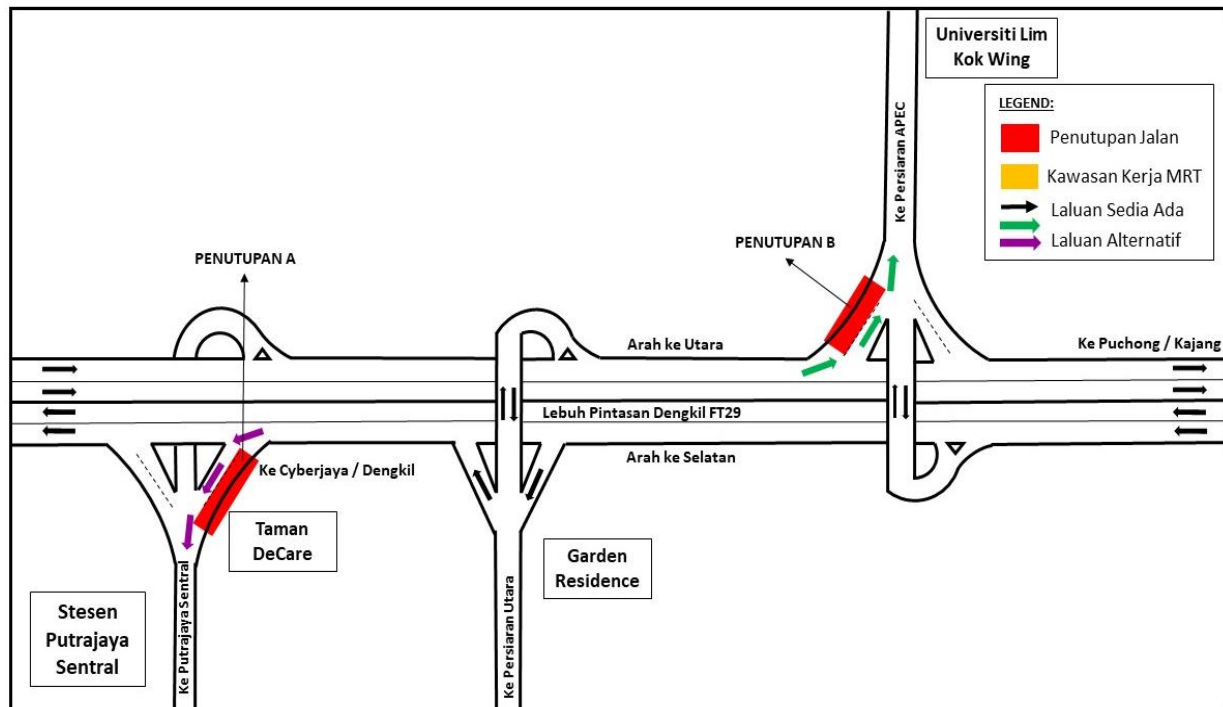

**MAP 2: INTERMITTENT LEFT LANE CLOSURES ALONG LEBUH PINTASAN DENGKIL FT29 (NORTH-BOUND AND SOUTH-BOUND)**

**For media enquiries, please contact:**

Anizam bin Ali (**Item 1**)

Tel: +6016 322 1486

anizam.ali@wct.my

Mohd Hisham Abu Bakar (**Item 2**)

Tel: +6017 447 2767

hisham.bakar@mrcb.com

Leanne Ann Susau (**Item 1-2**)

Tel: +603 7493 3832

leanne@mgjv-kvmrt.com.my

**MMC GAMUDA KVMRT (PDP SSP) SDN BHD** (1117100-V)  
 Block A, Level 17, Menara Mustapha Kamal, PJ Trade Centre  
 No 8, Jalan PJU 8/8A, Bandar Damansara Perdana, 47820 Petaling Jaya  
 Selangor Darul Ehsan, Malaysia  
 T: +603-7494 2222 F: +603-7727 0222 [www.mymrt.com.my](http://www.mymrt.com.my)