

**PENGUMUMAN TRAFIK  
MAKLUMAN TERKINI PELAN PENGURUSAN TRAFIK UNTUK PEMBINAAN MRT SSP SEPANJANG  
PERSIARAN APEC & LEBUHRAYA SKVE  
20 JULAI 2018**

**1. LANJUTAN PENUTUPAN JALAN JANGKA PANJANG DI PERSIARAN APEC (ARAH KE  
CYBERJAYA DAN PUCHONG)**

Tarikh	23 Julai 2018 - 19 Mac 2019
Masa	Isnin hingga Sabtu, 8.00pagi-10:00malam dan 10:00malam-5.00pagi
Jangka masa	8 bulan
Sebab	Untuk kerja-kerja pelaksanaan Pelan Pengurusan Lalu Lintas, pemetaan, pengesanan awalan, penyiasatan tanah, pembukaan median, mengeluarkan gantry, pelebaran jalan, penebangan pokok, kerja-kerja pemunggahan barang, deployment of bore pile machine, pembinaan cerucuk, konkrit, pembinaan tiang, dan sebarang kerja berkaitan.

Harap maklum penutupan jalan jangka masa panjang secara berperingkat dan berkala di Persiaran APEC akan bermula dari **23 Julai 2018 hingga 19 Mac 2019**. Jangka masa untuk kerja-kerja akan bermula dari **8.00pagi-10.00malam, Isnin hingga Sabtu**.

Penutupan jalan jangka masa panjang secara berperingkat dan berkala seperti berikut:

**Penutupan A:** Penutupan lorong paling kanan sepanjang 200 meter sebelum lampu isyarat di Persiaran APEC.

**Penutupan B:** Penutupan lorong paling kiri sepanjang 200 meter sebelum lampu isyarat di Persiaran APEC.

**Penutupan C:** Penutupan lorong paling kiri sepanjang 200 meter berdekatan dengan Stesen Pam IWK di Persiaran APEC.

(Sila rujuk PETA 1)

**Percubaan Laluan Kontra (23 Julai 2018 – 23 Ogos 2018)**

Percubaan laluan kontra akan dilaksanakan atas permintaan Majlis Perbandaran Sepang di Persiaran APEC. Percubaan secara berkala ini dilaksanakan untuk memantau aliran trafik dari **10.00malam-5.00pagi, Isnin hingga Sabtu**, untuk tempoh satu bulan.

Salah satu arah jalan akan ditutup semasa laluan kontra sedang dilaksanakan. Pengguna jalan raya akan dilencongkan ke jalan arah bertentangan dengan pertolongan pengawal bendera.

(Sila rujuk PETA 2).

## 1. CONTINUATION OF LONG-TERM LANE CLOSURES ALONG PERSIARAN APEC (CYBERJAYA AND PUCHONG BOUND)

<b>Date</b>	23 July 2018 – 19 March 2019
<b>Time</b>	8.00am – 10.00pm, Monday - Saturday
<b>Duration</b>	8 months
<b>Reason</b>	To facilitate implementation of Traffic Management Plan, mapping works, piloting works, soil investigation works, opening of median, gantry relocation, road widening works, bored piling works, concreting works, pier construction works and any other related works.

There will be a continuation of intermittent long-term lane closure by stages along Persiaran APEC starting from **23 July 2018 – 19 March 2019**. Duration of works will be from **8.00am – 10.00pm, Monday - Saturday**.

Details of intermittent long-term lane closure by stages are as below:

**Closure A:** Right-most lane closure for a stretch of 200 meters before the traffic light at Persiaran APEC.

**Closure B:** Left-most lane closure for a stretch of 200 metres before the traffic light at Persiaran APEC.

**Closure C:** This long-term lane closure at the median is for a stretch of 200 meters near the IWK pump station.

(See MAP 1 appended)

### **Contra-flow Trial Run (23 July 2018 – 23 August 2018)**

There will be a contra-flow trial run requested as by Majlis Perbandaran Sepang along Persiaran APEC. This trial run is implemented to monitor traffic flow, which will take place intermittently from **10.00pm-5.00am, Monday to Saturday** during this one month period.

One bound will be closed during the contra-flow. Flagman will help direct motorist to use the other bound.

(See MAP 2 appended).

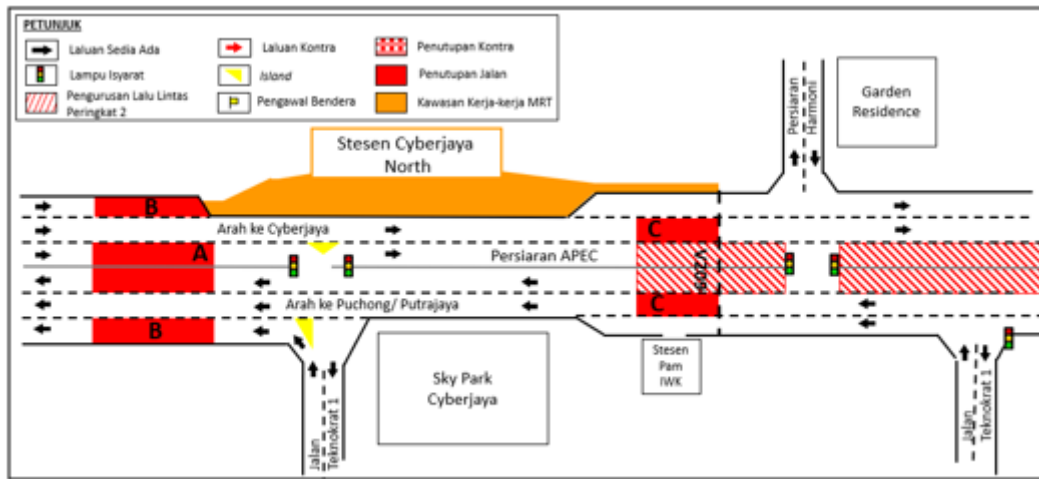

**PETA 1 : LANJUTAN PENUTUPAN JALAN JANGKA PANJANG DI PERSIARAN APEC (ARAH KE CYBERJAYA/ PUCHONG)**

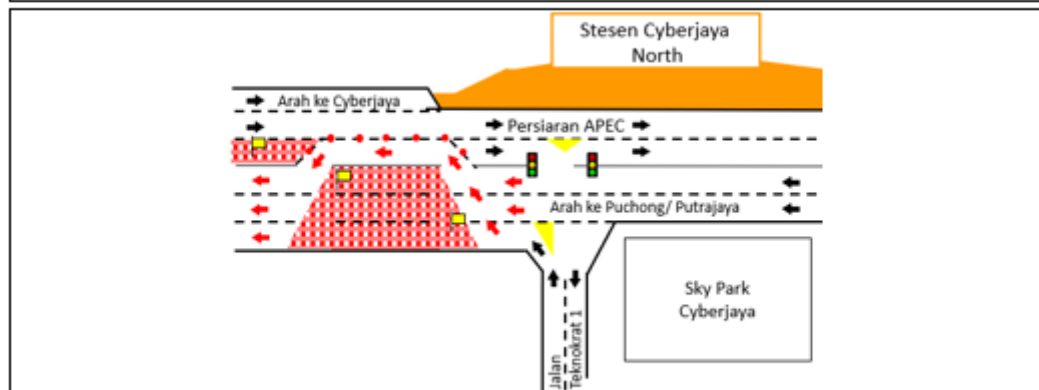

**PETA 2 : TRIAL RUN LAJUAN KONTRA DI PERSIARAN APEC (ARAH KE PUCHONG)**

## 2. LANJUTAN PENUTUPAN JALAN JANGKA PANJANG DI KM 8.9 SEHINGGA KM 9.5 LEBUHRAYA SKVE (ARAH KE KLANG DAN PUTRAJAYA)

Tarikh	23 Julai 2018 - 10 Mei 2019
Masa	Isnin hingga Jumaat, 9.00pagi-6.00petang dan 10.00malam-6.00pagi
Jangka masa	9 bulan
Sebab	Untuk kerja-kerja pelaksanaan Pelan Pengurusan Laju Lintas peringkat pertama dan kedua, pemetaan, pengesanan awalan, penyiasatan tanah, pembinaan cerucuk, konkrit, pembinaan tiang dan sebarang kerja berkaitan.

Harap maklum penutupan jalan di KM 8.9 sehingga KM 9.5 Lebuhraya SKVE (Arah ke Klang dan Putrajaya) akan diteruskan dari **23 Julai 2018 hingga 10 Mei 2019**. Jangka masa untuk kerja-kerja akan bermula **9.00pagi-6.00petang** dan **10.00malam-6.00pagi**, daripada **Isnin hingga Jumaat**.

**Penutupan A:** Lorong motosikal menghala ke arah Putrajaya akan ditutup. Lorong motosikal yang baru akan dibina dan pengguna akan dilencongkan ke lorong motosikal ini. Jalan keluar yang baru untuk lorong motosikal akan berada di bawah jebat. (Sila rujuk peta).

**Penutupan B:** Pelaksanaan Pengurusan Lalu Lintas Peringkat 2 – Penutupan 24 jam untuk Lorong paling kanan di kedua-dua arah sepanjang 600 meter. Walaubagaimanapun, tiga laluan masih dibuka di kedua-dua arah. (Sila rujuk peta).

**Penutupan C:** Penutupan lorong paling kanan akan dilaksanakan sepanjang 150 meter di jalan susur menghala ke Persiaran Sierra Utama. Jangka masa untuk kerja adalah dari 9.00pagi-6.00petang dan 10.00malam-6.00pagi, daripada Isnin hingga Jumaat. Pengguna jalan raya masih mempunyai satu lorong di jalan susur tersebut (Sila rujuk peta).

## **2. CONTINUATION OF LONG-TERM LANE CLOSURE FROM KM8.9 - KM9.5 SKVE HIGHWAY (KLANG AND PUTRAJAYA BOUND)**

Date	23 July 2018 – 10 May 2019
Time	10.00pm-6.00am, Monday to Friday
Duration	9 months
Reason	To facilitate implementation of Traffic Management Plan stage 1 & 2, mapping works, piloting works, soil investigation works, bored piling works, concreting works, pier construction works and any other related works.

There will be a lane closure at KM8.9 to KM9.5, SKVE Highway (Klang and Putrajaya Bound) continuing from **23 July 2018 – 10 May 2019**. Duration of works will be from **9.00am-6.00pm** and **10.00pm-6.00am, Monday to Friday**.

**Closure A:** Motorcycle lane will be closed at Putrajaya bound. A new motorcycle lane will be constructed and motorists will be directed into this new lane. The exit of the new motorcycle lane will be under the Persiaran Sierra Utama Flyover. (See map appended).

**Closure B:** This is the implementation of Traffic Management Plan stage 2 – 24 hours long-term right-most lane closure for approximately 600 metres on both bounds. During the closure, three lanes will be available for motorists on both bounds. (See map appended).

**Closure C:** Right-most lane closure for a stretch of approximately 150 metres along SKVE ramp heading to Persiaran Sierra Utama. Duration of works will be from 9.00am-5.00pm and 10.00pm-4.00am, Monday to Friday. One lane will be available for motorists at the ramp. (See map appended).

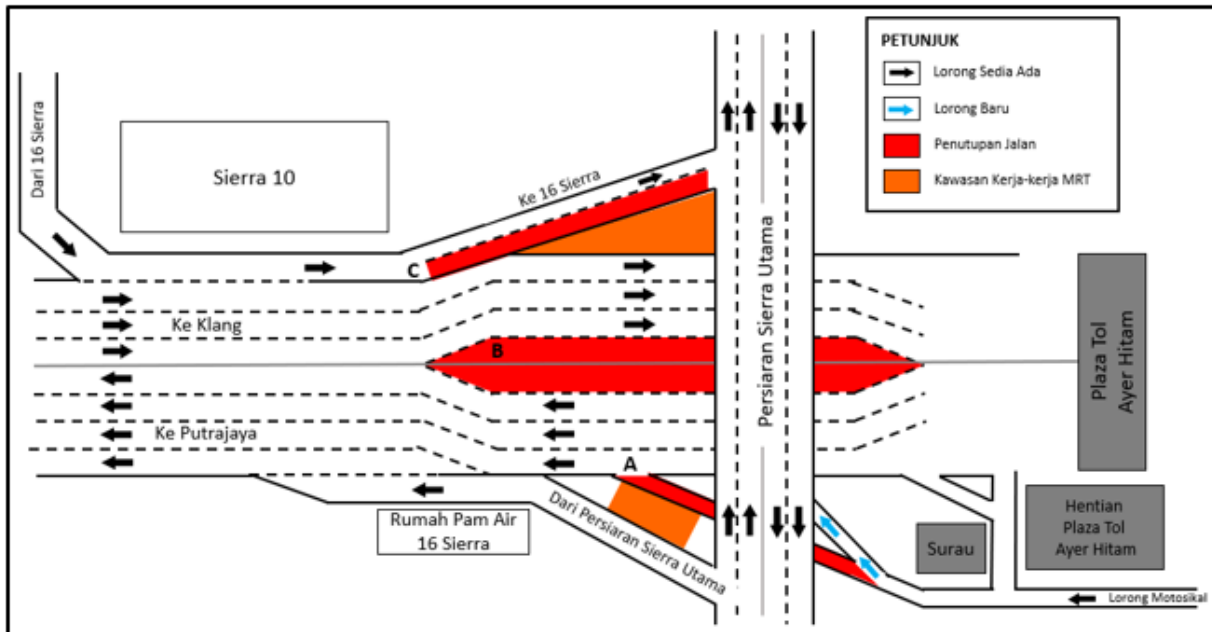

**PETA: LANJUTAN PENUTUPAN JALAN JANGKA PANJANG DI KM 8.9 SEHINGGA KM 9.5 LEBUHRAYA SKVE (ARAH KE KLANG DAN PUTRAJAYA)**

**For media enquiries, please contact:**

Adeline Cruz

Tel: +60 12-217 2017

[adeline@acroworks.com.my](mailto:adeline@acroworks.com.my)

Leanne Susau

Tel: +603 7493 3832

[leanne@mgjv-kvmrt.com.my](mailto:leanne@mgjv-kvmrt.com.my)

**MMC GAMUDA KVMRT (PDP SSP) SDN BHD (1117100-V)**

Block A, Level 17, Menara Mustapha Kamal, PJ Trade Centre

No 8, Jalan PJU 8/8A, Bandar Damansara Perdana, 47820 Petaling Jaya

Selangor Darul Ehsan, Malaysia

T: +603-7494 2222 F: +603-7727 0222 <http://www.mymrt.com.my>