



NOTIS
PROJEK MASS RAPID TRANSIT LALUAN 2:
SUNGAI BULOH – SERDANG – PUTRAJAYA (SSP)

SAMBUNGAN KERJA-KERJA PEMBINAAN DI PERSIARAN DAGANG
(1 Jun 2018 - 23 Jun 2018)

Untuk makluman, terdapat sambungan kerja-kerja pembinaan di Persiaran Dagang dari **1 Jun 2018 – 23 Jun 2018**. Berikut adalah kerja-kerja pembinaan yang akan dijalankan:

- Menjalankan kerja-kerja *gantry advancing*
- Pelancaran Kekotak Segmen (SBG)
- Sebarang kerja-kerja berkaitan

Tempoh kerja:

- 1 Jun 2018 - 23 Jun 2018
- Isnin - Ahad
- 10:00 malam – 6:00 pagi (tertakluk kepada kelulusan pihak berkuasa)

Untuk menjalankan kerja-kerja pembinaan yang disebutkan di atas, penutupan lorong di Persiaran Dagang sepanjang 200 meter akan bermula dari **10:00 malam – 6:00 pagi, setiap hari**. Semasa penutupan ini, aliran trafik adalah seperti berikut:

- **Pemandu dari Persiaran Dagang menghala ke Persiaran Jati** akan dilencongkan ke kanan Persiaran Cemara, hala terus kemudian belok kiri untuk kembali di Persiaran Jati (seperti yang ditunjukkan oleh anak panah **BIRU** dalam peta).
- **Pemandu dari Persiaran Jati menghala ke Persiaran Dagang** harus membuat pusingan “U” di lampu isyarat LDP/DUKE2, hala terus sehingga lampu isyarat ke kanan Persiaran Cemara sebelum kembali di Persiaran Dagang (seperti yang ditunjukkan oleh anak panah **HIJAU** dalam peta).

Sila rujuk peta di bawah untuk maklumat lanjut.

Kami memohon maaf di atas segala kesulitan yang dialami. Kesabaran anda amat dihargai sepanjang proses pembinaan MRT SSP Line untuk kemajuan sistem pengangkutan awam Kuala Lumpur di masa hadapan.

**MRT SSP LINE PROJECT – CONTINUATION OF CONSTRUCTION ACTIVITIES AT
PERSIARAN DAGANG**

Please be informed that KVMRT SSP Line construction works will be continuing at Persiaran Dagang from **1 June 2018 – 23 June 2018**. The following are the construction activities that will be conducted:

- Gantry Advancing
- SBG Launching
- Any other related works

Work Duration:

- 1 June 2018 – 23 June 2018
- Monday - Sunday
- 10:00 pm – 6:00 am (subject to authorities' approval)

To facilitate the above mentioned construction works there will be a road closure along Persiaran Dagang from **10:00PM-6:00AM, daily** for a stretch of 200 metres. During this closure, the following diversions will take place:

- **Motorists from Persiaran Dagang heading towards Persiaran Jati** will be diverted to turn right into Persiaran Cemara, head straight and turn left to join Persiaran Jati (as indicated in **BLUE** arrows in map).
- **Motorists from Persiaran Jati heading towards Persiaran Dagang** will be diverted to make a U-turn at LDP/DUKE2 interchange traffic light, turn right at Persiaran Cemara head straight before turning left into Persiaran Dagang (as indicated in **GREEN** arrows in map).

Please refer to the attached map for further information.

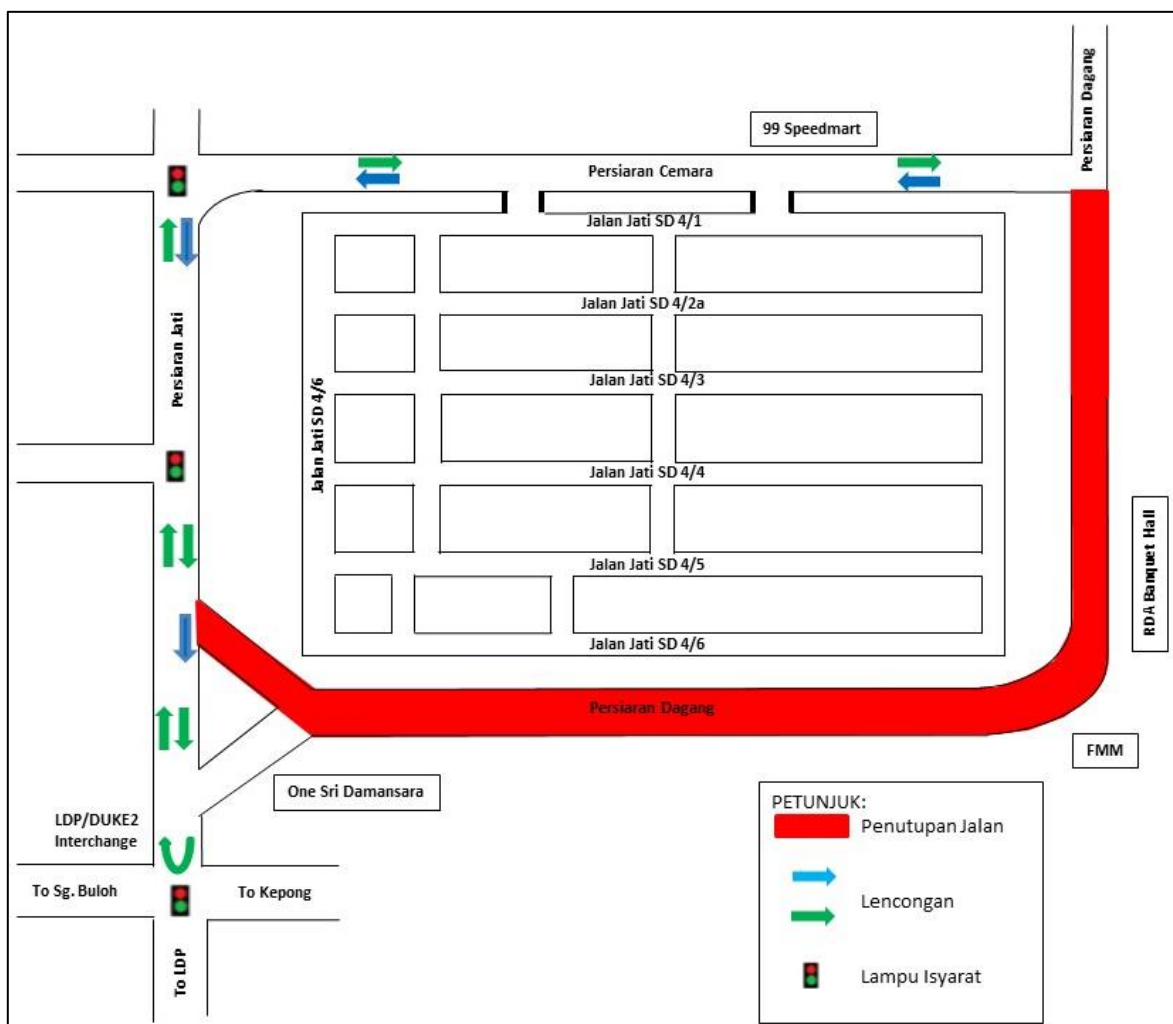

We apologise for any inconvenience caused during this period. Your kind understanding and patience is much appreciated as we are building the MRT SSP Line for our future and to improve KL's public transportation system.

For more information, please contact:-

Sunway Construction Sdn. Bhd.

En. Mohd Sofie Hassan, Senior Manager

PR & Stakeholder Management:

019 - 228 3004

MRT Hotline: 1800 82 6868

www.mymrt.com.my

feedback@mymrt.com.my

**WE ARE BUILDING THE MRT SSP LINE FOR OUR FUTURE
THANK YOU**

