

TRAFFIC ANNOUNCEMENT
UPDATES ON TRAFFIC MANAGEMENT PLAN FOR MRT SSP CONSTRUCTION
BANDAR 16 SIERRA & PERSIARAN APEC
30 MARCH & 1 APRIL 2018

1. CLOSURE OF FREE FLOW U-TURN AT LA THEA JUNCTION, BANDAR 16 SIERRA

Date	30 March 2018 - 03 April 2018
Time	8.00am - 7.00pm
Duration	5 days
Reason	To facilitate soil investigation works and any other related works.

Please be informed that the free flow U-turn at La Thea junction will be closed to accommodate soil investigation works from **Friday, 30 March 2018 - Tuesday, 3 April 2018**. The closure will be 24 hours. However, soil investigation works will be carried out from **8.00am - 7.00pm**.

Motorists heading to Persiaran Alpinia and Sierra 1 will be directed to the Sierra 9 junction to make a U-turn.

The closure will be released and the free-flow U-turn will be reinstated once soil investigation works are completed.

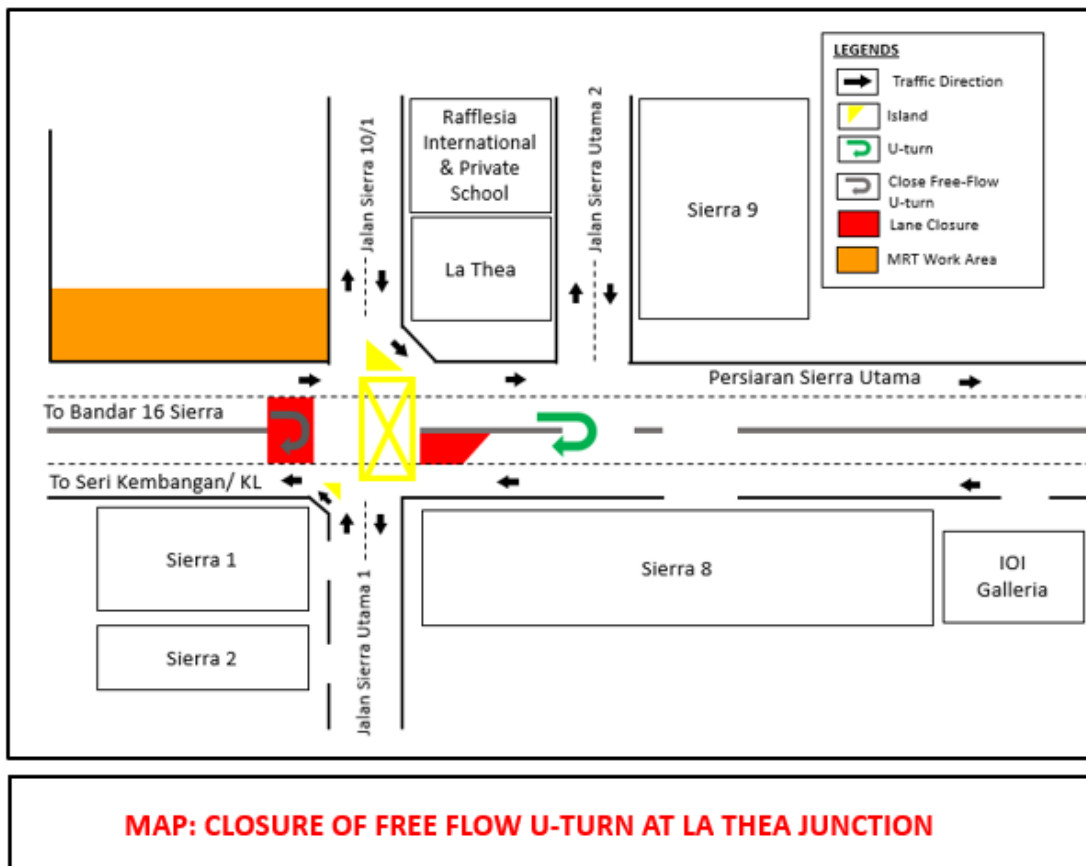

2. CONTINUATION OF LONG-TERM LANE CLOSURE BY STAGES ALONG PERSIARAN APEC

Date	01 April 2018 - 24 July 2018
Time	7:00AM – 7:00PM & 7:00PM – 6:00AM
Duration	3 months
Reason	To facilitate piloting works, utilities relocation works, road widening works, temporary drainage works, implementation of Traffic Management Plan, pier construction works and any other related works.

There will be a continuation of a long-term lane closure by stages along Persiaran APEC starting from **1 April 2018 to 24 July 2018, 7.00AM - 7.00PM (Normal construction activities) & 7:00PM - 6:00AM (Subject to Authorities' approval)**.

Right most lane will be closed for both LDP & Cyberjaya bound **in phases and intermittently**, therefore at any one time there will be one lane available for motorists.

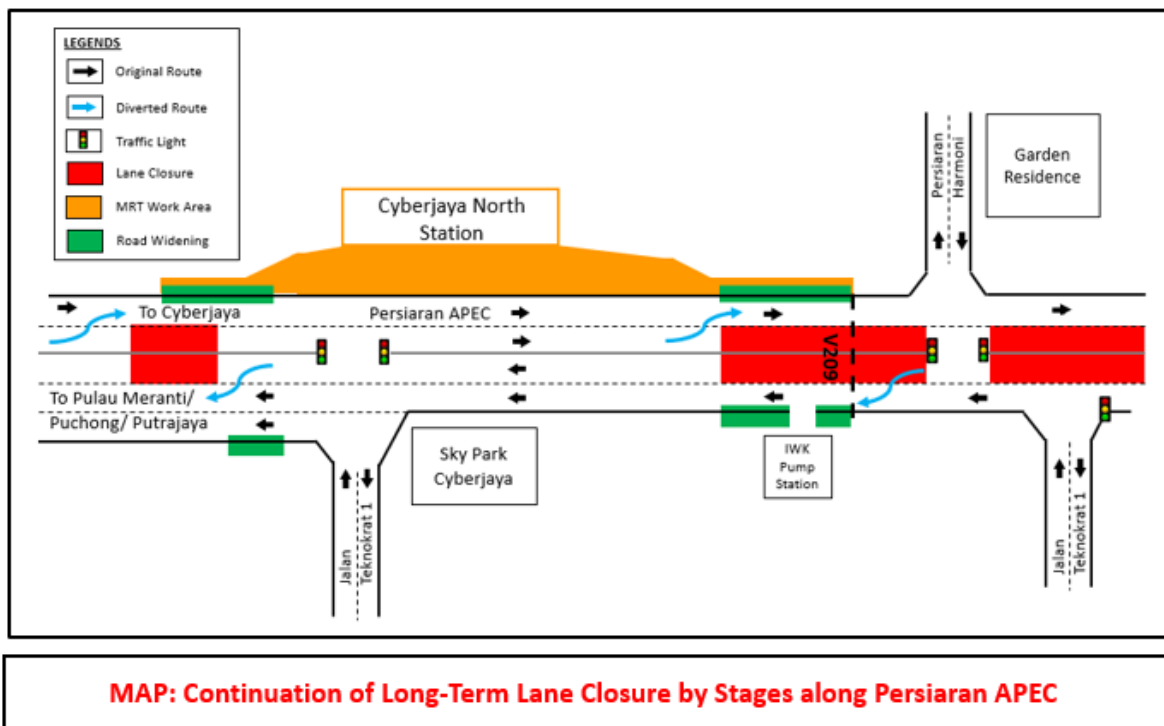

For media enquiries, please contact:

Adeline Cruz

Tel: +60 12-217 2017

adeline@acroworks.com.my

Leanne Susau

Tel: +603 7493 3832

leanne@mgjv-kvmrt.com.my

MMC GAMUDA KVMRT (PDP SSP) SDN BHD (1117100-V)

Block A, Level 17, Menara Mustapha Kamal, PJ Trade Centre

No 8, Jalan PJU 8/8A, Bandar Damansara Perdana, 47820 Petaling Jaya

Selangor Darul Ehsan, Malaysia

T: +603-7494 2222 F: +603-7727 0222 <http://www.mymrt.com.my>