

TRAFFIC ANNOUNCEMENT
EMERGENCY LANE CLOSURE AT LDP HIGHWAY (BOTH BOUND)
LDP HIGHWAY
27/03/2018

Date	29 March 2018 - 31 March 2018
Time	24 Hours
Duration	3 Days
Reason	To facilitate site Mapping and Piloting, Soil Investigation, Survey, Utilities Relocation and any related works.

There will be closure at the emergency lane at LDP Highway (both bound) from **29 March 2018 to 31 March 2018**.

The closure will be done as follows (please refer to map):

Puchong heading towards Putrajaya

During the closure at the emergency lane, the left most lane, the middle lane and the right most lane will be made available for motorist from Puchong heading towards Putrajaya.

Putrajaya heading towards Puchong

During the closure at the emergency lane, the left most lane, the middle lane and the right most lane will be made available for motorist from Putrajaya heading towards Puchong.

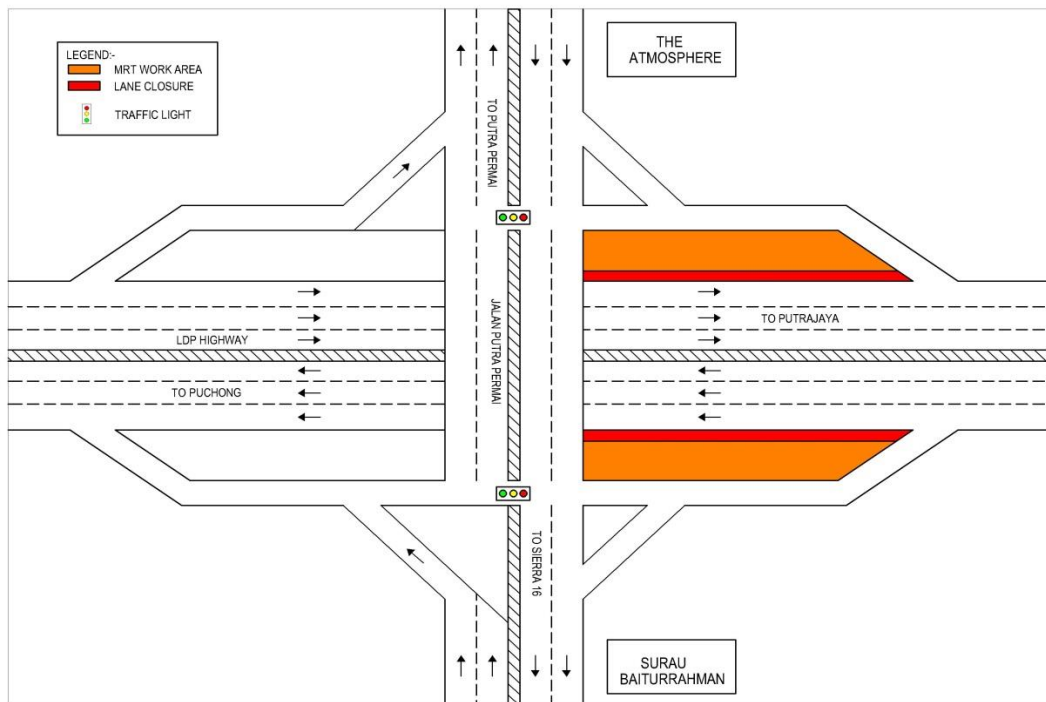

For media enquiries, please contact:

Mohd Lotfi Abdul Latiff

Tel: +6012 2100 766

Mlotfi@V208.com.my

Leanne Ann Susau

Tel: +603 7493 3832

leanne@mgjv-kvmrt.com.my

MMC GAMUDA KVMRT (PDP SSP) SDN BHD (1117100-V)

Block A, Level 17, Menara Mustapha Kamal, PJ Trade Centre

No 8, Jalan PJU 8/8A, Bandar Damansara Perdana, 47820 Petaling Jaya

Selangor Darul Ehsan, Malaysia

T: +603-7494 2222 F: +603-7727 0222 <http://www.mymrt.com.my>