

TRAFFIC ANNOUNCEMENT
CONTINUATION OF LANE CLOSURE ALONG PLUS HIGHWAY
PLUS HIGHWAY
21/03/2018

Date	23 March 2018 - 15 April 2018
Time	10.00 PM - 5.00 AM
Duration	21 days
Reason	To facilitate traffic diversion, premix work, road line marking and installation of concrete barrier and other related construction works.

Please be informed that there will be a continuation of intermittent lane closure at the KM310.1 slip road (emergency lane) from Sungai Besi toll station on PLUS Highway heading towards Seri Kembangan (both bound) from **23 March 2018 - 15 April 2018, 10:00 PM - 5:00 AM**.

During the closure, one emergency lane will be closed and one lane will be made available for motorists. Flagman will be stationed to direct motorists during the closure.

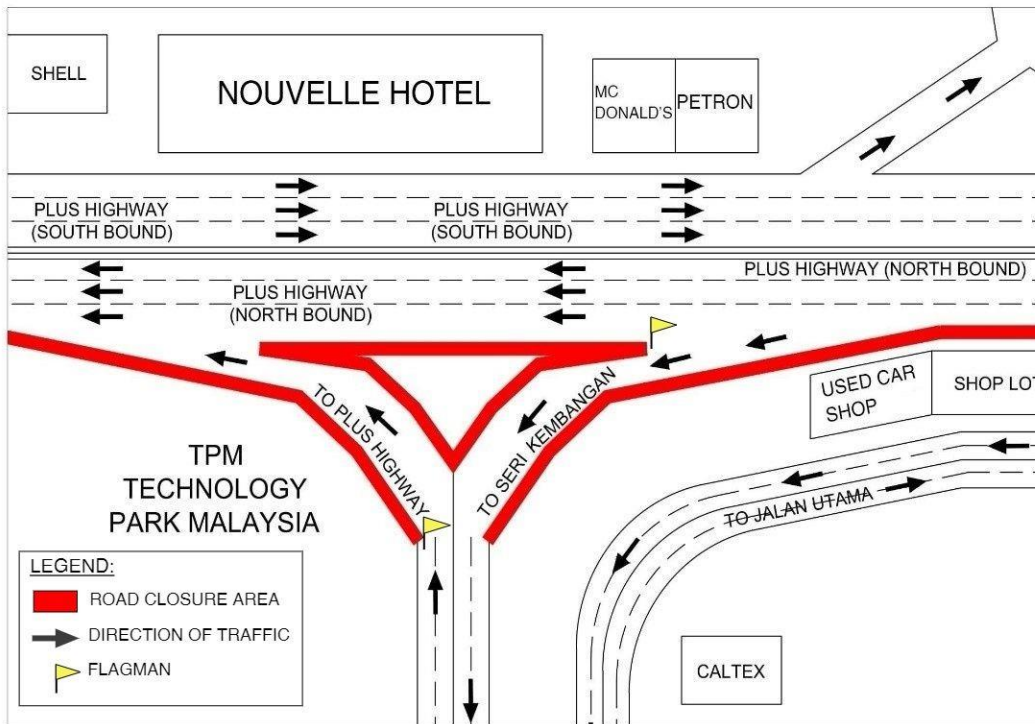

LANE CLOSURE ALONG PLUS HIGHWAY

For media enquiries, please contact:

Mohd Noorshahran bin Md Salleh
Leanne Susau

Tel: +6019 662 8607
Tel: +603 7493 3832

mdnoor88@yahoo.com
leanne@mgjv-kvmrt.com.my

MMC GAMUDA KVMRT (PDP SSP) SDN BHD (1117100-V)

Block A, Level 17, Menara Mustapha Kamal, PJ Trade Centre
No 8, Jalan PJU 8/8A, Bandar Damansara Perdana, 47820 Petaling Jaya
Selangor Darul Ehsan, Malaysia

T: +603-7494 2222 F: +603-7727 0222 <http://www.mymrt.com.my>