

TRAFFIC ANNOUNCEMENT
CONTINUATION OF LEFT LANE CLOSURE ALONG LEBUHRAYA SUNGAI BESI
(KM 9.4-KM 9.7) NEAR KG MALAYSIA (SUNGAI BESI-BOUND)
SUNGAI BESI
02 MARCH 2018

Date	06 March 2018 - 05 April 2018
Time	9.30am - 4.30pm / 10.00pm - 5.00am
Duration	30 Days
Reason	To facilitate access of construction road, site clearance, bore pile work, utilities relocation and other related works for MRT SSP Line

There will be a continuation of left lane closure near Kg Malaysia Raya at Lebuhraya Sungai Besi KM9.4 - KM9.7 (Sungai Besi-Bound) before exit to Terminal Bersepadu Selatan starting from **6 March 2018 until 5 April 2018, 9.30am-4.30pm and 10.00pm-5.00am, daily.**

The closure is for a stretch 300 metres and motorists will still be able to use the slip road to go to Terminal Bersepadu Selatan.

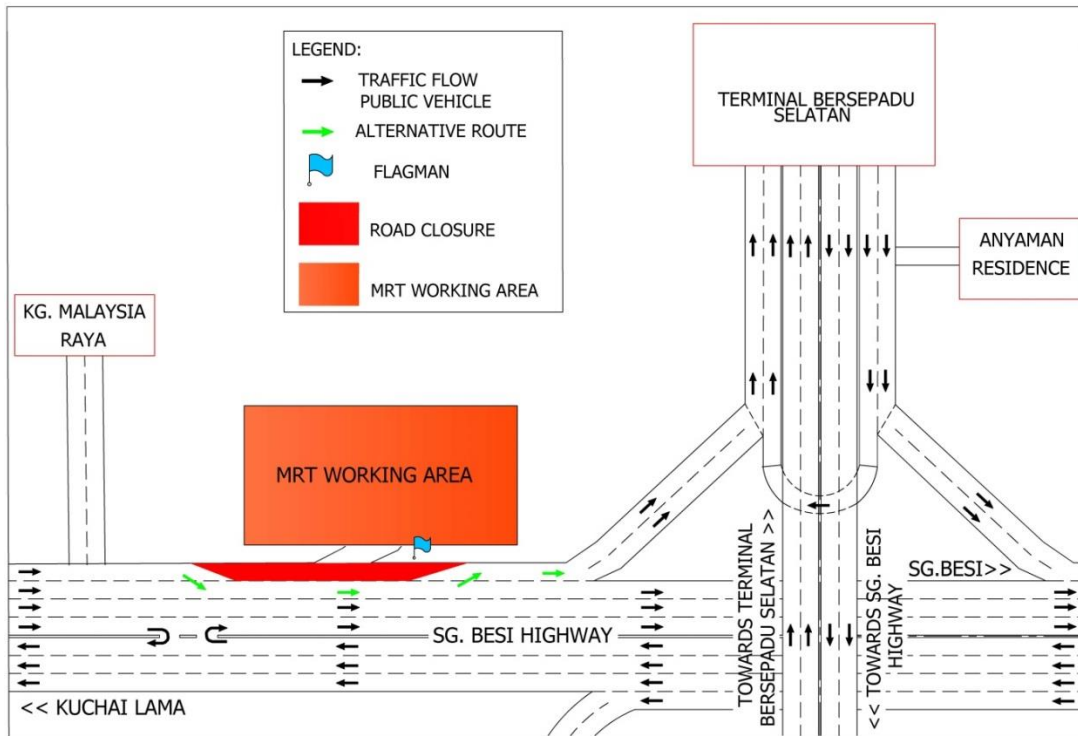

For media enquiries, please contact:

Anizam bin Ali

Tel: +6016 - 322 1486

anizam.ali@wct.my

Leanne Ann Susau

Tel: +603 7493 3832

leanne@mgjv-kvmrt.com.my

MMC GAMUDA KVMRT (PDP SSP) SDN BHD (1117100-V)
Block A, Level 17, Menara Mustapha Kamal, PJ Trade Centre
No 8, Jalan PJU 8/8A, Bandar Damansara Perdana, 47820 Petaling Jaya
Selangor Darul Ehsan, Malaysia
T: +603-7494 2222 F: +603-7727 0222 www.kvmrt.com.my