

**TRAFFIC ANNOUNCEMENT**

**UPDATES ON TRAFFIC MANAGEMENT PLAN FOR MRT SSP CONSTRUCTION ALONG KUALA LUMPUR – SEREMBAN HIGHWAY  
19 FEBRUARY 2018**

**1. CONTINUATION OF LEFT LANE CLOSURE ALONG KUALA LUMPUR – SEREMBAN HIGHWAY D5.0 (SEREMBAN-BOUND)**

<b>Date</b>	21 February 2018 - 06 March 2018
<b>Time</b>	10:00pm – 5:00am
<b>Duration</b>	15 days
<b>Reason</b>	To facilitate the construction access road, site clearance, bore pile work, utilities relocation, sheet pile works and any other related works for MRT construction

There will be a continuation of left lane closure along Kuala Lumpur – Seremban Highway at D5.0 (Seremban-bound) starting from **21 February 2018 until 06 March 2018, 10.00pm-5.00am, daily, intermittently.**

The closure will be start from Gateway Arch along Kuala Lumpur – Seremban Highway for a stretch of 1km. Motorists heading to Seremban will still be able to use the remaining two (2) lanes and during the closure, flagman will be placed to control the traffic flow.

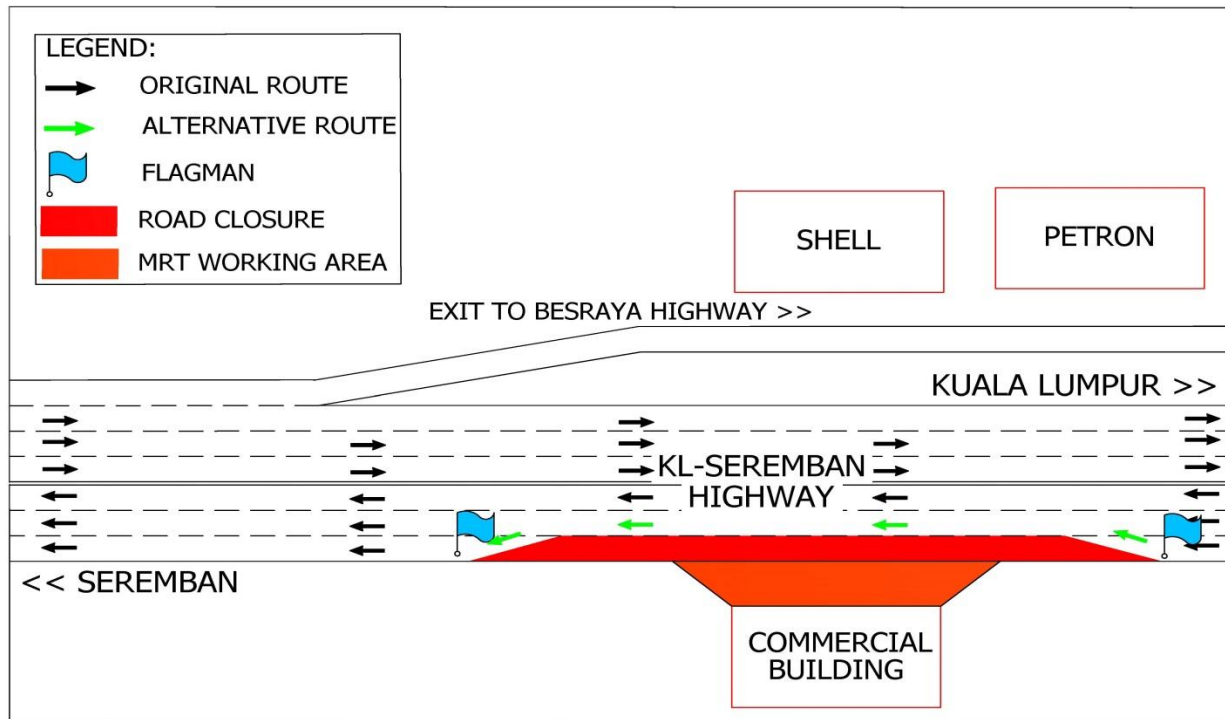

**MAP 1 : CONTINUATION OF LEFT LANE CLOSURE ALONG KUALA LUMPUR – SEREMBAN HIGHWAY D5.0 (SEREMBAN-BOUND)**

**2. CONTINUATION OF LEFT LANE CLOSURE ALONG KUALA LUMPUR – SEREMBAN HIGHWAY D2.3 – D2.4 (KUALA LUMPUR-BOUND)**

<b>Date</b>	21 February 2018 - 10 March 2018
<b>Time</b>	10:00pm to 5:00am
<b>Duration</b>	18 days
<b>Reason</b>	To facilitate construction of access road, site clearance, bore pile work, utilities relocation, sheet pile and any other related works.

There will be a continuation of left lane closure along Kuala Lumpur – Seremban Highway at D2.3 – D2.4 (Kuala Lumpur-bound) starting from **21 February 2018 until 10 March 2018, 10:00pm-5:00am, intermittently.**

During this closure, flagman will be placed at both end using ‘STOP’ and ‘GO’ traffic flow method.

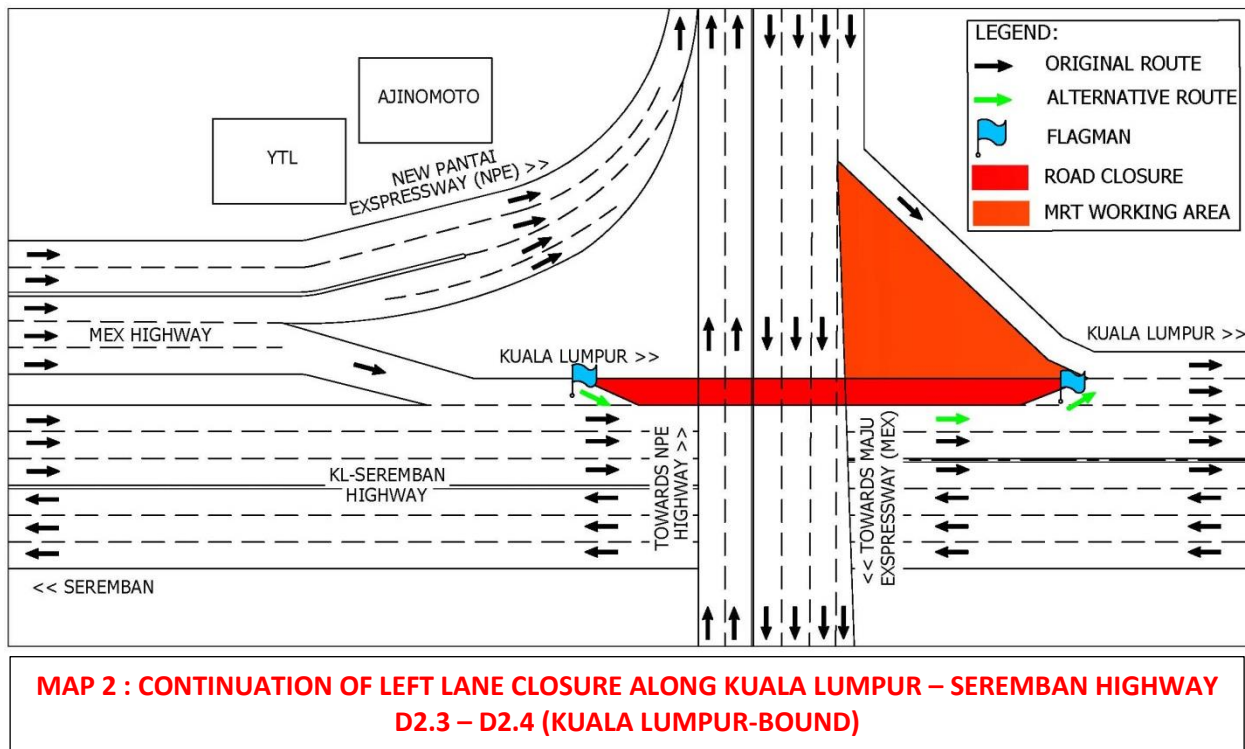

**For media enquiries, please contact:**

Anizam bin Ali  
Leanne Ann Susau

Tel: +6016 322 1486  
Tel: +603 7493 3832

anizam.ali@wct.my  
leanne@mgjv-kvmrt.com.my