

**TRAFFIC ANNOUNCEMENT**  
**CONTINUATION OF RIGHT LANE CLOSURE TOWARDS SLIP ROAD OF JALAN KUCHAI LAMA &**  
**NEW PANTAI EXPRESSWAY (NPE)**

**14 FEBRUARY 2018**

<b>Date</b>	17 February 2018 - 16 March 2018
<b>Time</b>	10:00am – 4:30pm / 10:00pm – 5:00am
<b>Duration</b>	30 days
<b>Reason</b>	To facilitate construction access road, site clearance, bore pile work, utilities relocation, sheet pile and any other related works for MRT SSP line

There will be a continuation of right lane closure towards the slip road to Jalan Kuchai Lama and New Pantai Expressway (North-bound) starting from **17 February 2018 until 16 March 2018, 10.00am-4.30pm and 10.00pm-5.00am (daily), intermittently.**

During this closure, one (1) lane will be made available to motorists heading to Jalan Kuchai Lama & New Pantai Expressway (NPE). The closure is for a stretch 400 meter and flagman will be placed at both end using 'STOP' and 'GO' traffic flow method.

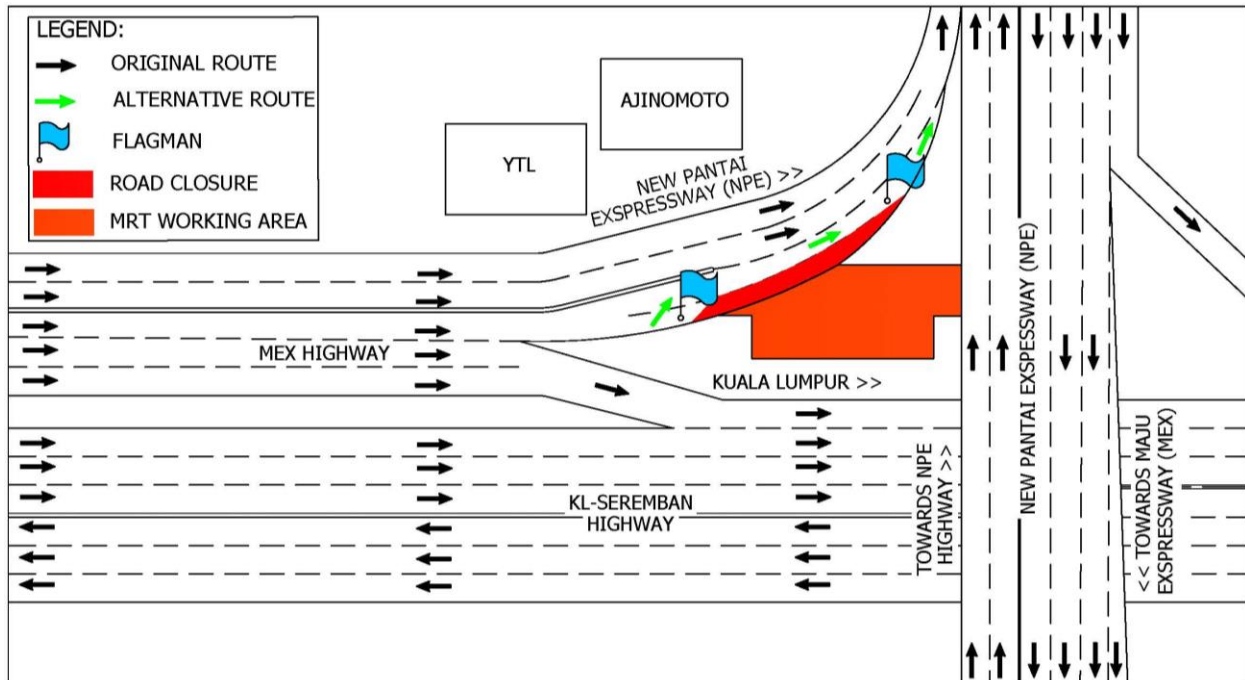

**For media enquiries, please contact:**

Anizam bin Ali  
 Leanne Ann Susau

Tel: +6016 322 1486  
 Tel: +603 7493 3832

anizam.ali@wct.my  
 leanne@mgjv-kvmrt.com.my