

**TRAFFIC ANNOUNCEMENT**  
**CONTINUATION OF LEFT LANE CLOSURE ALONG LEBUHRAYA SUNGAI BESI (KM9.4-KM9.7) NEAR KG**  
**MALAYSIA RAYA (SUNGAI BESI-BOUND)**  
**13 FEBRUARY 2018**

<b>Date</b>	15 February 2018 - 05 March 2018
<b>Time</b>	9:30am – 4:30pm / 10:00pm – 5:00am
<b>Duration</b>	19 days
<b>Reason</b>	To facilitate construction access road, site clearance, bore pile work, utilities relocation, sheet pile and any other related works for MRT SSP line

There will be a continuation of left lane closure near Kampung Malaysia Raya at Lebuhraya Sungai Besi KM9.4 - KM9.7 (Sungai Besi-bound) before exit to Terminal Bersepadu Selatan starting from **15 February 2018 until 05 March 2018, 9:30am-4:30pm and 10:00pm-5:00am (daily), intermittently.**

The closure is for a stretch 300 metres and motorists will still be able to use the slip road to go to Terminal Bersepadu Selatan.

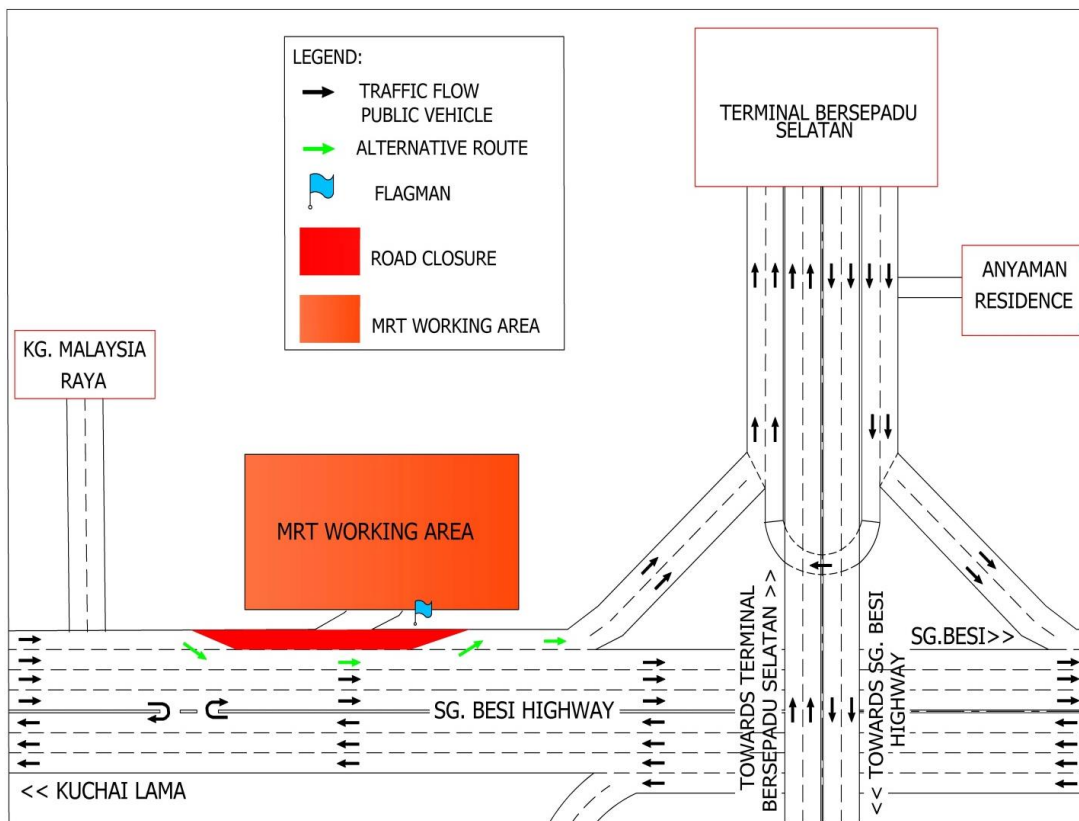

**For media enquiries, please contact:**

Anizam bin Ali  
 Leanne Ann Susau

Tel: +6016 322 1486  
 Tel: +603 7493 3832

anizam.ali@wct.my  
 leanne@mgjv-kvmrt.com.my

**MMC GAMUDA KVMRT (PDP SSP) SDN BHD (1117100-V)**  
 Block A, Level 17, Menara Mustapha Kamal, PJ Trade Centre  
 No 8, Jalan PJU 8/8A, Bandar Damansara Perdana, 47820 Petaling Jaya  
 Selangor Darul Ehsan, Malaysia  
 T: +603-7494 2222 F: +603-7727 0222 [www.kvmrt.com.my](http://www.kvmrt.com.my)