

TRAFFIC ANNOUNCEMENT
CONTINUATION OF LANE CLOSURE ALONG JALAN KEPONG (SUNGAI BULOH - BOUND AND
JINJANG - BOUND)
26 FEBRUARY 2018

Date	28 February 2018 - 28 May 2018
Time	11pm - 6am
Duration	90 days
Reason	To facilitate utilities detection and relocation works for MRt SSP Line construction works

There will be a continuation of lane closures along Jalan Kepong (Sungai Buloh-bound and Jinjang-bound) for a stretch of 600 metres starting **from 28 February 2018 until 28 May 2018, from 11pm to 6am (daily), intermittently.**

During this closure, at any one time, there will be one (1) lane made available for motorists at both bounds.

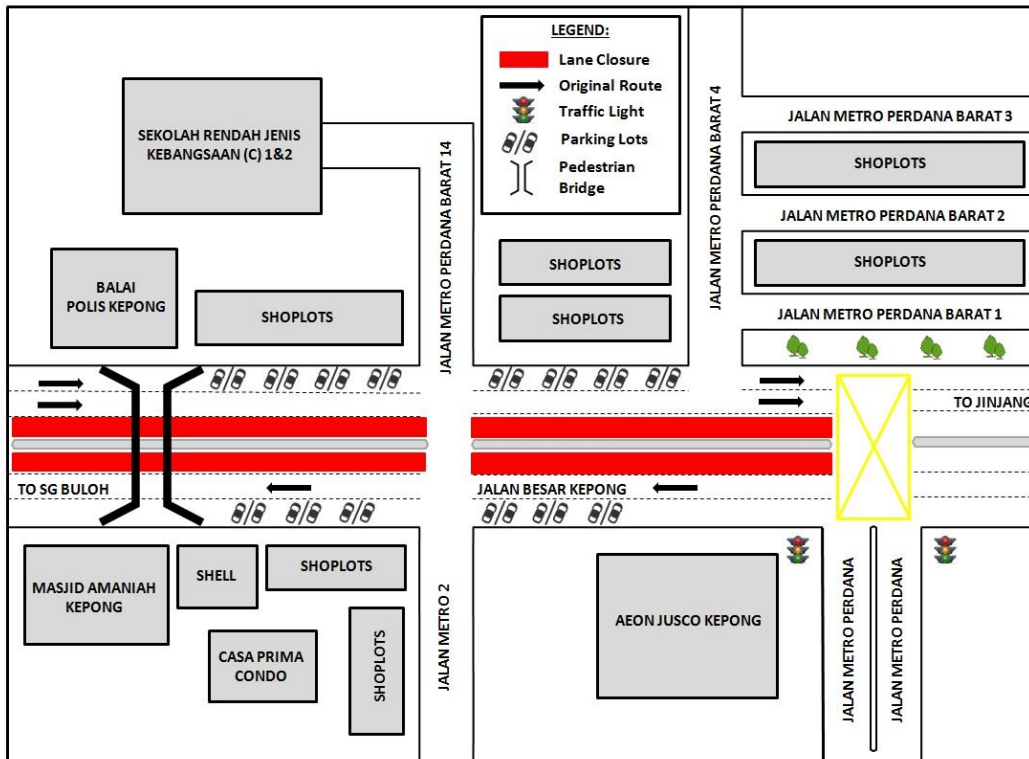

For media enquiries, please contact:

Zaini Ghazali
 Leanne Ann Susau

Tel: +6012 328 1821
 Tel: +603 7493 3832

zainighazali@azrb.com
 leanne@mgjv-kvmrt.com.my

MMC GAMUDA KVMRT (PDP SSP) SDN BHD (1117100-V)
 Block A, Level 17, Menara Mustapha Kamal, PJ Trade Centre
 No 8, Jalan PJU 8/8A, Bandar Damansara Perdana, 47820 Petaling Jaya
 Selangor Darul Ehsan, Malaysia
 T: +603-7494 2222 F: +603-7727 0222 www.mymrt.com.my