



NOTICE

PROJEK MASS RAPID TRANSIT LALUAN 2 : SUNGAI BULOH-SERDANG-PUTRAJAYA (SSP)

**MRT SSP Line Project Construction Activities at Batu Complex Business Centre, Jalan Ipoh
19 January 2018 - 30 April 2018**

Please be informed that the KVMRT SSP Line construction works will be commencing at Batu Complex Business Centre, Jalan Ipoh from **19 January 2018 until 30 April 2018**. The following are the construction activities that will be conducted:

- Sewerage relocation
- Utilities relocation
- Any other related works

To facilitate the above-mentioned works, internal lane closures will be implemented by stages from **9:00pm – 6:00am** as per below:

Closure A

- Internal road closure for a stretch of 80 metres by stages along Jalan Murai starting from **19 January 2018**.

Closure B

- Internal road closures along Jalan Murai and Jalan Murai 1. The closures will be implemented by stages intermittently for a stretch of 80 metres per stage starting from **05 February 2018**. During the closures, motorists using these roads will be diverted to the opposite lane by flagmen at both end using "Stop and Go" method of traffic flow (as indicated in **GREEN** arrows in map).

Below is the map for further reference on the construction works as mentioned above:

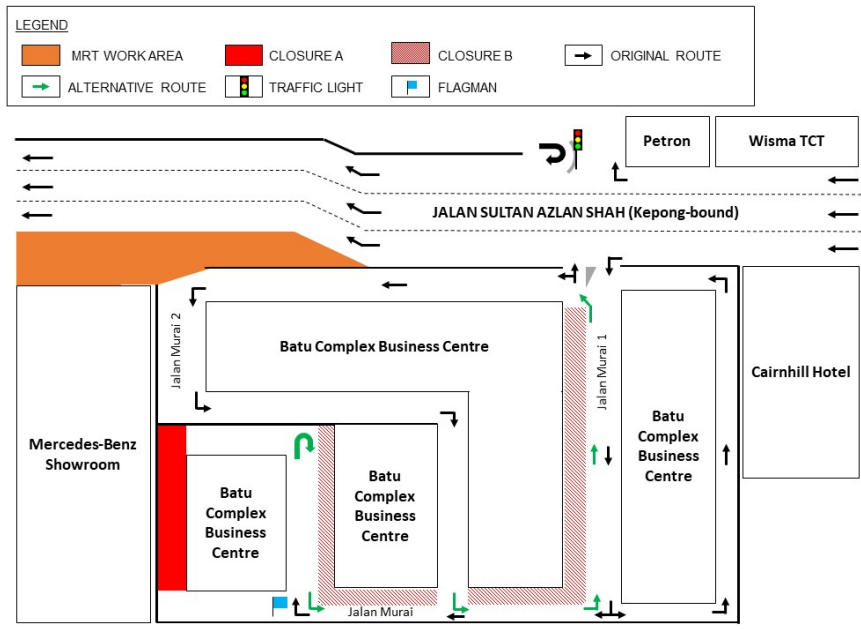

We apologise for any inconvenience caused during this period. Your kind understanding and patience is much appreciated as we are building the MRT SSP Line for our future and to improve KL's public transportation system.

For more information, please contact:

IJM Construction Sdn. Bhd.

Juliet Choong Wai Gaik, Senior Manager, PR & Stakeholder Management: 012 - 6010 318

Irynn Eng Poh Ling, Manager, PR & Stakeholder Management: 012 - 2289 270

MRT Hotline: 1800 82 6868

www.mymrt.com.my

feedback@mymrt.com.my

WE ARE BUILDING THE MRT SSP LINE FOR OUR FUTURE

THANK YOU

