

AlloyMtd

NOTICE

PROJEK MASS RAPID TRANSIT LALUAN 2 : SUNGAI BULOH-SERDANG-PUTRAJAYA (SSP)

MRT SSP Line Project Activities at Jalan Persiaran Lestari Perdana 1 Towards Persiaran Equine Perdana

22 December 2017 - 16 January 2018

Please be informed that KVMRT SSP Line works will be commencing at Jalan Persiaran Lestari Perdana 1 starting **22 December 2017 until 16 January 2018**. The intermittent lane closure on the left-most lane along Jalan Persiaran Lestari Perdana 1 is to facilitate the following activities:

- Relocation of TM cable
- Any other related works

The closure will be done in stages as follows (please refer to map):

S1 - During the lane closure one lane will be made available for motorist.

S2 - During the lane closure one lane will be made available for motorist.

Duration of works:

Monday - Friday (9.00AM - 5.00PM)

Monday - Friday (9.00PM - 5.00AM)

Saturday (9.00AM - 12.00PM)

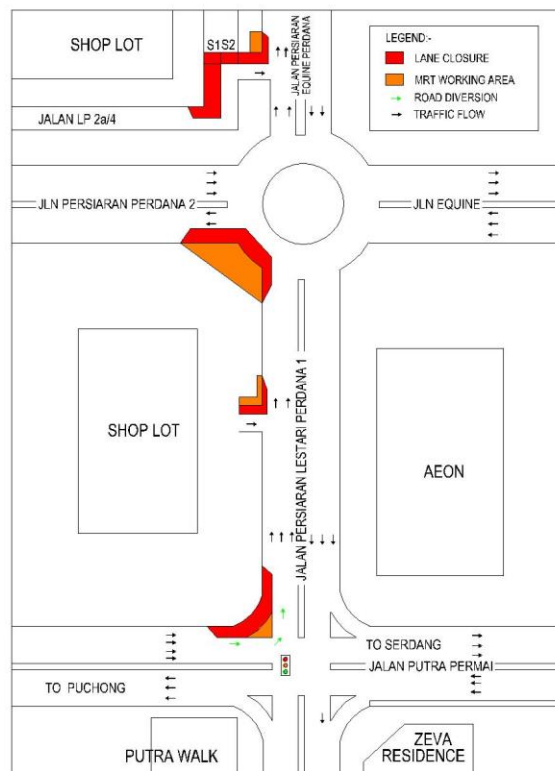

We apologise for any inconvenience caused during this period. Your kind understanding and patience is much appreciated as we are building the MRT SSP Line for our future and to improve KL's public transportation system.

For more information, please contact:

MTD Construction Sdn. Bhd.

En. Mohd Lotfi Abdul Latiff, Senior Manager, PR & Stakeholder Management:

012 - 2100 766

MRT Hotline: 1800 82 6868

www.mymrt.com.my

feedback@mymrt.com.my

WE ARE BUILDING THE MRT SSP LINE FOR OUR FUTURE

THANK YOU

