

AlloyMtd

NOTICE

PROJEK MASS RAPID TRANSIT LALUAN 2 : SUNGAI BULOH-SERDANG-PUTRAJAYA (SSP)

MRT SSP Line Project Activities at Jalan Pinggiran Putra 2, Jalan Pinggiran Putra and Jalan Pinggiran 1/3

23 December 2017 - 16 January 2018

Please be informed that KVMRT SSP Line works will be commencing at Jalan Persiaran Pinggiran Putra, Jalan Pinggiran Putra 2, Jalan Pinggiran Putra and Jalan Pinggiran 1/3 starting **23 December 2017 until 8 January 2018**.

The closure will be done in stages as follows (please refer to map):

Jalan Pinggiran Putra 2 towards Jalan Persiaran Pinggiran Putra

The intermittent lane closure on the left-most lane along Jalan Pinggiran Putra 2 towards Jalan Persiaran Pinggiran Putra and from Jalan Persiaran Pinggiran Putra towards Jalan Pinggiran Putra is to facilitate the following activities:

- Relocation of TM cable
- Any other related works

S1 - During the lane closure one lane will be made available for motorist from Jalan Pinggiran Putra towards Jalan PP25.

S2 - During the lane closure one lane will be made available for motorist from Jalan PP25 towards Jalan Pinggiran Putra 2.

Jalan Pinggiran Putra towards Jalan Putra Permai

S1 - During the lane closure, one lane will be made available for motorist from Jalan Pinggiran Putra heading towards Jalan Putra Permai.

Jalan Putra Permai towards Jalan Pinggiran Putra

S2 - During the lane closure, motorist from Jalan Putra Permai heading towards Jalan Pinggiran Putra will be diverted towards Jalan Pinggiran 1/3 and Jalan Pinggiran 1/5 (as indicated in **GREEN** arrow in map).

Duration of works:

Monday - Friday (9.00AM - 5.00PM & 9.00PM – 5.00AM)

Saturday (9.00AM - 12.00PM & 9.00PM - 5.00AM)

*Certain construction activities that require night works will be subject to authorities' approval

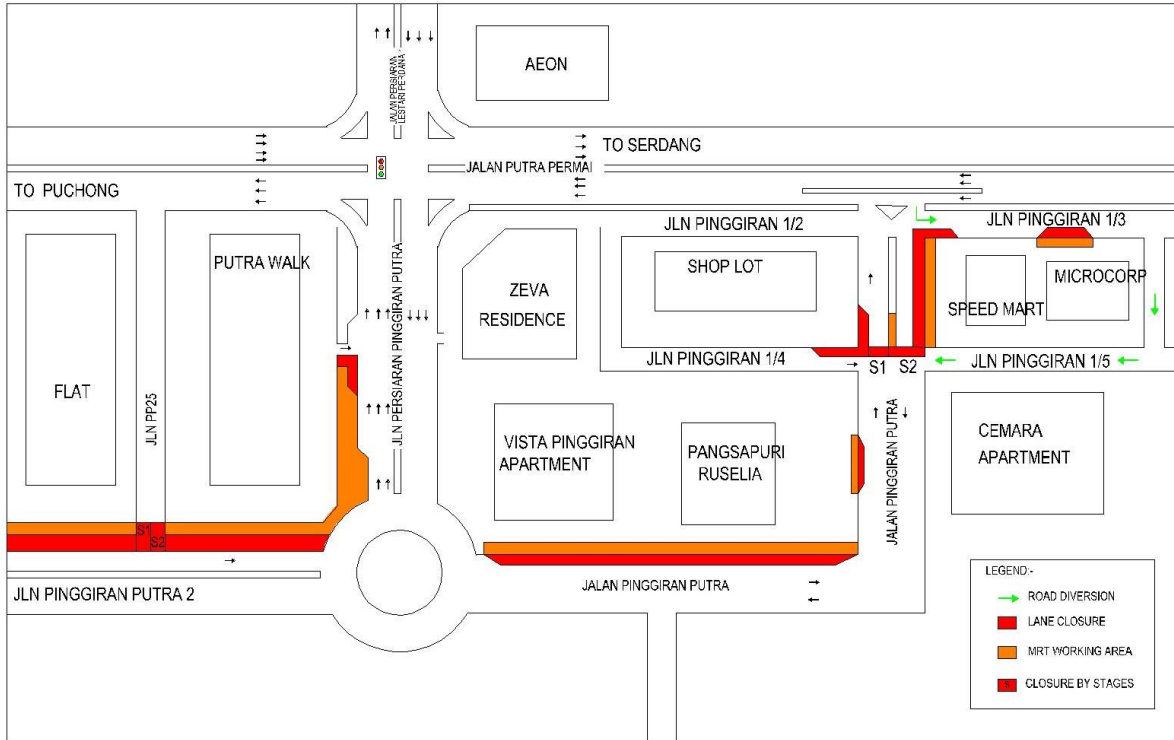

We apologise for any inconvenience caused during this period. Your kind understanding and patience is much appreciated as we are building the MRT SSP Line for our future and to improve KL's public transportation system.

For more information, please contact:

MTD Construction Sdn. Bhd.

En. Mohd Lotfi Abdul Latiff, Senior Manager, PR & Stakeholder Management: 012 - 2100 766

MRT Hotline: 1800 82 6868

www.mymrt.com.my

feedback@mymrt.com.my

WE ARE BUILDING THE MRT SSP LINE FOR OUR FUTURE

THANK YOU

