

TRAFFIC ANNOUNCEMENT
UPDATES ON TRAFFIC MANAGEMENT PLAN FOR MRT SSP CONSTRUCTION
8 DECEMBER 2017

1. CONTINUATION OF INTERMITTENT LANE CLOSURE AT JALAN PUTRA PERMAI (PUCHONG AND SERDANG - BOUND)

Date	11 December 2017 - 31 January 2018
Time	10.00PM - 5.00AM
Duration	45 Days
Reason	To facilitate site Mapping and Piloting, Soil Investigation, Survey, Utilities Relocation and any related works.

There will be 200-meter intermittent lane closure on the right-most lane along Jalan Putra Permai (Puchong and Serdang-bound) from **11 December 2017 until 31 January 2018**. During the closure, one lane will be made available for motorist on both bounds.

The closure will be done in stages as follows (please refer to map):

Jalan Putra Permai heading towards Serdang

S1 - During the lane closure, the left-most lane will be made available for motorist from Jalan Putra Permai heading towards Serdang.

S2 - During the lane closure, the right-most lane will be made available for motorist from Jalan Putra Permai heading towards Serdang.

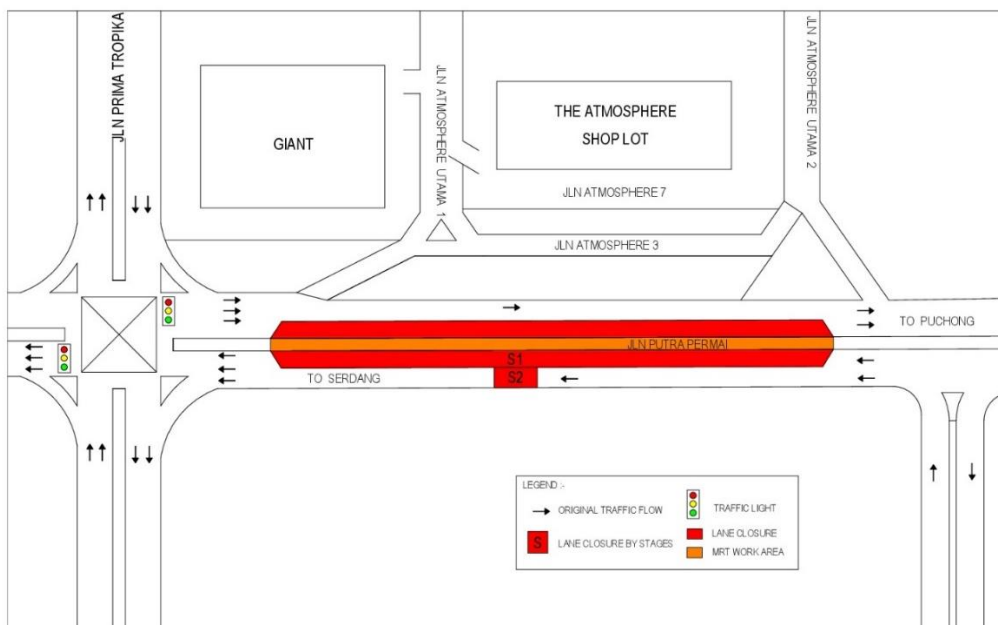

MAP 1: INTERMITTENT LANE CLOSURE AT JALAN PUTRA PERMAI (PUCHONG AND SERDANG - BOUND)

2. CONTINUATION OF FULL SLIP ROAD CLOSURE AT JALAN PUTRA PERMAI AND JALAN PERSIARAN PINGGIRAN PUTRA (PUCHONG-BOUND)

Date	11 December 2017 - 10 January 2018
Time	10.00PM - 6.00AM
Duration	30 Days
Reason	To facilitate site Mapping and Piloting, Soil Investigation, Survey, Utilities Relocation and any related works

There will be a continuation of full slip road closure (Intermittent – Night Work Only) from Jalan Putra Permai to Jalan Persiaran Pinggiran Putra & from Jalan Persiaran Pinggiran Putra to Jalan Putra Permai (Puchong Bound) **11 December 2017 to 10 January 2018, from 10.00pm to 6.00am.**

During the closure, the following diversion will take place;

1. Motorists from Jalan Putra Permai from Serdang/Seri Kembangan heading to Jalan Persiaran Pinggiran Putra will be diverted to drive to the traffic light junction and turn left (as indicated in **GREEN** in map)
2. Motorists from Jalan Persiaran Pinggiran Putra heading to Jalan Putra Permai to Puchong will have to drive all the way to the traffic light junction and turn left (as indicated in **BLUE** in map)

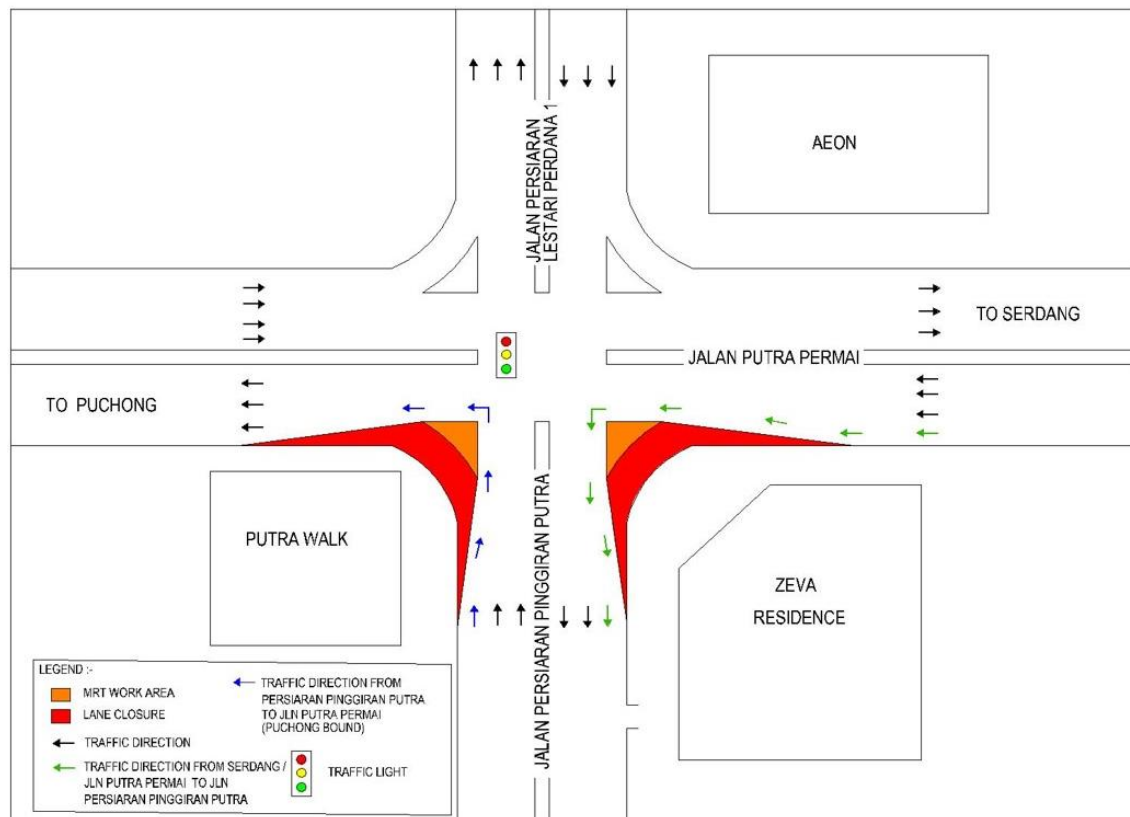

MAP 2: FULL SLIP ROAD CLOSURE AT JALAN PUTRA PERMAI AND JALAN PERSIARAN PINGGIRAN PUTRA (PUCHONG-BOUND)

For media enquiries, please contact:

Mohd Lotfi Abdul Latiff

Tel: +6012 2100 766

Mlotfi@V208.com.my

Leanne Ann Susau

Tel: +603 7493 3832

leanne@mgjv-kvmrt.com.my

MMC GAMUDA KVMRT (PDP SSP) SDN BHD (1117100-V)

Block A, Level 17, Menara Mustapha Kamal, PJ Trade Centre

No 8, Jalan PJU 8/8A, Bandar Damansara Perdana, 47820 Petaling Jaya

Selangor Darul Ehsan, Malaysia

T: +603-7494 2222 F: +603-7727 0222 <http://www.mymrt.com.my>