



NOTICE

PROJEK MASS RAPID TRANSIT LALUAN 2: SUNGAI BULOH – SERDANG – PUTRAJAYA (SSP)

MRT SSP Line Project Construction Activities Along Jalan Sultan Azlan Shah (KL-bound & Kepong-bound) (02 November 2017 – 20 April 2018)

Please be informed that the KVMRT SSP Line construction activities will continue from CIMB to Chai & Chai Trading at Jalan Sultan Azlan Shah (KL-bound & Kepong-bound) starting from **02 November 2017 to 20 April 2018**. The following are the construction activities that will be conducted:

- Utilities relocation
- Any other related works

To facilitate the above-mentioned works, the internal road and parking bays will be closed by stages from **10pm - 6am intermittently**. Meanwhile, the road curb will be closed **24-hours** during this period.

The stages of construction activities include:

Closure A: Jalan Sultan Azlan Shah (KL-bound and Kepong-bound)

- Road shoulder, the internal road & parking bays closure starting from CIMB bank until Papparich (before Jalan Gunung Semanggol).
- Road shoulder, internal road & parking bays closure starting from Universal Studio until Fo Sin Aluminium.

Closure B: Jalan Sultan Azlan Shah (KL-bound and Kepong-bound)

- Road shoulder, internal road & parking bays closure starting from Pos Malaysia (after Jalan Gunung Semanggol) to Chai & Chai Trading (before Jalan Batu Kentonmen).
- Road shoulder, internal road & parking bays closure starting from Jalan Cenderuh until before Universal Studio.

Please refer to the map for further information on the construction works as mentioned above:

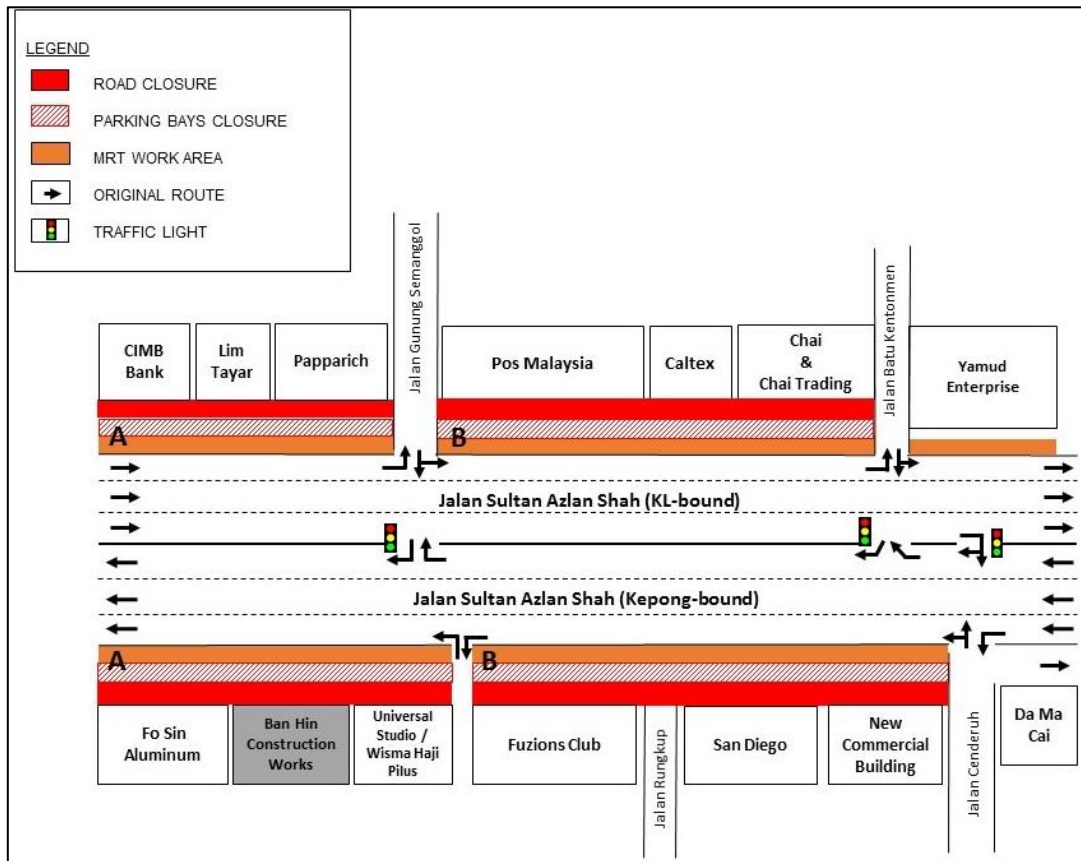

We apologise for any inconvenience caused during this period. Your kind understanding and patience is much appreciated as we are building the MRT SSP Line for our future and to improve KL's public transportation system.

For more information, please contact:-

IJM Construction Sdn. Bhd.

Juliet Choong Wai Gaik, Senior Manager, PR & Stakeholder Management:

012 – 6010 318

Irynn Eng Poh Ling, Manager, PR & Stakeholder Management:

012 – 2289 270

MRT Hotline: 1800 82 6868

www.mymrt.com.my

feedback@mymrt.com.my

**WE ARE BUILDING THE MRT SSP LINE FOR OUR FUTURE
THANK YOU**

