

TRAFFIC ANNOUNCEMENT

UPDATES ON TRAFFIC MANAGEMENT PLAN FOR MRT SSP CONSTRUCTION ALONG JALAN KEPONG, KL-SEREMBAN HIGHWAY, JALAN JINJANG PERMAI 2 AND JALAN JAMBU GAJUS 18 DECEMBER 2017

1. LANE CLOSURES BY STAGES ALONG JALAN KEPONG, METRO PRIMA (SUNGAI BULOH-BOUND)

Date	20 December 2017 - 31 January 2018
Time	10:00pm – 5:00am
Duration	40 days
Reason	To facilitate road widening works for construction of MRT project

There will be lane closures by stages along Jalan Kepong, Metro Prima (Sungai Buloh-bound) **starting 20 December 2017 until 31 January 2018, 10:00pm until 5:00 am, intermittently**. The traffic management involves the following closures:

Closure A: Left-most lane closure for a stretch of 300 metres starting from the junction of Jalan Metro Perdana Barat (former Petronas Taman Usahawan) heading towards AEON Jusco Kepong (Sungai Buloh-bound).

Closure B : Right-most lane closure for a stretch of 300 metres starting from the junction of Jalan Metro Perdana Barat (former Petronas Taman Usahawan) heading towards AEON Jusco Kepong (Sungai Buloh bound).

The closures are **exercised intermittently** and at any one time, there will be two lanes made available for motorists on Sungai Buloh-bound.

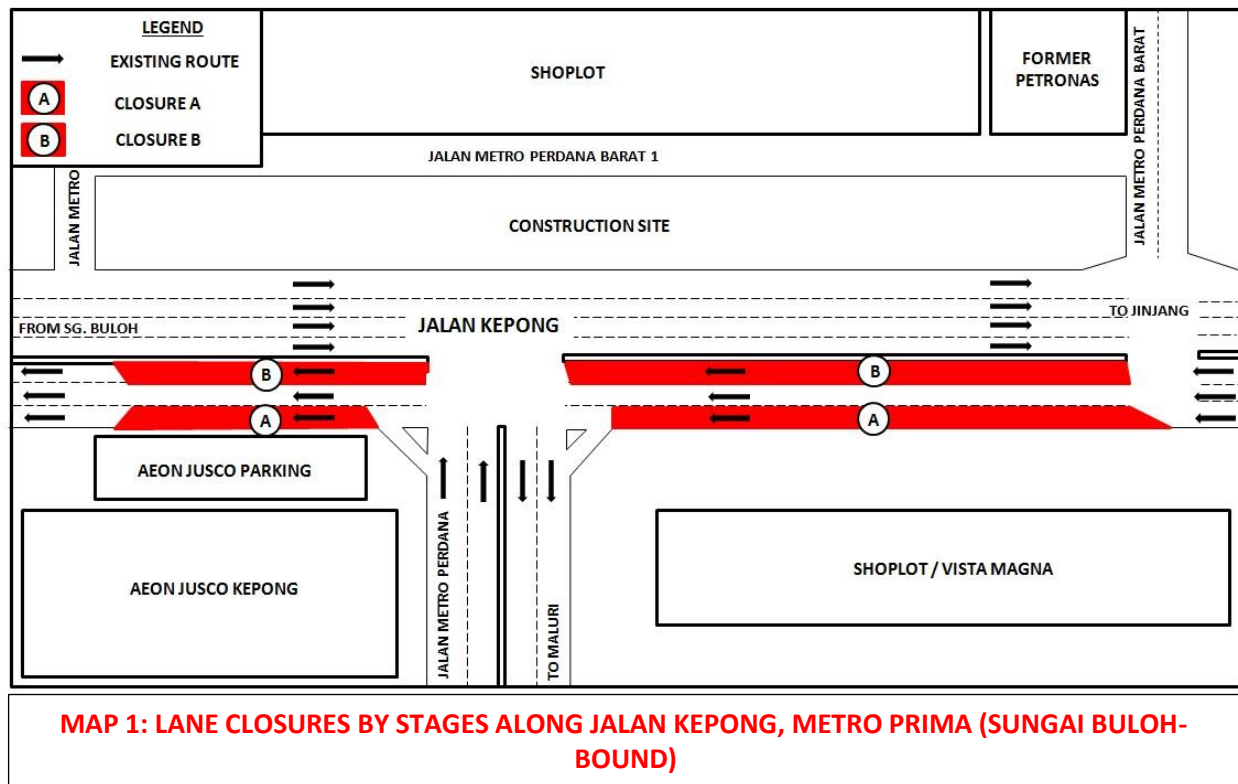

2. LEFT LANE CLOSURE ALONG KUALA LUMPUR - SEREMBAN HIGHWAY D5.0 (SEREMBAN-BOUND)

Date	20 December 2017 - 07 January 2018
Time	10:00PM to 5:00am
Duration	19 days
Reason	To facilitate loading/unloading of material, road realignment, platform preparation, drainage works, soil investigation, bore piling works, pier construction and launching works for construction of MRT SSP Line.

There will be a left lane closure along Kuala Lumpur-Seremban Highway at D5.0 (Seremban-bound) starting **20 December 2017 until 07 January 2018, 10:00pm - 5:00am, daily**.

The closure will start from Gateway Arch along Kuala Lumpur-Seremban Highway for a stretch of 1km. Motorists heading to Seremban will still be able to use the remaining two (2) lanes. During the closure, flagman will be placed to control the traffic flow.

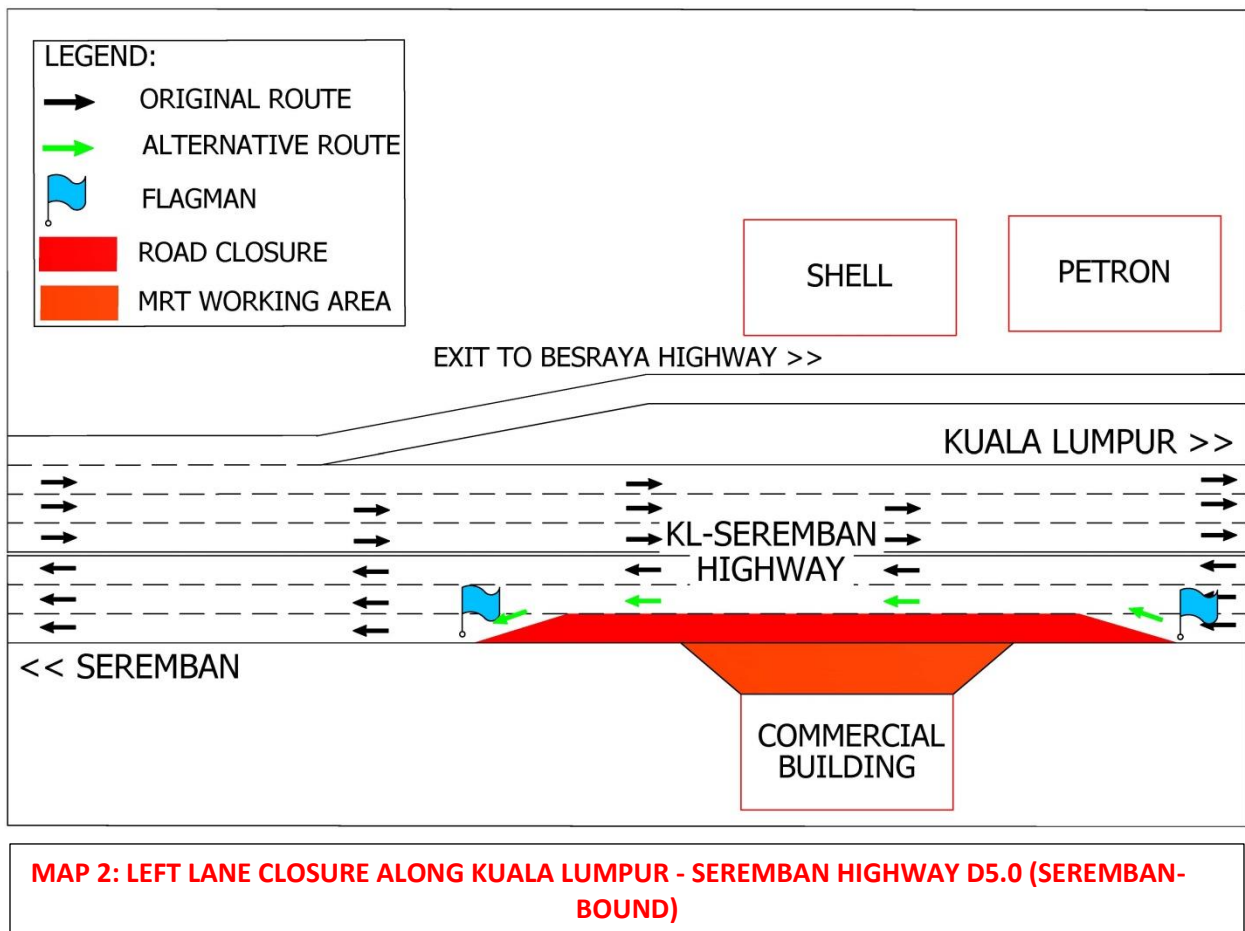

3. CONTINUATION OF NIGHT LANE CLOSURES BY STAGES ALONG JALAN JINJANG PERMAI 2, JALAN JAMBU GAJUS, JALAN KEPONG (KL-BOUND & KEPONG-BOUND)

Date	21 December 2017 – 21 March 2018
Time	10:00pm – 6:00am
Duration	3 months
Reason	To facilitate loading/unloading material, SBG launching and utilities relocation for MRT construction works.

There will be a continuation of night lane closure by stages along Jalan Jinjang Permai 2, Jalan Jambu Gajus, Jalan Kepong (Jinjang Selatan) and Jalan Kepong (KL-bound & Kepong-bound) from **21 December 2017 to 21 March 2018, 10:00pm – 6:00am**. The traffic management plan involves the following closures:

Map 1

Closure A:

- Internal road of Jalan Jinjang Permai 2 starting from Balai Bomba Jinjang to Wisma TNB Kepong.
- Internal road of Jalan Jambu Gajus starting from Sogud Machinery to Secondhand Car Dealer.
- Internal road of Jalan Kepong (Jinjang Selatan) starting from CIMB to Jinjang Funeral Parlor.

Flagman will be in place using "STOP" and "GO" method to indicate the traffic flow.

Closure B: Left lane closure by stages along Jalan Kepong (KL-bound) for a stretch of 250 meters.

Closure C:

- Left lane and middle lane closure by stages along Jalan Kepong (KL-bound) for a stretch of 200 meters.
- Left lane and middle lane closure along Jalan Kepong (Kepong-bound) for a stretch of 80 meters.

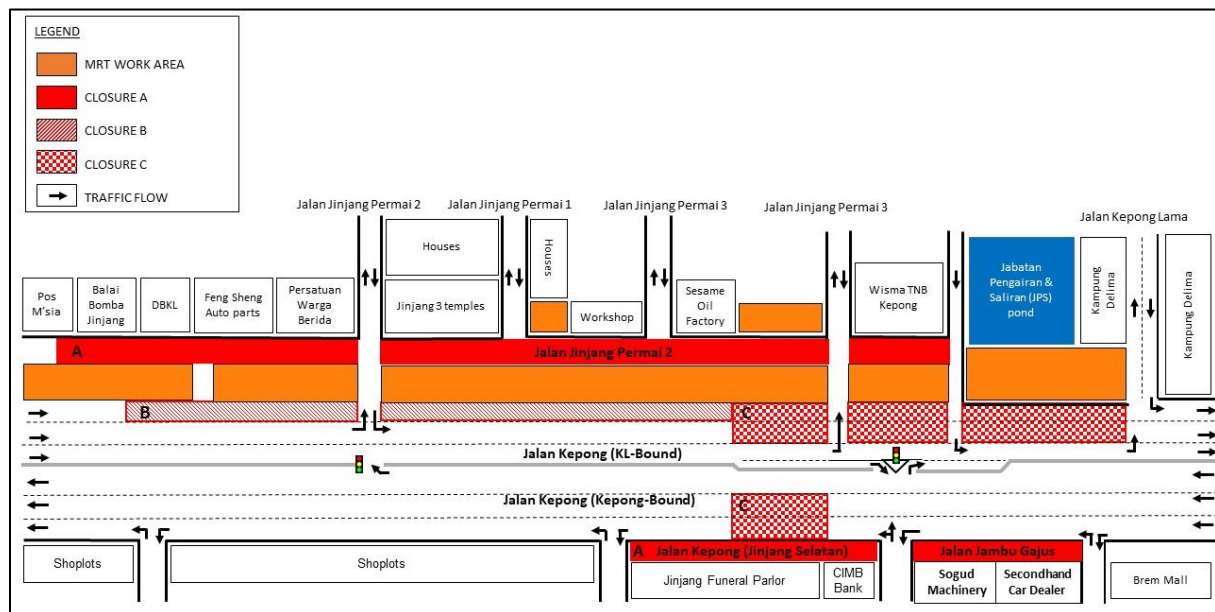

MAP 3 (a) : CONTINUATION OF NIGHT LANE CLOSURES BY STAGES ALONG JALAN JINJANG PERMAI 2, JALAN JAMBU GAJUS, JALAN KEPONG (KL-BOUND & KEPONG-BOUND)

Map 2

Closure D:

- Middle lane and fast lane closure along Jalan Kepong (KL-bound and Kepong-bound) for a stretch of 80 meters.

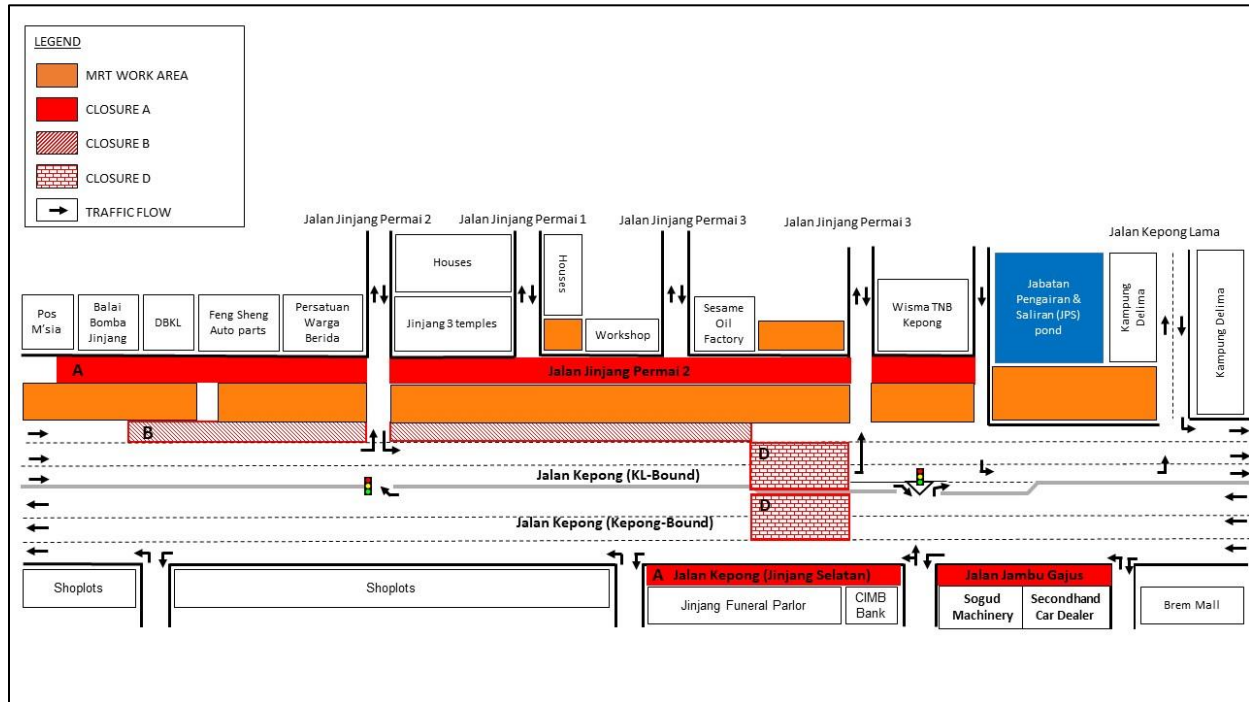

MAP 3 (b) : CONTINUATION OF NIGHT LANE CLOSURES BY STAGES ALONG JALAN JINJANG PERMAI 2, JALAN JAMBU GAJUS, JALAN KEPONG (KL-BOUND & KEPONG-BOUND)

The closures will be implemented **intermittently** and at any one time there will be **one (1) lane made available** for motorists on **both bounds**.

For media enquiries, please contact:

Zaini Ghazali (**Item 1**)

Tel: +6012 328 1821

zainighazali@azrb.com

Anizam bin Ali (**Item 2**)

Tel: +6016 322 1486

anizam.ali@wct.my

Juliet Choong Wai Gaik (**Item 3**)

Tel: +6012 601 0318

julietchoong@ijm.com

Leanne Ann Susau (**Item 1-4**)

Tel: +603 7493 3832

leanne@mgjv-kvmrt.com.my

MMC GAMUDA KVMRT (PDP SSP) SDN BHD (1117100-V)

Block A, Level 17, Menara Mustapha Kamal, PJ Trade Centre

No 8, Jalan PJU 8/8A, Bandar Damansara Perdana, 47820 Petaling Jaya

Selangor Darul Ehsan, Malaysia

T: +603-7494 2222 F: +603-7727 0222 www.mymrt.com.my