



NOTICE

PROJEK MASS RAPID TRANSIT LALUAN 2 : SUNGAI BULOH-SERDANG-PUTRAJAYA (SSP)

Continuation of Temporary Lane Closure in Phases at the Median of Persiaran Sierra Utama

16 October 2017 – 9 December 2017

Please be informed that the KVMRT SSP Line Construction works will be continuing along Persiaran Sierra Utama starting 16 October 2017. Following are the construction activities that will be conducted:

- Piloting Works
- Utilities Relocation Works
- Road Widening Works
- Any other related works

As such, temporary lane closures will be carried out in phases at the median of Persiaran Sierra Utama (See map appended).

Works Duration:

- 16 October 2017 – 9 December 2017
- Monday – Saturday
- (7:00AM – 5:00PM) Normal construction activities
- (5:00PM – 6:00AM) Certain construction activities that require night works (subject to authorities' approval)

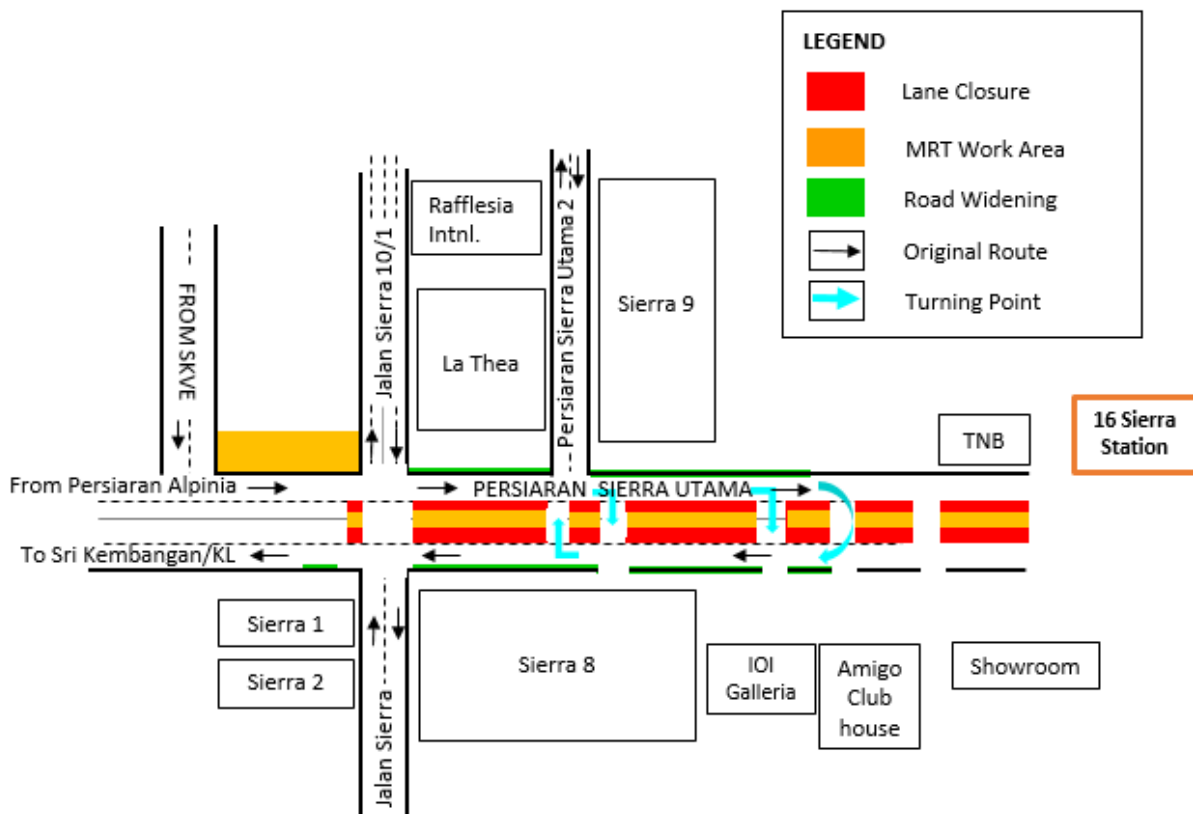

We apologise for any inconvenience caused during this period. Your kind understanding and patience is much appreciated as we are building the MRT SSP Line for our future and to improve KL's public transportation system.

For more information please contact:

Acre Works Sdn. Bhd.

Adeline De Cruz, Senior Manager, PR & Stakeholder Management: 012 - 217 2017

Mohd Ashraf Hafizuddin, Senior Executive, PR & Stakeholder Management: 014 - 228 3574

MRT Hotline: 1800 82 6868

www.mymrt.com.my

feedback@mymrt.com.my

WE ARE BUILDING THE MRT SSP LINE FOR OUR FUTURE THANK YOU

