



NOTICE

PROJEK MASS RAPID TRANSIT LALUAN 2 : SUNGAI BULOH – SERDANG – PUTRAJAYA (SSP)

NIGHT LANE CLOSURES BY STAGES ALONG JALAN KEPONG (KL-BOUND) AND JALAN JAMBU GAJUS

(08 September 2017 – 08 October 2017)

Please be informed that there will be night lane closures by stages along Jalan Kepong (KL-bound) and Jalan Jambu Gajus from **08 September 2017 to 08 October 2017, 10pm - 6am intermittently**.

The traffic management plan involves the following closures:

- **Closure A:** Right lane and middle lane closure by stages along Jalan Kepong (KL-bound) for a stretch of 80 metres. During this closure, the left lane will be made available for motorists on Jalan Kepong (KL-bound).
- **Closure B:** Internal road closure of Jalan Jambu Gajus starting from Sogud Machinery to Secondhand Car Dealer. During the closure, flagman will be in place using "STOP" and "GO" method to indicate the traffic flow.

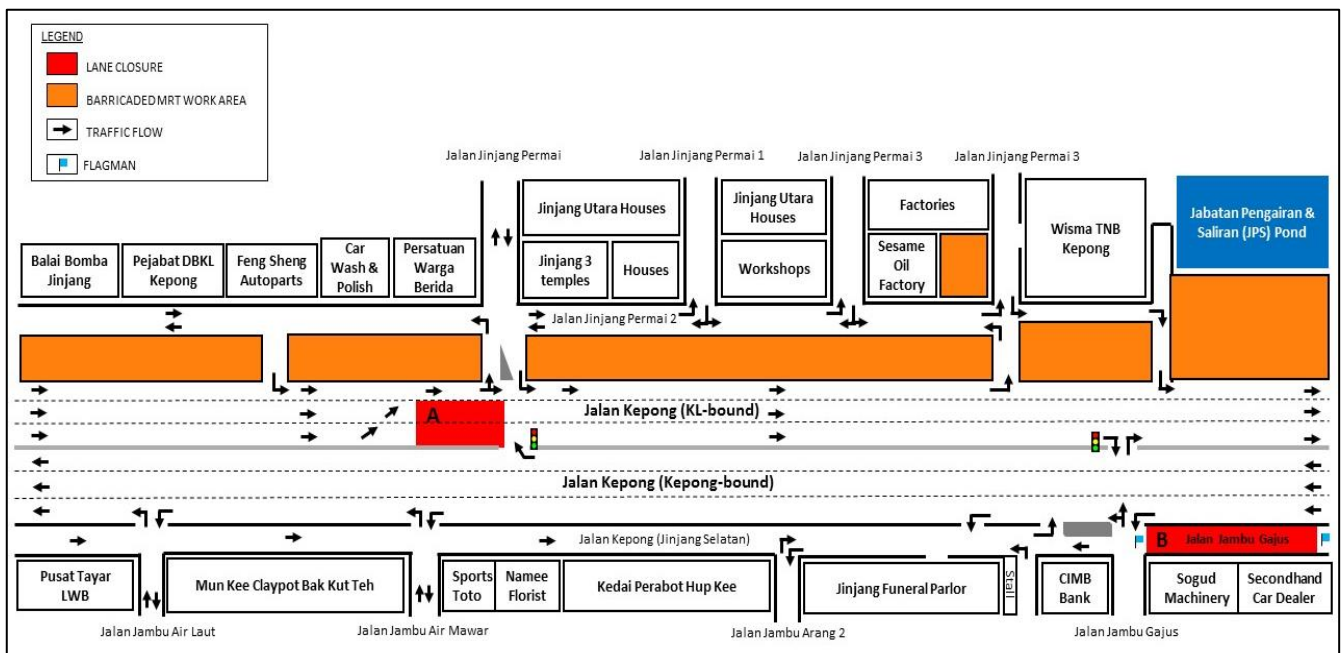

The closures will be implemented to facilitate the loading/unloading of materials, utilities relocation and any other related activities for MRT construction works.

We apologise for any inconvenience caused during this period. Your kind understanding and patience is much appreciated as we are building the MRT SSP Line for our future and to improve KL's public transportation system.

For more information, please contact:-

IJM Construction Sdn. Bhd.

Juliet Choong Wai Gaik, Senior Manager, PR & Stakeholder Management:

012 – 6010 318

Irynn Eng Poh Ling, Manager, PR & Stakeholder Management:

012 – 2289 270

MRT Hotline: 1800 82 6868

www.mymrt.com.my

feedback@mymrt.com.my

**WE ARE BUILDING THE MRT SSP LINE FOR OUR FUTURE
THANK YOU**

