



NOTICE
PROJEK MASS RAPID TRANSIT LALUAN 2 :
SUNGAI BULOH – SERDANG – PUTRAJAYA (SSP)

**Road Realignment and Right-Most Lane Closures Along Jalan Sultan Azlan Shah
(KL-bound and Kepong-bound)
(14 September 2017 – 14 September 2019)**

Please be informed that there will be road realignment works and closure of right-most lane by stages along Jalan Sultan Azlan Shah (KL-bound and Kepong-bound), near Klinik Mediviron from **14 September 2017 onwards, 24-hours**. The traffic management plan involves the following stages:

Stage 1: Jalan Sultan Azlan Shah (KL-bound) from Jalan Batu Kentonmen to Sin Yuan Machinery.

Stage 2: Jalan Sultan Azlan Shah (Kepong-bound) from Jalan Cenderuh to Jalan Cenderuh 1. The road realignment works and closure of right-most lane for Stage 2 **will commence from 14 October 2017 onwards**.

During these closures, there will be three (3) lanes made available for motorists on Jalan Sultan Azlan Shah (KL-bound and Kepong-bound).

Please refer to the map for further reference on the closures mentioned above:

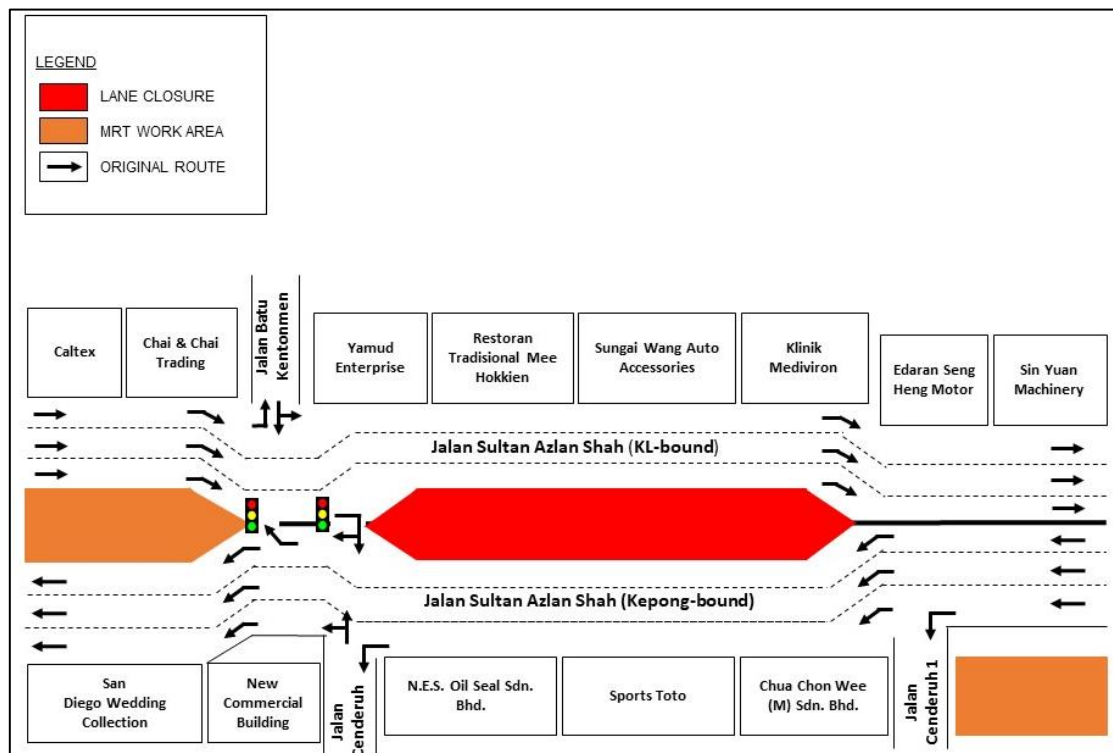

We apologise for any inconvenience caused during this period. Your kind understanding and patience is much appreciated as we are building the MRT SSP Line for our future and to improve KL's public transportation system.

For more information, please contact:-

IJM Construction Sdn. Bhd.

Juliet Choong Wai Gaik, Senior Manager, PR & Stakeholder Management:

012 – 6010 318

Irynn Eng Poh Ling, Manager, PR & Stakeholder Management:

012 – 2289 270

MRT Hotline: 1800 82 6868

www.mymrt.com.my

feedback@mymrt.com.my

**WE ARE BUILDING THE MRT SSP LINE FOR OUR FUTURE
THANK YOU**

