



## NOTICE

### PROJEK MASS RAPID TRANSIT LALUAN 2 : SUNGAI BULOH – SERDANG – PUTRAJAYA (SSP)

#### MRT SSP Line Project Construction Activities Along Jalan Jinjang (29 May 2017 – 2 June 2017)

Please be informed that the KVMRT SSP Line construction works along Jalan Jinjang will continue from **29 May 2017 until 2 June 2017**. The following are the construction activities that will be conducted:

- Utilities Relocation
- Any other related works

#### Duration of work:

- 29 May 2017 – 2 June 2017
- Monday - Saturday
- (7am - 7pm) normal construction activities
- (7pm - 6am) certain construction activities that require night works (subject to authority's approval)

During the closure, motorist using Jalan Jinjang (KL-bound) will be diverted to the opposite lane by flagmen at both ends using "Stop & Go" method of traffic flow (as indicated in **GREEN** arrows in the map below).

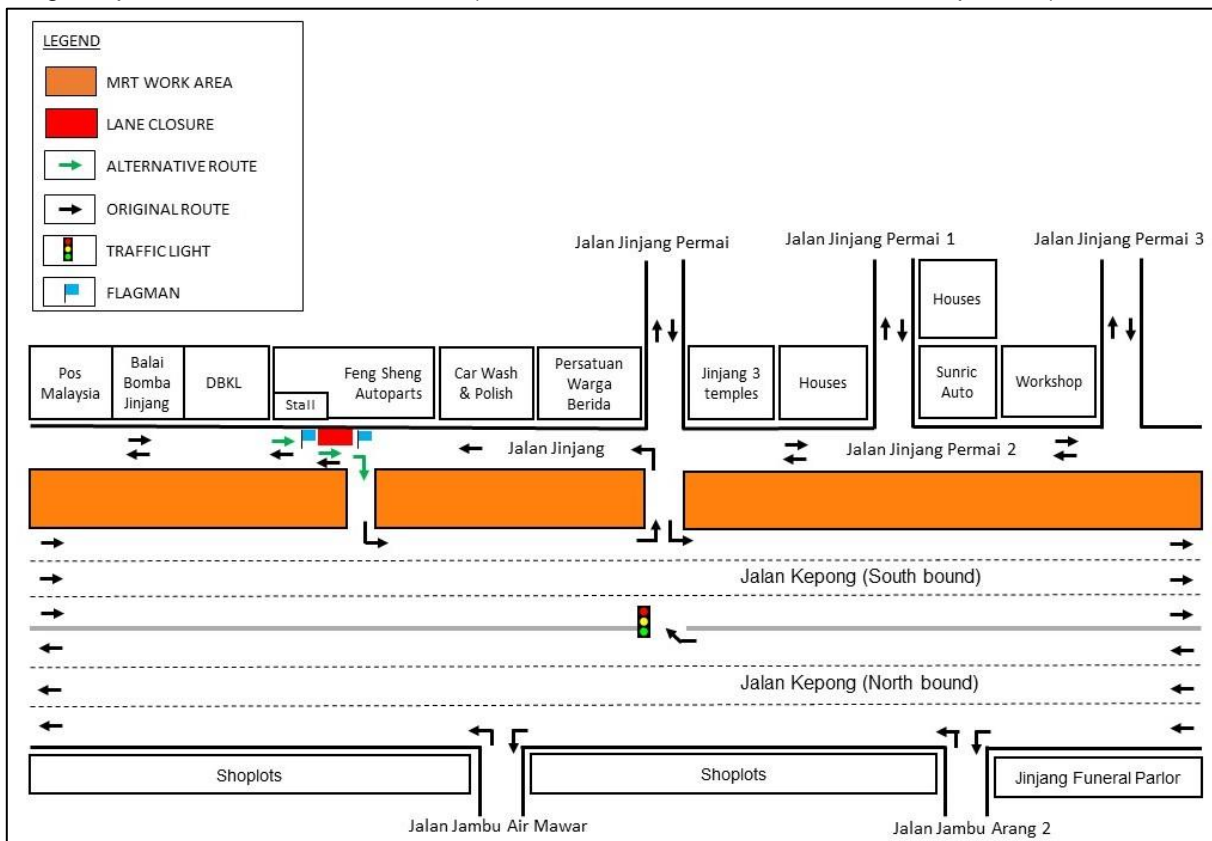

We apologise for any inconvenience caused during this period. Your kind understanding and patience is much appreciated as we are building the MRT SSP Line for our future and to improve KL's public transportation system.

For more information, please contact:-

**IJM Construction Sdn. Bhd.**

Juliet Choong Wai Gaik, Senior Manager, PR & Stakeholder Management:

012 – 6010 318

Irynn Eng Poh Ling, Manager, PR & Stakeholder Management:

012 – 2289 270

MRT Hotline: 1800 82 6868

[www.mymrt.com.my](http://www.mymrt.com.my)

[feedback@mymrt.com.my](mailto:feedback@mymrt.com.my)

**WE ARE BUILDING THE MRT SSP LINE FOR OUR FUTURE  
THANK YOU**

