



NOTICE

PROJEK MASS RAPID TRANSIT LALUAN 2 : SUNGAI BULOH – SERDANG – PUTRAJAYA (SSP)

MRT SSP Line Project Construction Activities at KTM Kampung Batu Station (15 January 2017 - 11 March 2017)

Please be informed that the KVMRT SSP Line construction works will be commencing at KTM Kampung Batu Station starting from **11 January 2017 until 11 March 2017**. The following are the construction activities that will be conducted:

- Piloting
- Soil investigation
- Any other related work

Works Duration:

- 11 January 2017 - 11 March 2017
- Monday – Saturday
- (7am - 7pm) working hours
- (10pm - 6am) certain construction activities that require night works

To facilitate the construction works, there will be closure of motorcycle passageway which currently leading to the motorcycle crossing across KTM Kampung Batu track.

During the closure, an alternative passageway located just next to the closed passageway will be provided for motorist to cross the KTM Kampung Batu track.

Proper signage will be at place to divert the motorist to the alternative route.

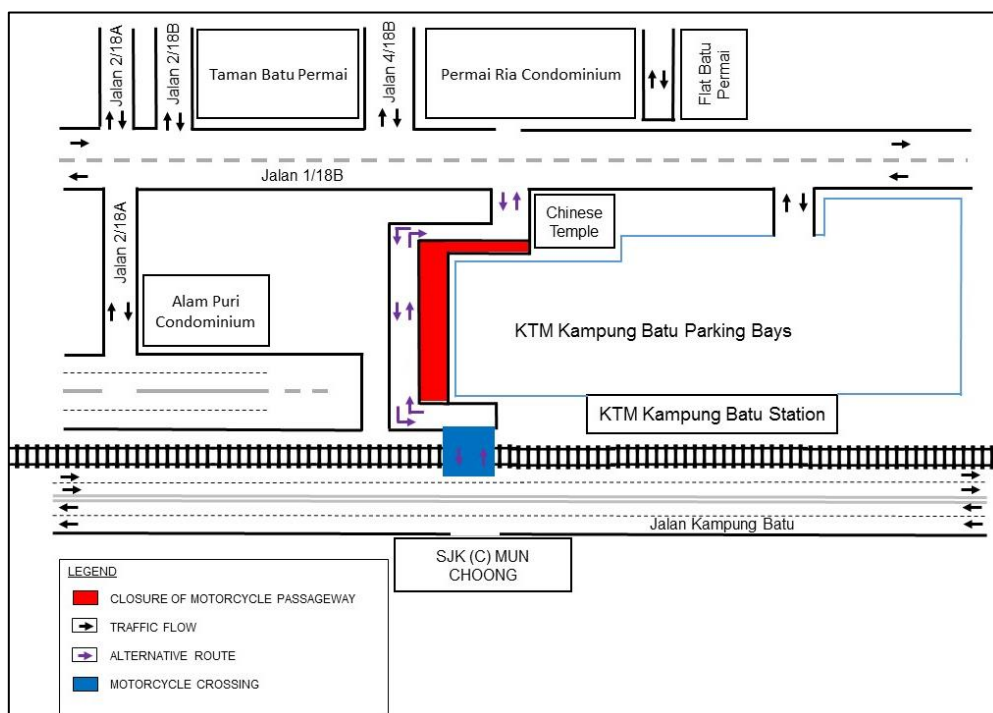

We apologise for any inconvenience caused during this period. Your kind understanding and patience is much appreciated as we are building the MRT SSP Line for our future and to improve KL's public transportation system.

For more information, please contact:-

IJM Construction Sdn. Bhd.

Juliet Choong Wai Gaik, Senior Manager, PR & Stakeholder Management: 012 – 6010 318

Irynn Eng Poh Ling, Manager, PR & Stakeholder Management: 012 – 2289 270

MRT Hotline: 1800 82 6868

www.mymrt.com.my

feedback@mymrt.com.my

**WE ARE BUILDING THE MRT SSP LINE FOR OUR FUTURE
THANK YOU**

