

MEDIA RELEASE

TEMPORARY PARTIAL CLOSURES OF SLIP ROAD AT JALAN CHERAS HARTAMAS AND LEFT-MOST LANE AT GRAND SAGA HIGHWAY

Kuala Lumpur, 23 November 2013: Mass Rapid Transit Corporation Sdn Bhd (MRT Corp) wishes to announce the following temporary closures:

- i) Partial closure of slip road to/from Jalan Cheras Hartamas
- ii) Partial left-most lane closure on Cheras-Kajang (Grand Saga) Highway, Batu 7 Cheras

The closures will be implemented beginning **25 November 2013 to 9 December 2013, for 24-hours daily.** (Please see appended map.)

The closures are to facilitate utility relocation works for the Klang Valley MRT Sungai Buloh-Kajang Line.

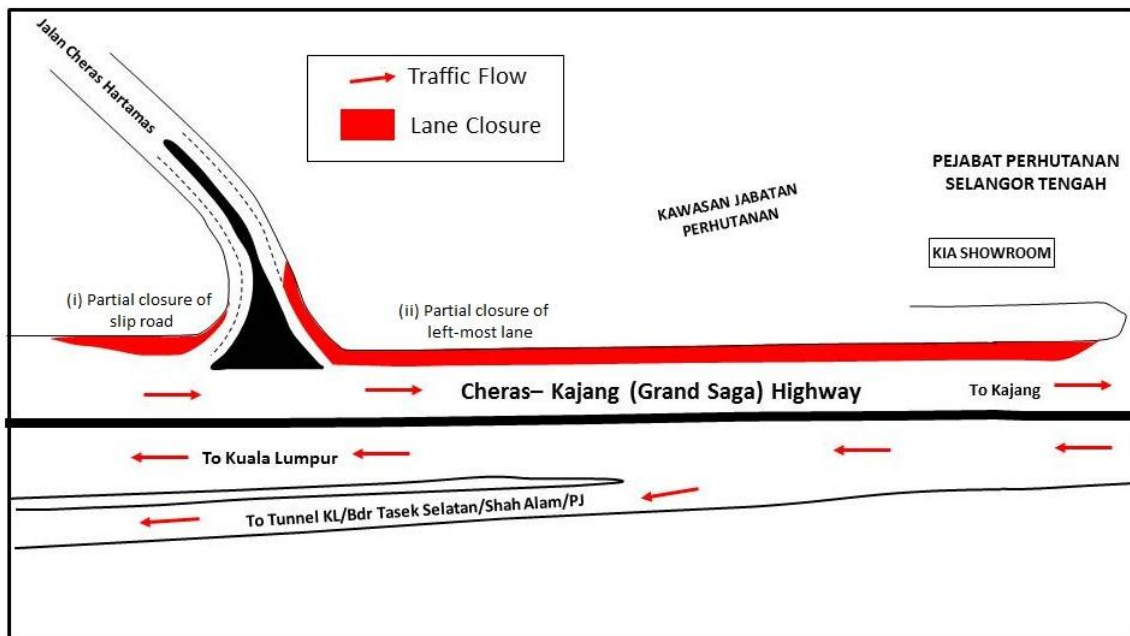

ENDS



About the MRT Project

MRT is a new rail transport system for the Klang Valley. It is part of the government's Greater Kuala Lumpur/Klang Valley's National Key Economic Area (NKEA), under the Economic Transformation Programme. The Sungai Buloh – Kajang (SBK) Line runs for 51kms, from the north-west town of Sg Buloh to the south-east city town of Kajang. Upon completion, it will comprise 31 stations, and serve 1.2 million people along the route. It will also have strategic integration with KL's existing rail transport network, namely the LRT, Monorail and KTM Komuter, as well as intra and inter-city bus routes. The end result will be better connectivity for KL and its surrounding cities, while reducing the number of cars that enter the capital.

MRT Corp wishes to apologise for any temporary inconvenience caused to the public during the construction of this world-class public transport facility that will benefit Malaysians at large. For more information on traffic diversion, the public can visit the MRT website at www.mymrt.com.my or www.mymrt-underground.com.my, twitter @MRTMalaysia or twitter @MyMRT Underground or call the MRT Hotline at 1-800-82-6868.

Motorists are reminded to drive carefully near MRT worksites and to follow directional signs. Safety barriers, hoardings and traffic cones will be installed at the work sites to ensure road users and pedestrians are well-informed of on-going works. In addition, a 24-hour MRT Ronda will be patrolling along the routes to attend to any emergencies.

For media enquiries, please contact:

Mrs. Ong Jee Lian
MMC-Gamuda KVMRT (PDP) Sdn Bhd

03-74933963 / jeelian@mgjv-kvmrt.com.my

Ms. Nadia Azmi
MRT Corp

03-20813185 / nadia.azmi@mymrt.com.my