

MEDIA RELEASE

TEMPORARY PARTIAL NIGHT LANE CLOSURE AT JALAN CHERAS

Kuala Lumpur, 14 October 2013: Mass Rapid Transit Corporation Sdn Bhd (MRT Corp) wishes to announce the temporary partial night lane closure at Jalan Cheras, heading towards Jalan Pudu from 18 October 2013 to 7 November 2013, between 10:00pm and 5:00am daily.

This closure is to facilitate grouting work for the MRT Maluri underground station. The one lane closure involves a 20-metre stretch, located just after the traffic light near Menara PGRM. (Please see appended map.)

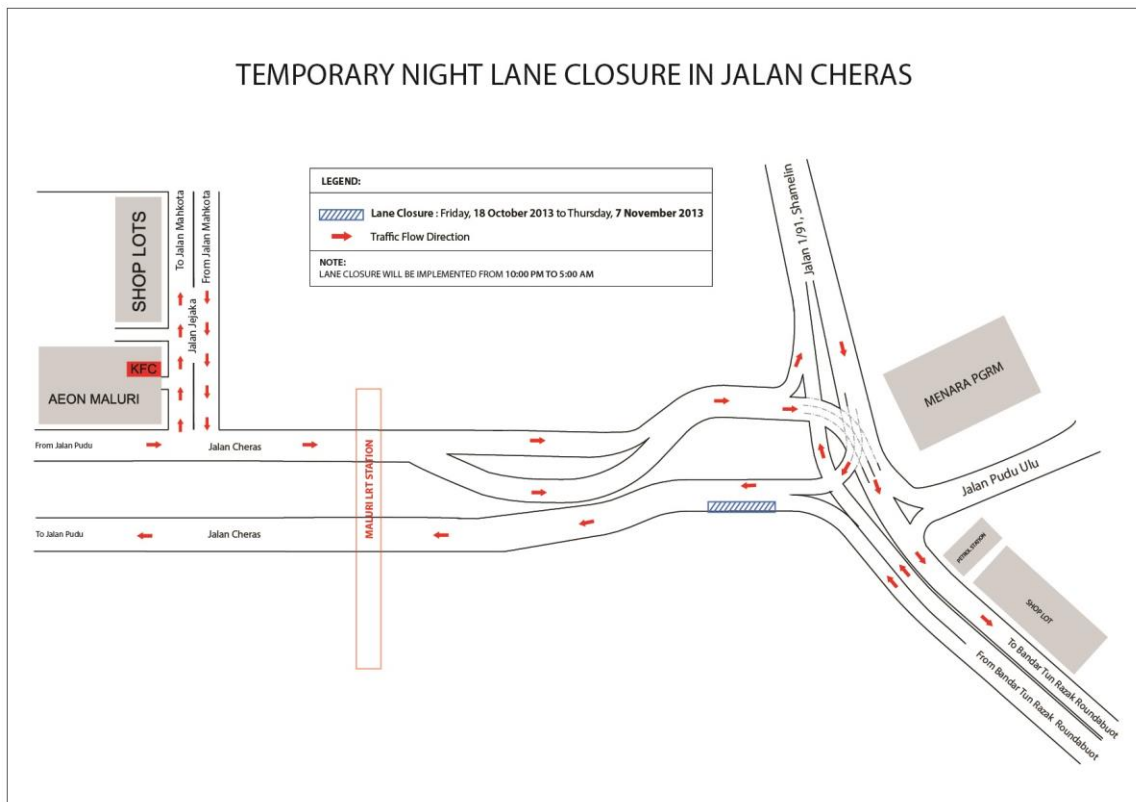

ENDS



About the MRT Project

MRT is a new rail transport system for the Klang Valley. It is part of the government's Greater Kuala Lumpur/Klang Valley's National Key Economic Area (NKEA), under the Economic Transformation Programme. The Sungai Buloh – Kajang (SBK) Line runs for 51kms, from the north-west town of Sg Buloh to the south-east city town of Kajang. Upon completion, it will comprise 31 stations, and serve 1.2 million people along the route. It will also have strategic integration with KL's existing rail transport network, namely the LRT, Monorail and KTM Komuter, as well as intra and inter-city bus routes. The end result will be better connectivity for KL and its surrounding cities, while reducing the number of cars that enter the capital.

MRT Corp wishes to apologise for any temporary inconvenience caused to the public during the construction of this world-class public transport facility that will benefit Malaysians at large. For more information on traffic diversion, the public can visit the MRT website at www.mymrt.com.my or www.mymrt-underground.com.my, twitter @MRTMalaysia or twitter @MyMRT Underground or call the MRT Hotline at 1-800-82-6868.

For media enquiries, please contact:

Ms. Jalina Joheng
MMC-Gamuda KVMRT (T) Sdn Bhd

03-23858625 / jalina@kvmrt-ug.com.my

Ms. Nadia Azmi
MRT Corp

03-20813185 / nadia.azmi@mymrt.com.my