



## MEDIA RELEASE

# CONTINUATION OF TEMPORARY ROAD CLOSURE AT JALAN 16/11 (Next to Sprint Highway)

**Kuala Lumpur, 19 September 2013:** Mass Rapid Transit Corporation Sdn Bhd (MRT Corp) wishes to announce that the temporary road closure at Jalan 16/11 (next to Sprint highway) (PJ-bound) will resume starting **21 September 2013 to 7 October 2013**.

This temporary closure will be implemented in stages as follows:

**i. One lane closure (left-most lane) at Jalan 16/11**

This closure is in front of the former BHP Petrol Station which will be in place **Monday to Friday from 5:00am to 10:00pm**.

**ii. Full road closure at Jalan 16/11**

This closure is at the Jalan Dato' Abu Bakar traffic light junction and Pusat Phileo Damansara which will be in place as follows:

**(a) Mondays to Fridays - 10:00pm to 5:00am**

**(b) Saturdays and Sundays - 24 hours**

The closure is necessary to facilitate utilities and gas pipe relocation works in front of the former BHP petrol station. In the best interest of public safety and in anticipation of the heavy traffic during peak hours at Jalan 16/11, the closure will be implemented in stages. One lane will be made available for motorists during peak hours on the weekdays.

On weeknights and weekends, a full road closure will be implemented at Jalan 16/11. As such, motorists heading towards PJ on Jalan 16/11 will be diverted to the left-most lane, up the ramp alongside Eastin Hotel before connecting back to the main road.

Traffic at this stretch during this temporary closure period will be managed by Propel and traffic flagmen, to ensure minimal traffic backlog at Jalan 16/11 and Jalan Abu Bakar.

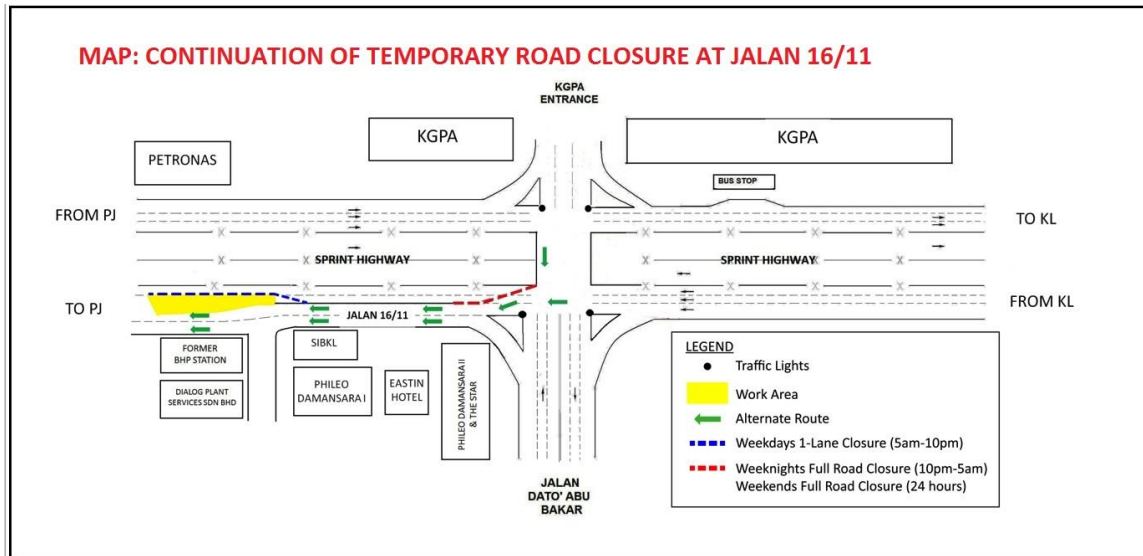

The closure is a key part of our safety practice at all MRT construction sites. It will ensure that any risk of public injury is minimised. Motorists are reminded to drive carefully near MRT worksites and to follow directional signs. Safety barriers, hoardings and traffic cones will be installed at the work sites to ensure road users and pedestrians are well-informed of on-going works. In addition, a 24-hour MRT Ronda will be patrolling along the routes to attend to any emergencies.

MRT Corp wishes to apologise for any temporary inconvenience caused to the public during the construction of this world-class public transport facility that will benefit Malaysians at large.

The Sungai-Buloh Kajang Line will comprise 31 stations, and serve 1.2 million people along the route. It will also have strategic integration with KL's existing rail transport network, namely the LRT, Monorail and KTM Komuter, as well as intra and inter-city bus routes. The end result will be better connectivity for KL and its surrounding cities, while reducing the number of cars that enter the capital.

For more information on traffic diversion, the public can visit the MRT website at [www.mymrt.com.my](http://www.mymrt.com.my) or [www.mymrt-underground.com.my](http://www.mymrt-underground.com.my), twitter @MRTMalaysia or twitter @MyMRT Underground or call the MRT Hotline at 1-800-82-6868.

**ENDS**



*For media enquiries, please contact:*

**Mrs. Ong Jee Lian**  
MMC-Gamuda KVMRT (PDP) Sdn Bhd

03-74933963 / [jeelian@mgjv-kvmrt.com.my](mailto:jeelian@mgjv-kvmrt.com.my)

**Ms. Nadia Azmi**  
MRT Corp

03-20813185 / [nadia.azmi@mymrt.com.my](mailto:nadia.azmi@mymrt.com.my)