

MEDIA RELEASE

TRAFFIC MANAGEMENT ANNOUNCEMENT

Kuala Lumpur, 5 July 2013: Mass Rapid Transit Corporation Sdn Bhd (MRT Corp) wishes to announce the implementation of the following traffic management plans:

i. Trial closure of lane at slip road from Pusat Bandar Damansara

The right-most lane of the slip road from Pusat Bandar Damansara (Jalan Damansuria) into Sprint Highway (PJ-bound) for a distance of 450 metres will undergo a trial closure for a period of one (1) week from **8 July 2013 to 14 July 2013**. *(Please see appended Map 1.)*

The trail is being implemented to allow MRT Corp and authorities to monitor the impact on traffic during the construction of the MRT piers and tracks together with the future Pusat Bandar Damansara MRT Station and Semantan MRT Station.

If the trial closure is successful, this stretch will be temporarily closed for one year.

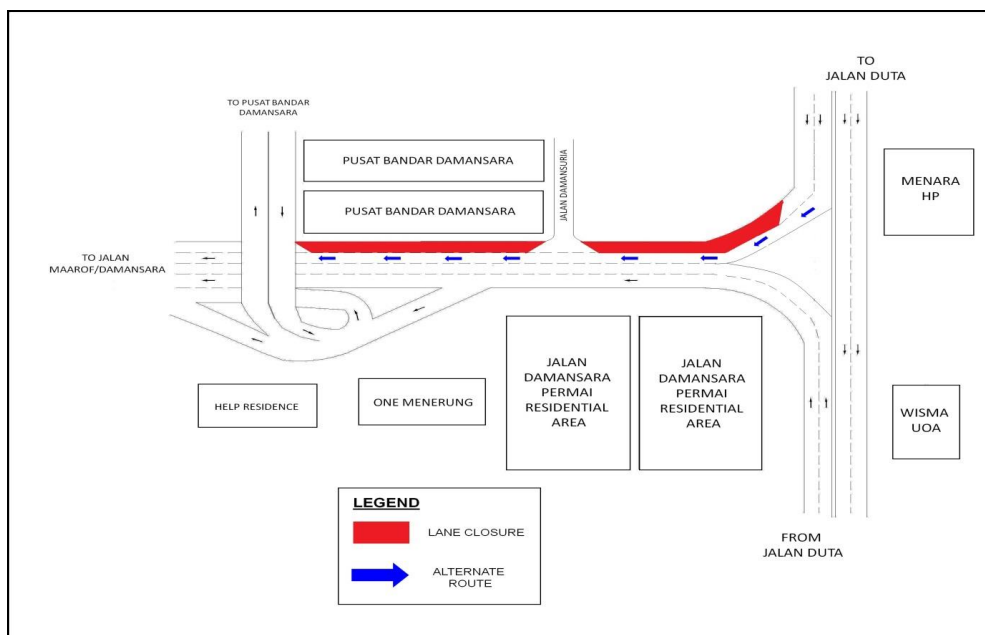

Map 1: Trial closure of lane at slip road from Pusat Bandar Damansara

ii. Slip road lane closure at Jalan Semantan

The **left-most lane** of the slip road leading from Jalan Beringin to Jalan Semantan (KL-bound) in front of Menara HP and Wisma UN, for a distance of 200 metres, will be closed from **10:00am to 4:00pm** and from **9:00pm to 5:00am daily** for six (6) months from **8 July 2013 to 8 December 2013**. (Please see appended Map 2.)

This closure follows the successful trial closure which was carried out in June. The traffic management plan has been approved by the authorities and the highway concessionaire.

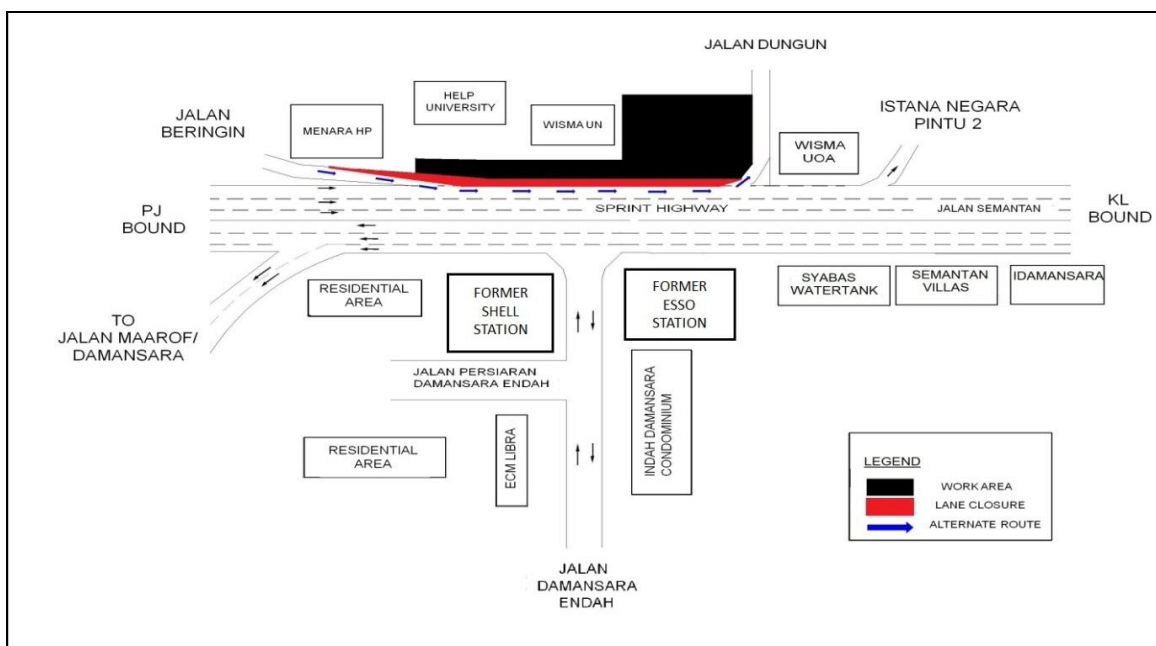

Map 2: Slip road lane closure at Jalan Semantan

iii. Temporary night partial lane closure in Jalan Damansara

Temporary partial lane closures will be carried out in Jalan Damansara in front of Muzium Negara between **11:00pm to 5:00am** from **8 July 2013 to 28 July 2013**. Both City Centre-bound and Bangsar-bound lanes will be involved. (Please see appended Map 3.)

The closure will be implemented in stages across the lanes, **with only one lane closed at any one time**.

The temporary closure is to facilitate piloting works in preparation for utilities relocation work. Traffic movement is not expected to be affected over the 21-day period as the partial closures will be done late at night into the early hours of the next day.

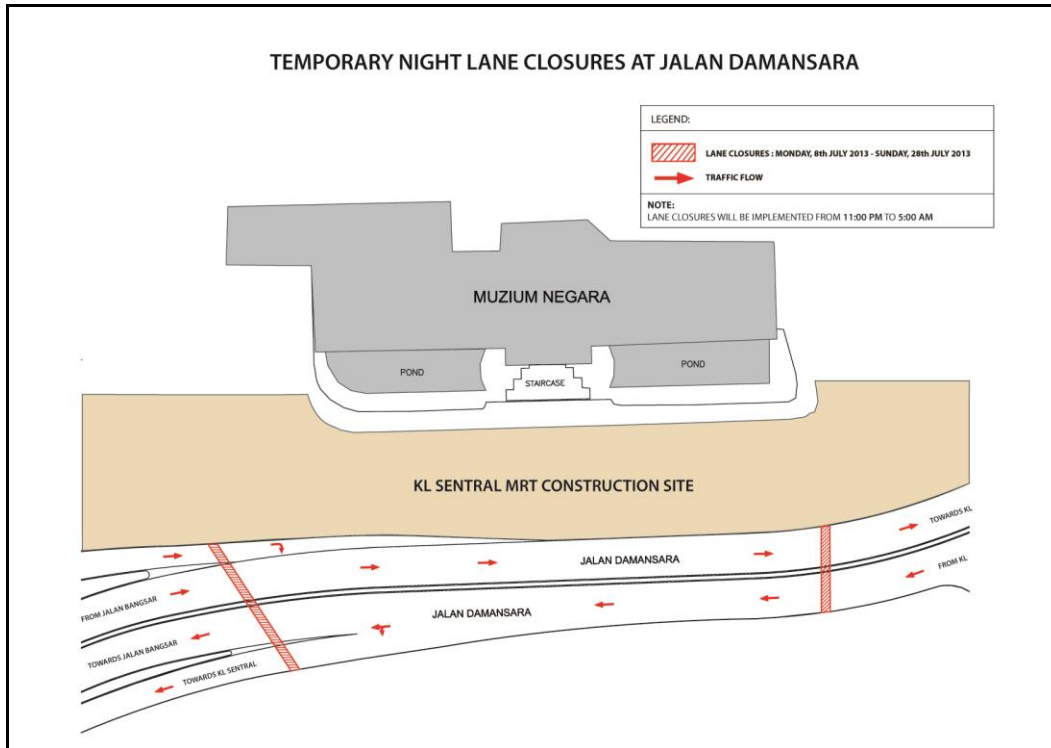

Map 3: Temporary night partial lane closure in Jalan Damansara

The closures are a key part of our safety practice at all MRT construction sites. It will ensure that any risk of public injury is minimised. Motorists are reminded to drive carefully near MRT worksites and to follow directional signs. Safety barriers, hoardings and traffic cones will be installed at the work sites to ensure road users and pedestrians are well-informed of on-going works. In addition, a 24-hour MRT Ronda will be patrolling along the routes to attend to any emergencies.

MRT Corp wishes to apologise for any temporary inconvenience caused to the public during the construction of this world-class public transport facility that will benefit Malaysians at large.

The Sungai-Buloh Kajang Line will comprise 31 stations, and serve 1.2 million people along the route. It will also have strategic integration with KL's existing rail transport network, namely the LRT, Monorail and KTM Komuter, as well as intra and inter-city bus routes. The end result



will be better connectivity for KL and its surrounding cities, while reducing the number of cars that enter the capital.

For more information on traffic diversion, the public can visit the MRT website at www.mymrt.com.my or www.mymrt-underground.com.my, twitter @MRTMalaysia or twitter @MyMRT Underground or call the MRT Hotline at 1-800-82-6868.

For media enquiries, please contact:

Mrs. Ong Jee Lian
MMC-Gamuda KVMRT (PDP) Sdn Bhd

03-74933963 / jeelian@mgjv-kvmrt.com.my

Ms. Jalina Joheng
MMC-Gamuda KVMRT (T) Sdn Bhd

03-23858625 / jalina@kvmrt-ug.com.my

Ms. Nadia Azmi
MRT Corp

03-20953861 / nadia.azmi@mymrt.com.my