

MEDIA RELEASE

PARTIAL LANE/ROAD CLOSURES FOR MRT PROJECT

Kuala Lumpur, 19 June 2013: Mass Rapid Transit Corporation Sdn Bhd (MRT Corp) wishes to announce temporary partial road/lane closures at the following locations:

i. Jalan Bukit Bintang

There will be a temporary partial night road closure on Jalan Bukit Bintang from 23 June 2013 to 24 June 2013, from 10:00pm to 6:00am. This closure is in front of the former Porsche showroom, just before the LTAT building. The 100-metre closure is to facilitate road works. (Please see appended Map 1.)

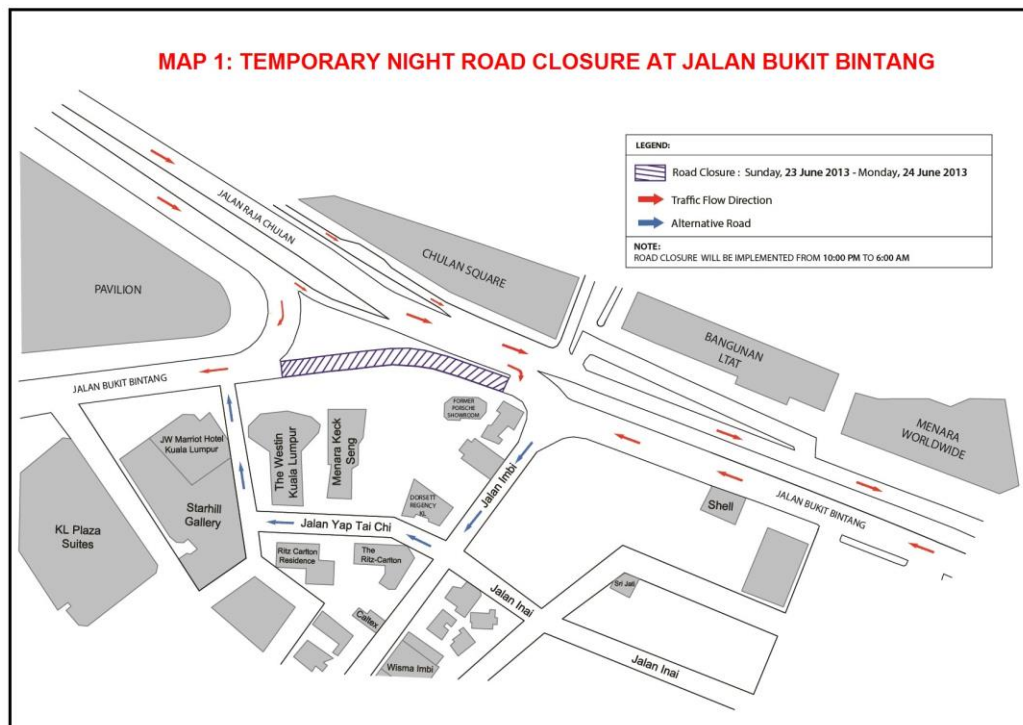

Map 1

ii. Cheras-Kajang (Grand Saga) Highway (Extension of closures)

There will be two extensions of partial lane closures on the Cheras-Kajang (Grand Saga) Highway, near Exit 702 of the Hulu Langat interchange (Kajang-bound):

a) Left-most lane

A partial lane closure of the slip road which was previously implemented from 9 June 2013 to 14 June 2013 is now extended to **6 July 2013**. (Please see appended Map 2.)

MAP 2: PARTIAL CLOSURE OF LEFT-MOST LANE ON CHERAS-KAJANG (GRAND SAGA) HIGHWAY
14 June 2013 - 6 July 2013

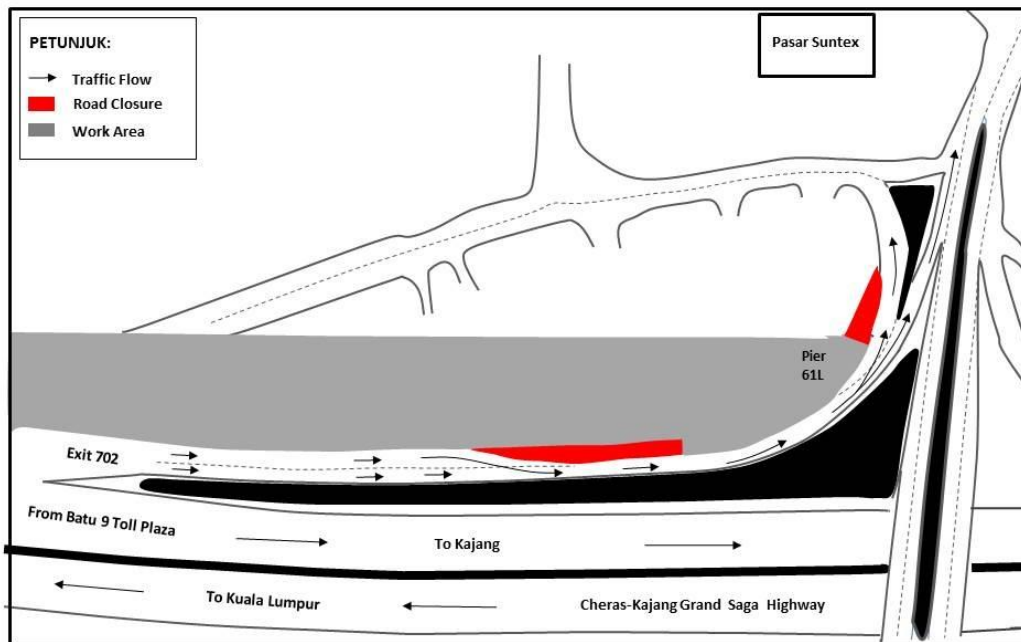

Map 2

b) Right-most lane

A partial closure of the right-most lane of the highway slip road which was previously implemented from 14 June 2013 to 22 June 2013 is now extended to **6 July 2013**. (Please see appended Map 3.)

MAP 3: PARTIAL CLOSURE OF RIGHT-MOST LANE ON CHERAS-KAJANG (GRAND SAGA) HIGHWAY
 22 June 2013 - 6 July 2013

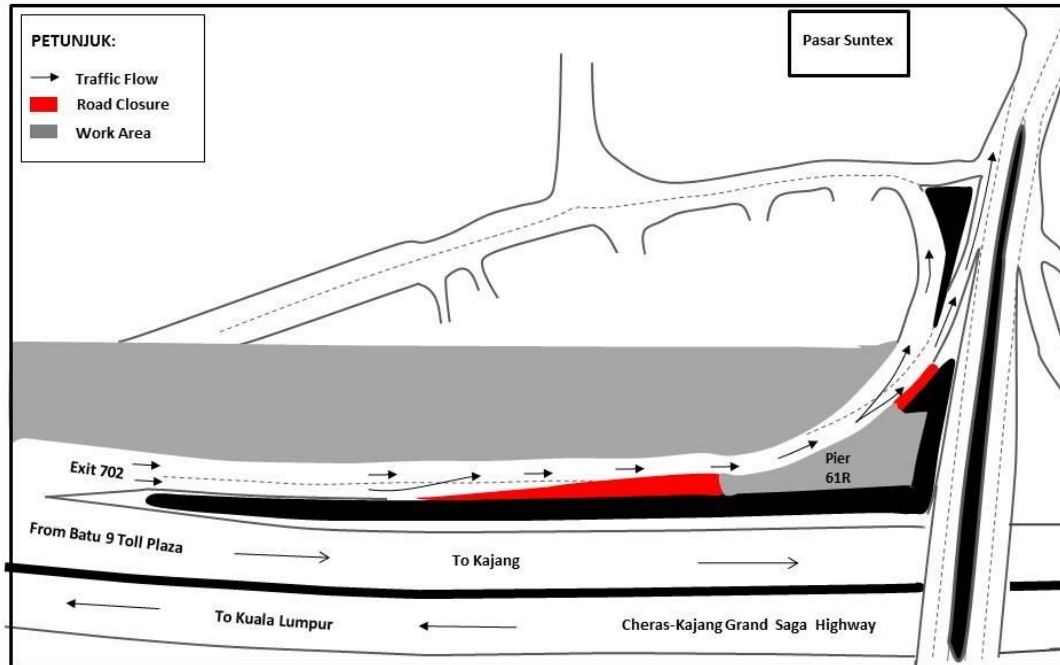

Map 3

The temporary closures are necessary to facilitate preparation works for the construction of MRT piers. The closures involve a comprehensive traffic management plan that has been studied by Cheras-Kajang (Grand Saga) Highway and Lembaga Lebuhraya Malaysia (LLM) so that measures can be taken to minimise disruption to traffic.

iii. SPRINT Highway (KL-bound)

The left-most lane will undergo a 24-hour trial closure for a period of one (1) week from **24 June 2013 to 30 June 2013**.

This trial closure is intended to allow MRT Corp and its contractors to study the impact of the closure on the traffic flow at SPRINT Highway (KL-bound). If the trial closure shows minimal adverse impact towards traffic, a permanent road closure will take place for a period of five (5) months. This 100-metre closure is necessary to facilitate bore piling, pile capping and pier works for the construction of the future Section 16 MRT station and MRT piers. *(Please see appended Map 4.)*

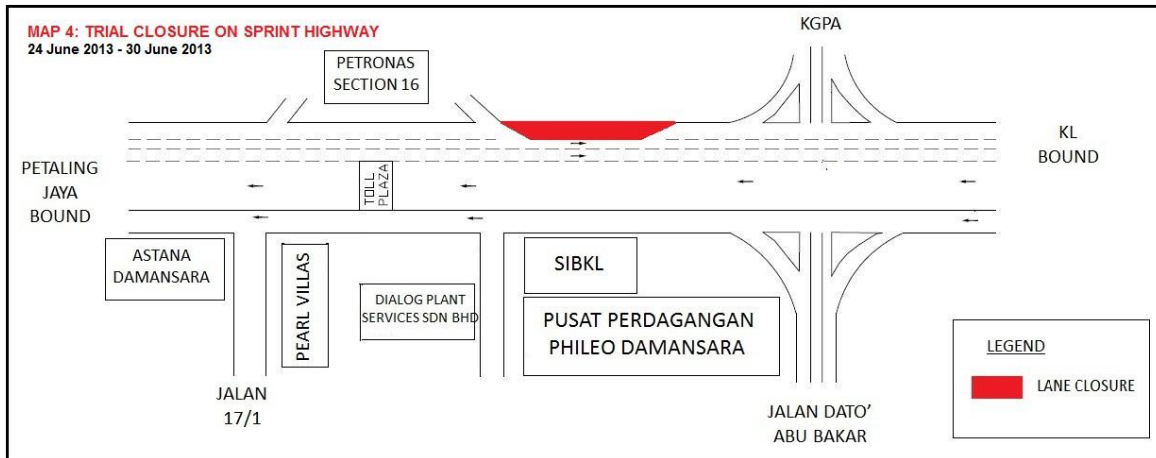

Map 4

The closures are a key part of our safety practice at all MRT construction sites. It will ensure that any risk of public injury is minimised. Motorists are reminded to drive carefully near MRT worksites and to follow directional signs.

Safety barriers, hoardings and traffic cones will be installed at the work sites to ensure road users and pedestrians are well-informed of on-going works. In addition, a 24-hour MRT Ronda will be patrolling along the routes to attend to any emergencies.

MRT Corp wishes to apologise for any temporary inconvenience caused to the public during the construction of this world-class public transport facility that will benefit Malaysians at large.

The Sungai-Buloh Kajang Line will comprise 31 stations, and serve 1.2 million people along the route. It will also have strategic integration with KL's existing rail transport network, namely the LRT, Monorail and KTM Komuter, as well as intra and inter-city bus routes. The end result will be better connectivity for KL and its surrounding cities, while reducing the number of cars that enter the capital.

For more information on traffic diversion, the public can visit the MRT website at www.mymrt.com.my or www.mymrt-underground.com.my, twitter @MRTMalaysia or twitter @MyMRT Underground or call the MRT Hotline at 1-800-82-6868.



For media enquiries, please contact:

Mr. Leong Shen-Li
MRT Corp

03-20953862 / leong.shen-li@mymrt.com.my

Ms. Nadia Azmi
MRT Corp

03-20953861 / nadia.azmi@mymrt.com.my