

TRAFFIC ANNOUNCEMENT
CONTINUATION OF LANE CLOSURES ALONG LEBUHRAYA PINTASAN DENGKIL
(PERSIMPANGAN PUTRAJAYA SENTRAL)
06 DECEMBER 2017

Date	08 December 2017 – 31 March 2018
Time	24 hours
Duration	3 months 22 days
Reason	To facilitate road widening, traffic diversion, piloting, installation of sheet pile, TNB & CCTV relocation, construction of portal beam and any other construction works for MRT Project

There will be continuation of lane closures along Lebuhraya Pintasan Dengkil heading towards Persimpangan Putrajaya Sentral from **08 December 2017 to 31 March 2018**.

The traffic management plan involves the following stages:

Closure A: One lane closure for a stretch of 100 metres heading towards Taman DeCare, Putrajaya. Motorists from Presint 7 Putrajaya heading to Taman DeCare will be diverted to the opposite lane by flagman (as indicated in **GREEN** arrows in the map).

Closure B: Slip road closure of the ramp going down to Taman DeCare Putrajaya. Motorists will be diverted to Taman DeCare exit to get to Presint 7 Putrajaya and Taman DeCare Putrajaya.

Closure C: Full lane closures of the ramp going down to Putrajaya Sentral.

Closure D: Left lane closure heading to Putrajaya Sentral for a stretch of 100 metres. Motorists will be diverted to the right lane to get to Persimpangan Putrajaya Sentral.

There will be flagmen to facilitate traffic flow as indicated in the map and at any one time there will be one (1) lane made available for motorists. All other lanes along Lebuhraya Pintasan Dengkil will not be affected.

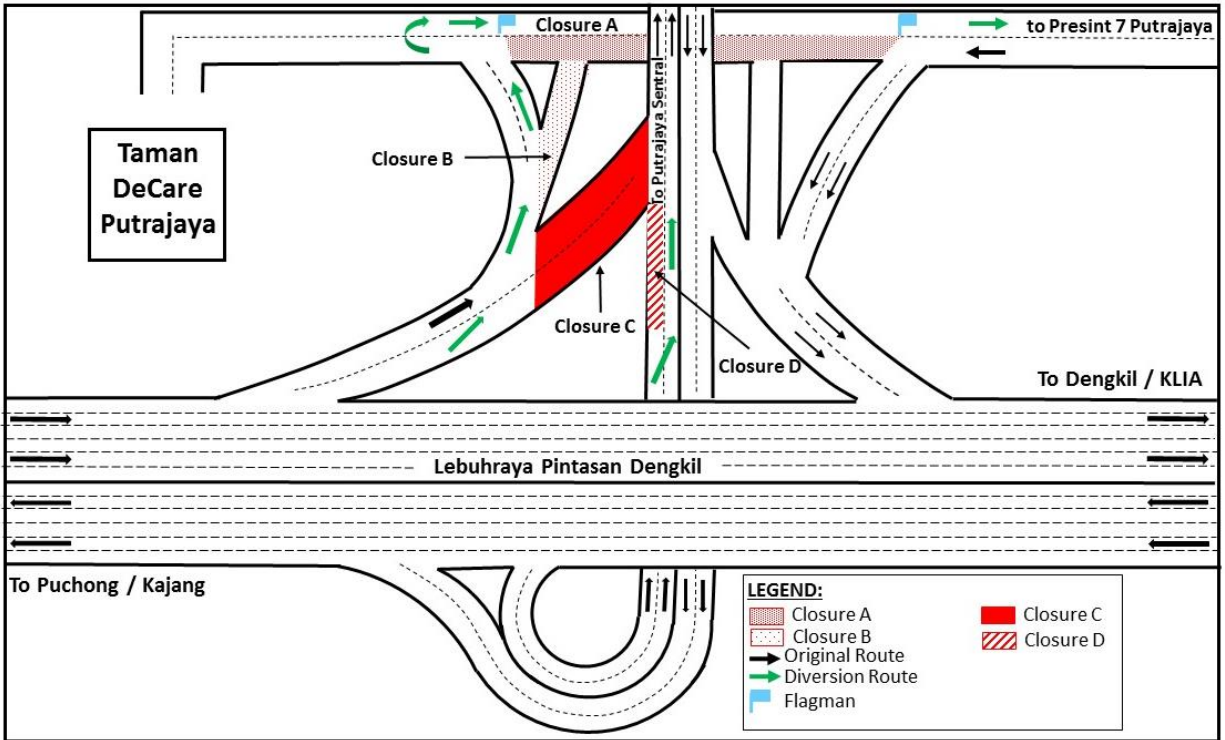

For media enquiries, please contact:

Mohd Hisham Abu Bakar
 Leanne Ann Susau

Tel: +6017 447 2767
 Tel: +603 7493 3832

hisham.bakar@mrcb.com
 leanne@mgjv-kvmrt.com.my

MMC GAMUDA KVMRT (PDP SSP) SDN BHD (1117100-V)
 Block A, Level 17, Menara Mustapha Kamal, PJ Trade Centre
 No 8, Jalan PJU 8/8A, Bandar Damansara Perdana, 47820 Petaling Jaya
 Selangor Darul Ehsan, Malaysia
 T: +603-7494 2222 F: +603-7727 0222 www.mymrt.com.my