

**TRAFFIC ANNOUNCEMENT**  
**UPDATES ON TRAFFIC MANAGEMENT PLAN FOR MRT CONSTRUCTION**  
**AT CHERAS-KAJANG HIGHWAY (KAJANG AND KUALA LUMPUR-BOUND)**  
**11 MAY 2017**

**1. CONTINUATION OF LANE CLOSURE AT KM14.0 UNTIL KM16.0 ON CHERAS- KAJANG HIGHWAY (KUALA LUMPUR AND KAJANG BOUND) (INTERMITTENT CLOSURE)**

<b>Date</b>	12 May 2017 – 31 May 2017
<b>Time</b>	10:00PM – 5:00AM
<b>Duration</b>	20 Nights
<b>Reasons</b>	To facilitate the reinstatement of street lighting and permanent signages, installation of guard rail, road resurfacing (milling & pavement) and road marking works.

There will be a continuation of two - lane closures at KM14.0 until KM16.0 for the stretch of **2KM** on the Cheras-Kajang Highway from **12 May 2017 – 31 May 2017**.

**Closure 1 - Kajang Bound (12 May 2017 – 21 May 2017)** from between **10:00PM - 5:00AM**  
**Closure 2 – Kuala Lumpur Bound (22 May 2017 – 31 May 2017)** from between **10:00PM - 5:00AM**

Only two lanes will be closed at one time and during this closure, **FOUR lanes** will be reduced to **TWO lanes** for the stretch of **2KM** for both bounds (intermittent).

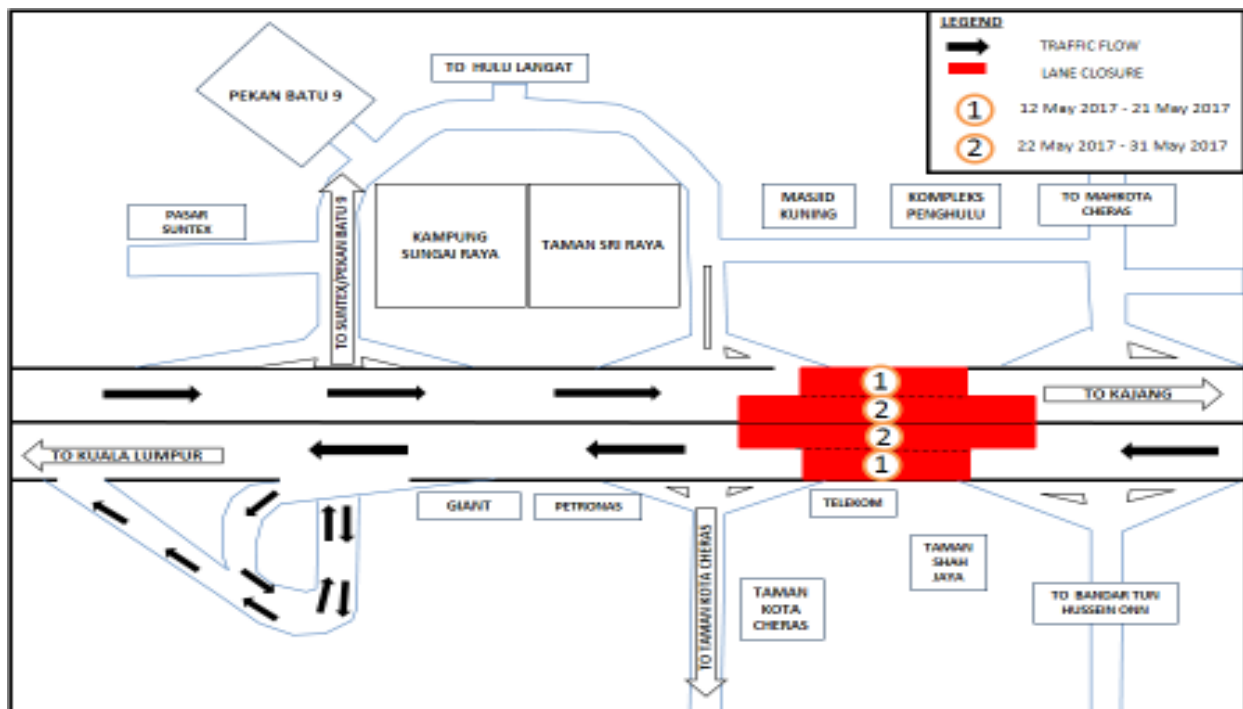

**MAP 1: CONTINUATION OF LANE CLOSURE AT KM14.0 UNTIL KM16.0 ON CHERAS KAJANG HIGHWAY (KUALA LUMPUR AND KAJANG BOUND) (INTERMITTENT CLOSURE)**

## 2. CONTINUATION OF SLIP ROAD CLOSURE AT EXIT 702 AND EXIT 703, CHERAS-KAJANG HIGHWAY (INTERMITTENT CLOSURE)

<b>Date</b>	12 May 2017 – 31 May 2017
<b>Time</b>	10:00PM until 5:00AM
<b>Duration</b>	20 Nights
<b>Reasons</b>	To facilitate the maintenance works for Taman Suntex MRT Station and Sri Raya MRT Station, reinstatement of street lighting, reinstatement of permanent signages, road resurfacing (milling & pavement) and road marks works.

There will be a continuation of slip road closures at Exit 702 and Exit 703 (Kajang-bound and Kuala Lumpur-bound), Cheras- Kajang Highway from **12 May 2017 – 31 May 2017** starting **10:00PM – 5:00AM**. These closures **will not be conducted simultaneously**.

### Closure A (Exit 702, Hulu Langat Interchange, Kajang Bound)

- Motorists from Kuala Lumpur heading towards Hulu Langat/Pekan Batu 9 will have to use Exit 703 (Telekom Interchange) entering Jalan Hulu Langat and proceed to Pekan Batu 9/Hulu Langat/Taman Suntex as indicated in **PURPLE** in the appended map.

**OR**

- Make a U-Turn at Exit 703 (entering Cheras-Kajang Highway – Lumpur Bound) and take Exit 702 Interchange entering Taman Suntex/Pekan Batu 9 as indicated in **BLACK** in the appended map.

### Closure B (Exit 703, Telekom Interchange, Kajang Bound)

- Motorists from Kuala Lumpur heading towards Pekan Batu 9/ Hulu Langat will have to turn left at Exit 702 as indicated in **BLUE** in themap.

Motorists from Kuala Lumpur heading towards Taman Kota Cheras will be directed to make a U-turn at Bandar Tun Hussein Onn Interchange (Exit 704) and use slip road at Exit 703 (Taman Kota Cheras-bound) as indicated in **GREEN** in the appended map.

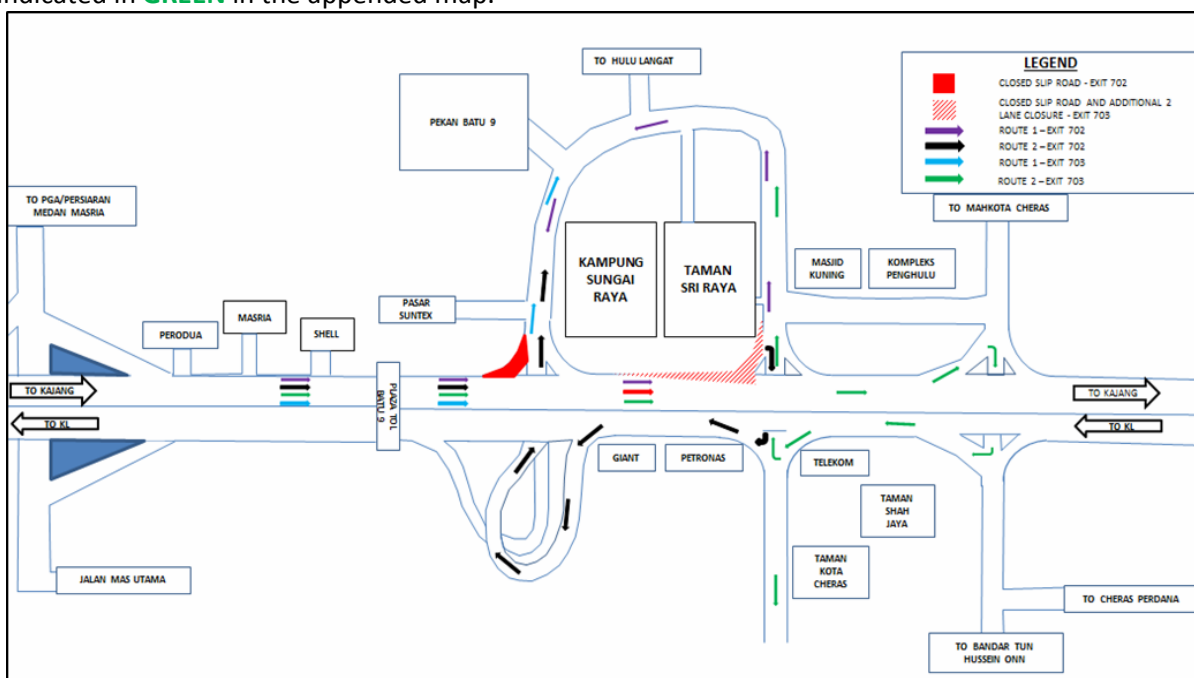

**MAP 2: SLIP ROAD CLOSURE AT THE EXIT 702 AND EXIT 703, CHERAS-KAJANG HIGHWAY (KAJANG AND KUALA LUMPUR-BOUND)**

**3. CONTINUATION OF TWO LANE CLOSURE AT KM 13.3 UNTIL KM 14.7 CHERAS-KAJANG HIGHWAY (KAJANG-BOUND) (INTERMITTENT CLOSURE)**

<b>Date</b>	12 May 2017 – 31 May 2017
<b>Time</b>	10:00PM until 5:00AM
<b>Duration</b>	20 Nights
<b>Reasons</b>	To facilitate the construction link bridge, reinstatement of street lighting, permanent signages, road resurfacing (milling & pavement) and road marking works.

There will be a continuation of two-lane closure at Cheras – Kajang Highway (Kajang-bound) from **12 May 2017 until 31 May 2017** between **10:00PM - 5:00 AM** stretching from KM13.3 until KM14.7 for **1.4 km** (nearby Kampung Sungai Raya and Taman Sri Raya).

During this closure, **TWO lanes** will remain open for motorist heading to Kajang from Kuala Lumpur.

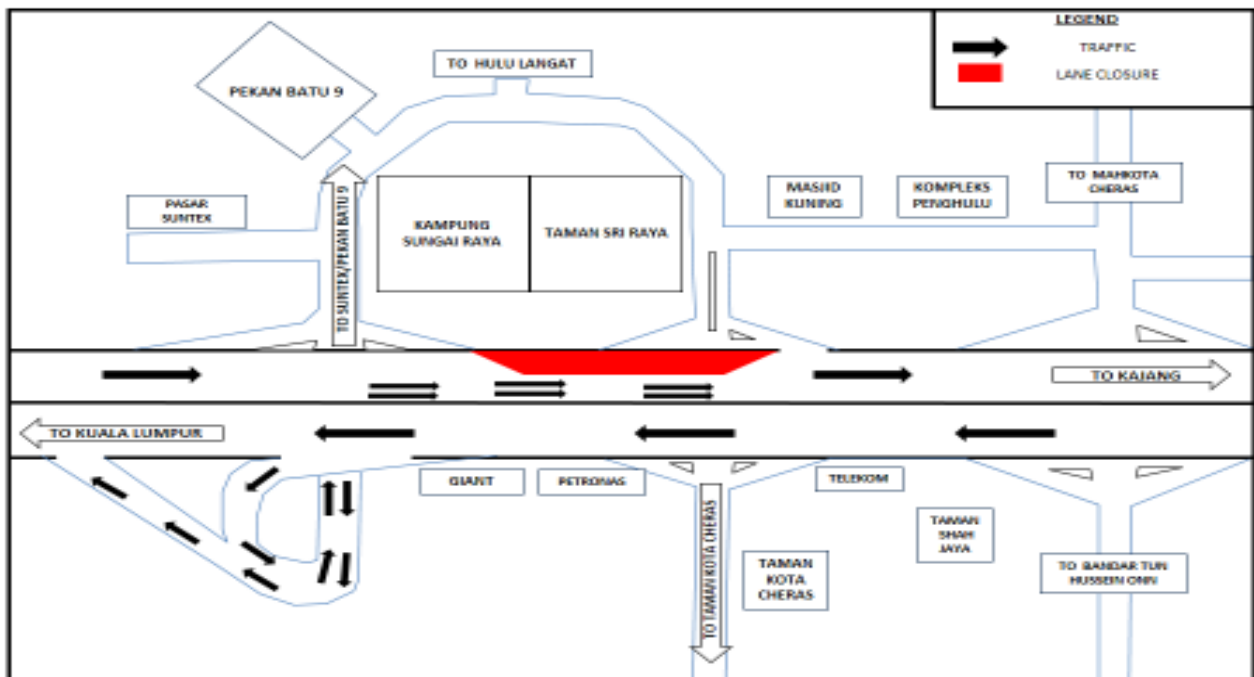

**MAP 3: TWO-LANE CLOSURE AT KM 13.3 UNTIL KM 14.7 CHERAS KAJANG HIGHWAY (KAJANG BOUND)**

**4. CONTINUATION OF ONE LANE CLOSURE AT KM10.6 UNTIL KM11.6 ON CHERAS-KAJANG HIGHWAY (KAJANG-BOUND) (INTERMITTENT CLOSURE)**

<b>Date</b>	12 May 2017 – 31 May 2017
<b>Time</b>	10:00PM until 5:00AM
<b>Duration</b>	20 Nights
<b>Reasons</b>	To facilitate the reinstatement of street lighting, reinstatement of permanent signages, road resurfacing (milling & pavement) and road marking works.

There will be continuation of a two - lane closure at the Cheras – Kajang Highway (Kajang-Bound) from KM10.6 until KM11.6 for the stretch of **1KM** (from Cheras Hartamas entering Cheras – Kajang Highway (Kajang bound) until slip road entering FRU at Batu 7, Cheras).

During this closure, **TWO lanes** will remain open for motorists heading towards Kajang from Kuala Lumpur.

- Closure 1 - Kajang Bound (12 May 2017 – 21 May 2017) from between 10:00PM - 5:00AM)**
- Closure 2 – Kajang Bound (22 May 2017 – 31 May 2017) from between 10:00PM - 5:00AM)**

Only two lanes will be closed at one time and during this closure, **FOUR lanes** will be reduced to **TWO lanes** for the stretch of **1km** for Kajang bounds (intermittent).

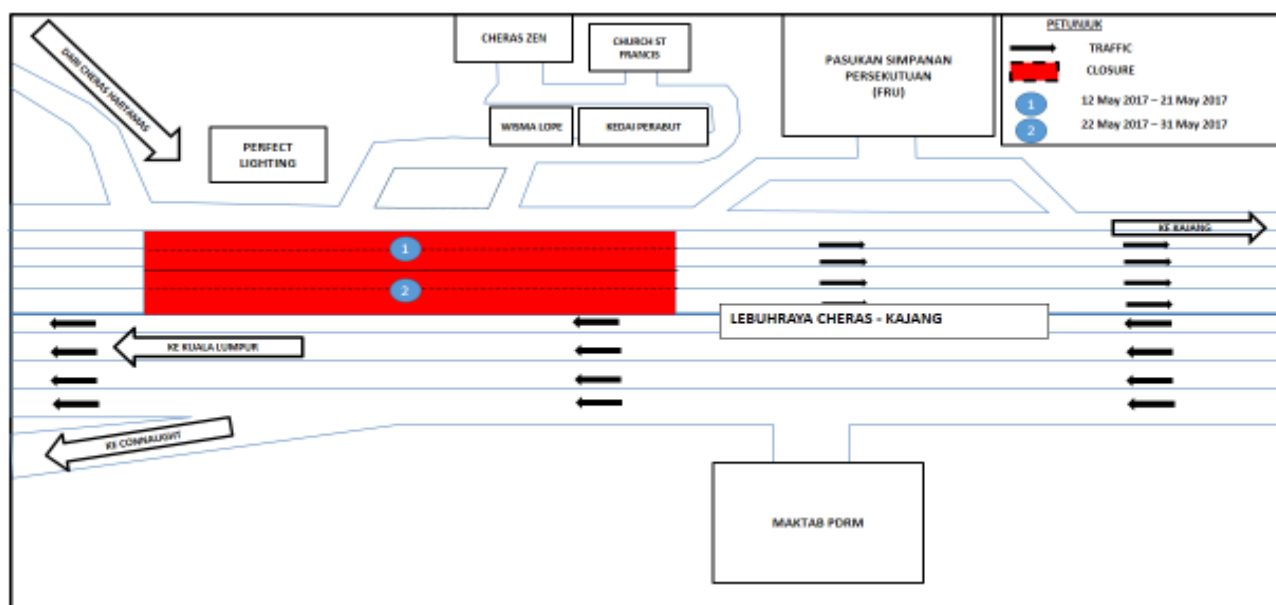

**MAP 4: TWO LANE CLOSURE AT KM10.6 UNTIL KM11.6 ON CHERAS-KAJANG HIGHWAY (KAJANG BOUND)**

**5. CONTINUATION OF MOTORCYCLE LANE CLOSURE AT BATU 9 & BATU 11 TOLL BOOTH OF CHERAS – KAJANG HIGHWAY (KUALA LUMPUR & KAJANG-BOUND) (INTERMITTENT CLOSURE)**

<b>Date</b>	12 May 2017 – 31 May 2017
<b>Time</b>	9:00AM – 4:00PM and 10.00PM until 5.00AM
<b>Duration</b>	20 Days
<b>Reasons</b>	To facilitate the maintenance works at BTHO MRT Station, reinstatement of street lighting, reinstatement of permanent signages, road resurfacing (milling & pavement) and road marking works

There will be a continuation of closure motorcycle lane closure at Batu 9 & Batu 11 Tollbooth on the Cheras – Kajang Highway (Kuala Lumpur & Kajang-bound) from **12 May 2017 – 31 May 2017** starting from **9:00AM – 4:00PM and 10.00PM - 5.00AM**. The closures will be as follow:

**Closure 1:** Closure of motorcycle lane at the Batu 9 Tollbooth of Cheras – Kajang Highway (Kajang- bound). During this closure, motorcyclists are advised to use the left-most lane near the toll booth as alternate route as indicated **BLUE** in the appended map.

**Closure 2:** Closure of motorcycle lane at the Batu 11 Tollbooth of Cheras – Kajang Highway (Kuala Lumpur-bound). During this closure, motorcyclist are advised to use the left-most lane near the toll booth as an alternate route as indicated **BLUE** in the appended map.

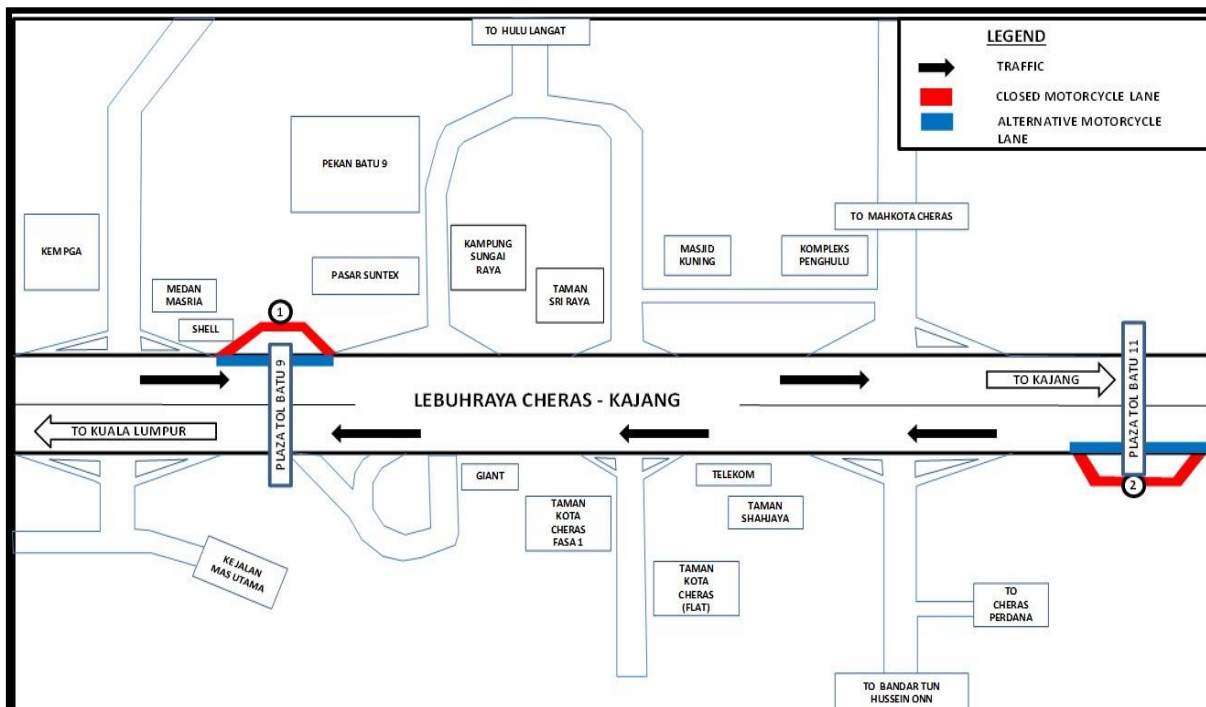

**MAP 5: MOTORCYCLE LANE CLOSURE AT BATU 9 & BATU 11 TOLLBOOTH OF CHERAS – KAJANG HIGHWAY (KUALA LUMPUR-BOUND)**

**6. CONTINUATION OF PARTIAL LANE CLOSURE AT EXIT 701 – PGA INTERCHANGE CHERAS- KAJANG HIGHWAY (KAJANG-BOUND) (INTERMITTENT CLOSURE)**

<b>Date</b>	12 May 2017 – 31 May 2017
<b>Time</b>	10:00AM until 4:00PM and 10:00PM until 5:00AM
<b>Duration</b>	20 Nights
<b>Reasons</b>	To facilitate reinstatement of street lighting, permanent signages, landscape work, road resurfacing (milling & pavement) and road marking works

There will be a partial lane closure at Exit 701 at the PGA Interchange (Kajang-bound and Kuala Lumpur-Bound) starting from **12 May 2017 until 31 May 2017** from **10:00AM – 4:00PM** and from **10:00 PM – 5:00AM**. The closure will be implemented in **TWO stages** as numbered inmap.

**Stage 1, numbered as 1 (12 May 2017 – 21 May 2017)**

- One lane closure on the left-most lane on the slip road entering PGA – Kajang Bound and Median 1 lane closure headings towards PGA.

**Stage 2, numbered as 2 (22 May 2017 – 31 May 2017)**

- Slip road closure (Kajang Bound) from PGA and Median 1 lane closure heading towards Kuala Lumpur Bound.

During this closure stages, motorists are advised to use the remaining opened lane on each bound. For the slip road closure during Stage 2, motorists (heading to Kajang) are advised to turn left after the traffic light (Kajang Bound). No other road diversion will be implemented during this closure.

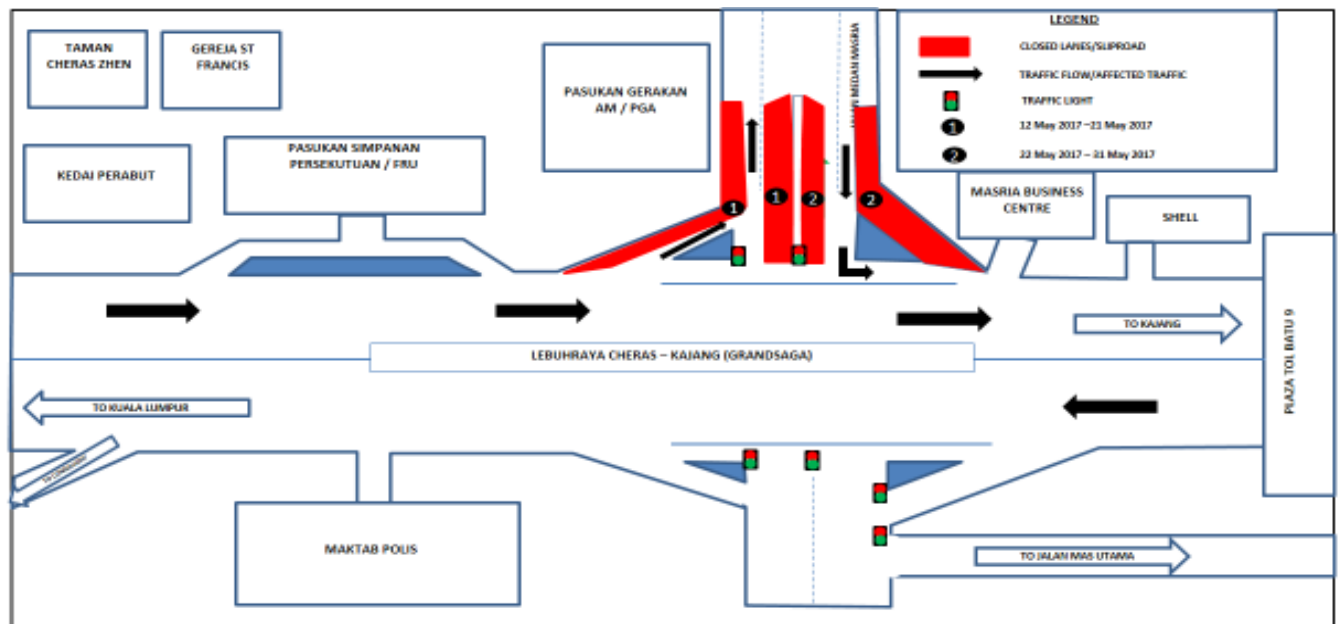

**MAP 6: PARTIAL LANE CLOSURE AT EXIT 701 – PGA INTERCHANGE CHERAS KAJANG HIGHWAY (KAJANG BOUND)**

**7. CONTINUATION OF PARTIAL LANE CLOSURE ON SLIP ROAD AT EXIT 703 – TELEKOM INTERCHANGE ON CHERAS- KAJANG HIGHWAY (KUALA LUMPUR-BOUND) (INTERMITTENT CLOSURE)**

<b>Date</b>	12 May 2017 –31 May 2017
<b>Time</b>	10:00AM until 4:00PM and 10:00PM until 5:00AM
<b>Duration</b>	20 Days/Nights
<b>Reason</b>	To facilitate maintenance works for Taman Sri Raya Link Bridge, permanent signages, reinstatement of street lighting, road resurfacing (milling & pavement) and road marking works

There will be a partial lane closure on the slip road Exit 703 from Taman Kota Cheras entering the Cheras – Kajang Highway (Kuala Lumpur-bound, nearby Station Petronas Batu 9) from **12 May 2017 until 31 May 2017** between **10:00AM - 4:00PM** and between **10:00PM – 5:00AM**. No road diversion will be made during this closure.

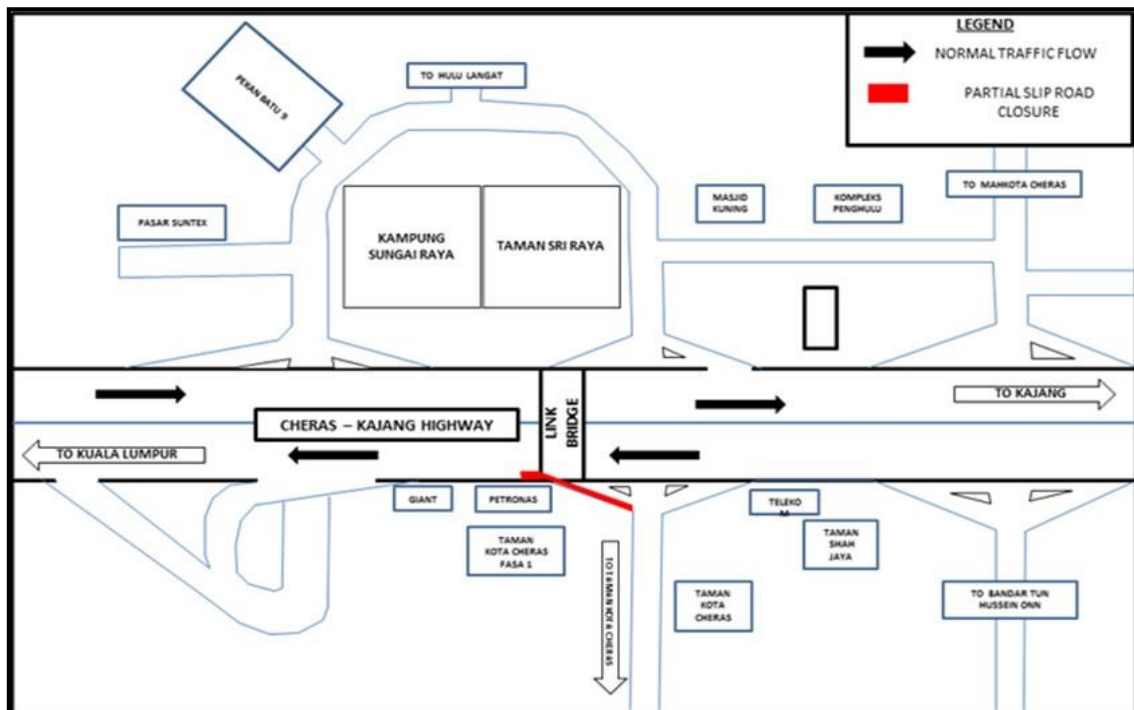

**MAP 7: PARTIAL LANE CLOSURE ON SLIP ROAD EXIT 703 – TELEKOM INTERCHANGE ON CHERAS-KAJANG HIGHWAY (KUALA LUMPUR BOUND)**

**8. FULL SLIP ROAD CLOSURE AT EXIT 704 – BANDAR TUN HUSSEIN ONN INTERCHANGE AT CHERAS-KAJANG HIGHWAY (KUALA LUMPUR BOUND) (INTERMITTENT CLOSURE)**

<b>Date</b>	12 May 2017 – 31 May 2017
<b>Time</b>	10:00PM until 5:00AM
<b>Duration</b>	20 Nights
<b>Reasons</b>	To facilitate reinstatement of street lighting, permanent signages,, road resurfacing (milling & pavement) and road marking works

There will be full slip road closure at Exit 704 at Bandar Tun Hussein Onn Interchange (Kuala Lumpur Bound) starting from **12 May 2017 until 31 May 2017** from **10:00 PM – 5:00AM**. The closure will be implemented in **TWO stages** as numbered in the map.

**Stage 1, numbered as 1 (12 May 2017 – 21 May 2017)**

- Full slip road closure from Bandar Tun Hussein Onn entering Cheras Kajang Highway (Kuala Lumpur bound).

**Stage 2, numbered as 2 (22 May 2017 – 31 May 2017)**

- Full slip road closure from Kajang (Toll Batu 11, Cheras Kajang Highway - Kuala Lumpur bound) entering Bandar Tun Hussein Onn.

During this closure stages, motorists are advised to turn left after the traffic light nearby the slip road as indicated by BLUE arrow on the appended map. No road diversion will be implemented.

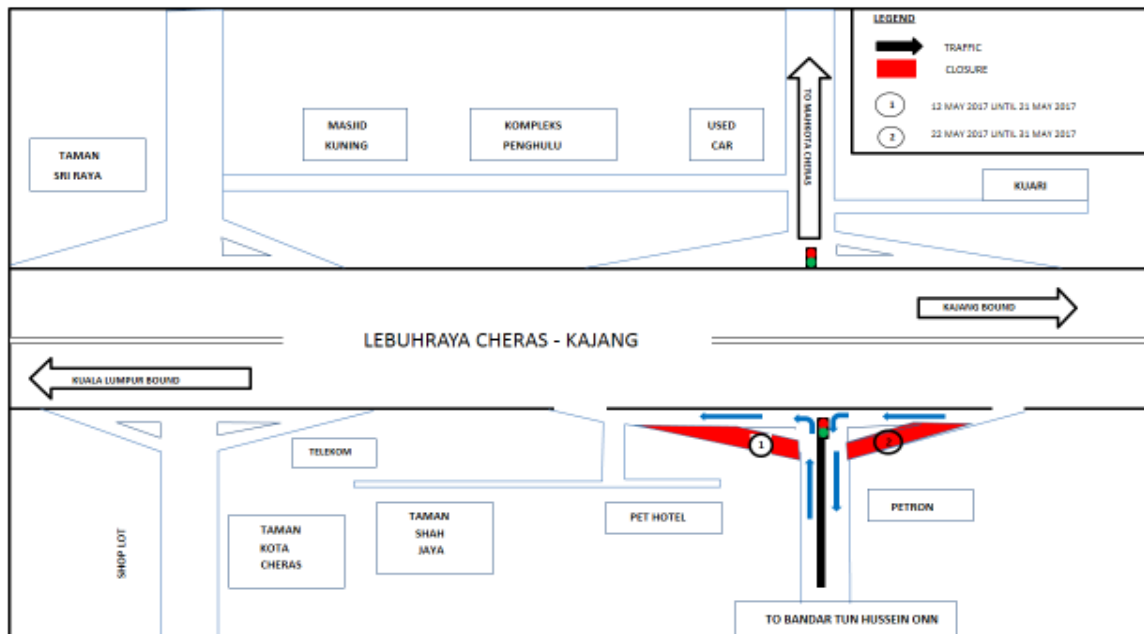

**MAP 8: FULL SLIP ROAD CLOSURE AT EXIT 704 BANDAR TUN HUSSEIN ONN INTERCHANGE**

**For media enquiries, please contact:**

Hillalluddin Mohd Ali	Tel: +6019 201 0002	hillalluddin@azrb.com
Leanne Ann Susau	Tel: +603 7493 3963	Leanne@mgjv-kvmrt.com.my

**MMC GAMUDA KVMRT (PDP) SDN BHD (927050-H)**  
 Block A, Level 7, Menara Mustapha Kamal, PJ Trade Centre, No 8, Jalan PJU 8/8A,  
 Bandar Damansara Perdana, 47820 Petaling Jaya, Selangor, Malaysia  
 T: 603 7494 2200 F: 603 7722 2643 [www.kvmrt.com.my](http://www.kvmrt.com.my)